

NEMA Standard Pad Sizes

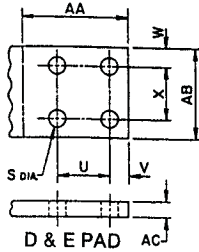

| PAD SIZE | DIMENSIONS | | | | | | | | | | | | |
|----------|------------|----|------|----|------|----|------|----|------|----|------|-----|------|
| | S | | U | | V | | W | | X | | AA | | AB |
| | IN | MM | IN | MM | IN | MM | IN | MM | IN | MM | IN | MM | IN |
| D | .56 | 14 | 1.75 | 44 | .62 | 16 | .62 | 16 | 1.75 | 44 | 3.50 | 89 | 3.00 |
| E | .56 | 14 | 1.75 | 44 | 1.12 | 29 | 1.12 | 29 | 1.75 | 44 | 4.50 | 114 | 4.00 |

Pad Width (AB) and Thickness (AC) for Dead Ends, Terminals and Tee Taps

| CATALOG SERIES | 5300HT & 5700HT | | | | 5100HT, 5600HT & 5800HT | | | | 8100HT & 8200HT | | | |
|----------------|-----------------|-----|-----|----|-------------------------|-----|-----|----|-----------------|-----|-----|----|
| | AB | | AC | | AB | | AC | | AB | | AC | |
| | IN | MM | IN | MM | IN | MM | IN | MM | IN | MM | IN | MM |
| 20 | 3.00 | 76 | .62 | 16 | 3.00 | 76 | .50 | 13 | 3.00 | 76 | .50 | 13 |
| 24 | 3.00 | 76 | .62 | 16 | 3.00 | 76 | .50 | 13 | 3.00 | 76 | .50 | 13 |
| 27 | 3.00 | 76 | .62 | 16 | 3.00 | 76 | .59 | 16 | 3.00 | 76 | .62 | 16 |
| 30 | 3.00 | 76 | .62 | 16 | 3.00 | 76 | .59 | 16 | 3.00 | 76 | .62 | 16 |
| 34 | 3.00 | 76 | .62 | 16 | 3.00 | 76 | .59 | 16 | 3.00 | 76 | .62 | 16 |
| 36 | 3.00 | 76 | .62 | 16 | 3.00 | 76 | .59 | 16 | 3.00 | 76 | .62 | 16 |
| 38 | 3.00 | 76 | .62 | 16 | 3.00 | 76 | .62 | 16 | 3.00 | 76 | .62 | 16 |
| 40 | 4.00 | 76 | .62 | 16 | 4.00 | 76 | .62 | 16 | 4.00 | 102 | .75 | 19 |
| 42 | 4.00 | 102 | .75 | 19 | 4.00 | 102 | .66 | 19 | 4.00 | 102 | .75 | 19 |
| 44 | 4.00 | 102 | .75 | 19 | 4.00 | 102 | .72 | 19 | 4.00 | 102 | .75 | 19 |
| 48 | 4.00 | 102 | .75 | 19 | 4.00 | 102 | .81 | 19 | 4.00 | 102 | .75 | 19 |

REFERENCE MATERIAL

Steel Eye Dimensions

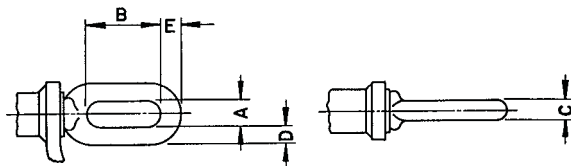

| EYE CATALOG NUMBER | DIMENSIONS | | | | | | | | | |
|--------------------|------------|----|------|----|------|----|------|----|------|----|
| | A | | B | | C | | D | | E | |
| | IN | MM | IN | MM | IN | MM | IN | MM | IN | MM |
| 91xx.xxx | 0.88 | 22 | 2.50 | 64 | .62 | 16 | .62 | 16 | .69 | 18 |
| 92xx.xxx | 0.88 | 22 | 2.50 | 64 | .69 | 18 | .62 | 16 | .81 | 21 |
| 93xx.xxx | 1.25 | 32 | 2.69 | 68 | .75 | 19 | .69 | 18 | .88 | 22 |
| 94xx.xxx | 1.25 | 32 | 2.69 | 68 | .75 | 19 | .69 | 18 | .94 | 24 |
| E95xx.xxx | 1.25 | 32 | 2.62 | 67 | .78 | 20 | .78 | 20 | .91 | 23 |
| E96xx.xxx | 1.25 | 32 | 2.62 | 67 | .88 | 22 | .88 | 22 | 1.00 | 25 |
| E97xx.xxx | 1.25 | 32 | 2.62 | 67 | 1.00 | 25 | 1.00 | 25 | 1.12 | 28 |
| E98xx.xxx | 1.31 | 33 | 2.62 | 67 | 1.00 | 25 | .97 | 25 | 1.25 | 32 |

HiTemp AFL Filler Compound Requirements For ACSS and ACSS/TW Conductors

A filler port and plug are provided on the dead ends and joints for ACSS and ACSS/TW conductors. The chart below shows the recommended approximate amount of HiTemp AFL Filler Compound (AFCHT) required for each accessory.

AFCHT is available in various packages and sizes. It can be ordered in one-pound tubes with nozzle for a standard caulking gun or it can be ordered in bulk for use in pressure guns. For recommendations about compounds, contact AFL at 1.800.866.7385.

| DIE SIZE | CATALOG SERIES | | | | | | | | | |
|----------|----------------|-----|----------------------------|-----|------------------|-----|--------|-----|------------------|-----|
| | 5000HT | | 5100HT 5600HT 5800HT | | 5300HT 5500HT | | 8000HT | | 8100HT 8200HT | |
| | LBS | G | LBS | G | LBS | G | LBS | G | LBS | G |
| 20 | 0.1 | 45 | 0.1 | 45 | 0.1 | 45 | 0.3 | 136 | 0.2 | 91 |
| 24 | 0.1 | 45 | 0.1 | 45 | 0.1 | 45 | 0.4 | 181 | 0.3 | 136 |
| 27 | 0.2 | 91 | 0.2 | 91 | 0.2 | 91 | 0.5 | 227 | 0.4 | 181 |
| 30 | 0.4 | 91 | 0.2 | 91 | 0.2 | 91 | 0.6 | 272 | 0.5 | 227 |
| 34 | 0.3 | 136 | 0.2 | 91 | 0.3 | 136 | 0.8 | 363 | 0.7 | 318 |
| 36 | 0.4 | 181 | 0.3 | 136 | 0.4 | 181 | 1.0 | 454 | 0.9 | 408 |
| 38 | 0.4 | 181 | 0.3 | 136 | 0.4 | 181 | 1.2 | 544 | 1.0 | 454 |
| 40 | 0.5 | 227 | 0.4 | 181 | 0.5 | 227 | 1.4 | 635 | 1.2 | 544 |
| 42 | 1.6 | 272 | 0.4 | 181 | 0.6 | 272 | 1.5 | 680 | 1.3 | 590 |
| 44 | 1.7 | 318 | 0.5 | 227 | 0.7 | 318 | 1.6 | 726 | 1.4 | 635 |
| 48 | 1.8 | 363 | 1.6 | 272 | 0.8 | 363 | 1.8 | 816 | 1.6 | 726 |

Notes:

- The amount of compound shown in the table above is for the purpose of estimating the amount of compound necessary for a construction project. The tabulated weights of filler compound shown in the above tables for the Catalog 5100HT, 5600HT and 5800HT terminals does not include sufficient quantity to fill the cavity area at the transition of the barrel. If the terminal is installed with the barrel in the upright position, it is imperative that an additional quantity of compound be used to fill the cavity area.
- 5500HT amounts do not include compound for the tap. Add amount required for the 5100HT Series Terminal Connector of the same die size.

Bolt Sizes and Recommended Torque

| 15° TERMINAL SIZE | BOLT SIZE | RECOMMENDED TORQUE | |
|------------------------------------|---------------------|--------------------|-----|
| | | LBF-FT | N-M |
| 5120HT, 5124HT, 5127HT | 1/2"-13UNC x 2.00" | 25 | 34 |
| 5130HT1 | 1/2"-13UNC x 2.00" | 25 | 34 |
| 5134HT1, 5136HT1, 5138HT1 | 1/2" -13UNC x 2.25" | 25 | 34 |
| 5140HT1, 5142HT1, 5144HT1, 5148HT1 | 1/2" -13UNC x 2.50" | 25 | 34 |

Note:

Corona head bolts furnished with these sizes.

Conductor Information for ACSS Conductors

| CODE NAME | SIZE | STRANDING | DIAMETER (IN) | | | | WEIGHT PER 1000 FT | RATED STRENGTH | RESISTANCE OHMS/1000 FT | | AMPACITY @ 200° C | SAG10® CHART NUMBER |
|-----------------|--------|-----------|------------------|-------|------------|----------------|--------------------|----------------|-------------------------|-----------|-------------------|---------------------|
| | | | INDIVIDUAL WIRES | | STEEL CORE | COMPLETE CABLE | | | DC @ 20°C | AC @ 75°C | | |
| | | | KCMIL | AL/ST | | | | | | | AL | |
| Partridge/ACSS | 266.8 | 26/7 | 0.101 | 0.079 | 0.236 | 0.642 | 366.8 | 8,880 | 0.062 | 0.076 | 812 | 3-945 |
| Junco/ACSS | 266.8 | 30/7 | 0.094 | 0.094 | 0.283 | 0.660 | 417.4 | 11,700 | 0.062 | 0.076 | 822 | 3-947 |
| Ostrich/ACSS | 300.0 | 26/7 | 0.107 | 0.084 | 0.251 | 0.680 | 412.4 | 10,000 | 0.055 | 0.068 | 877 | 3-945 |
| Linnet/ACSS | 336.4 | 26/7 | 0.114 | 0.089 | 0.265 | 0.720 | 462.5 | 11,200 | 0.049 | 0.060 | 945 | 3-945 |
| Oriole/ACSS | 336.4 | 30/7 | 0.106 | 0.106 | 0.318 | 0.741 | 526.3 | 14,800 | 0.049 | 0.060 | 957 | 3-947 |
| Brant/ACSS | 397.5 | 24/7 | 0.129 | 0.086 | 0.257 | 0.772 | 511.4 | 11,000 | 0.042 | 0.051 | 1,047 | 3-944 |
| Ibis/ACSS | 397.5 | 26/7 | 0.124 | 0.096 | 0.289 | 0.783 | 546.5 | 13,000 | 0.042 | 0.051 | 1,054 | 3-945 |
| Lark/ACSS | 397.5 | 30/7 | 0.115 | 0.115 | 0.345 | 0.806 | 621.9 | 17,500 | 0.041 | 0.051 | 1,068 | 3-947 |
| Flicker/ACSS | 477.0 | 24/7 | 0.141 | 0.094 | 0.282 | 0.846 | 613.6 | 13,000 | 0.035 | 0.043 | 1,180 | 3-944 |
| Hawk/ACSS | 477.0 | 26/7 | 0.135 | 0.105 | 0.316 | 0.858 | 655.8 | 15,600 | 0.035 | 0.043 | 1,188 | 3-945 |
| Hen/ACSS | 477.0 | 30/7 | 0.126 | 0.126 | 0.378 | 0.883 | 746.3 | 21,000 | 0.034 | 0.042 | 1,204 | 3-947 |
| Parakeet/ACSS | 556.5 | 24/7 | 0.152 | 0.102 | 0.305 | 0.914 | 715.9 | 15,200 | 0.030 | 0.037 | 1,306 | 3-944 |
| Dove/ACSS | 556.5 | 26/7 | 0.146 | 0.114 | 0.341 | 0.927 | 765.1 | 18,200 | 0.030 | 0.037 | 1,315 | 3-945 |
| Eagle/ACSS | 556.5 | 30/7 | 0.136 | 0.136 | 0.409 | 0.953 | 870.6 | 24,500 | 0.030 | 0.036 | 1,331 | 3-947 |
| Peacock/ACSS | 605.0 | 24/7 | 0.159 | 0.106 | 0.318 | 0.953 | 778.3 | 16,500 | 0.027 | 0.034 | 1,379 | 3-944 |
| Squab/ACSS | 605.0 | 26/7 | 0.153 | 0.119 | 0.356 | 0.966 | 831.8 | 19,700 | 0.027 | 0.034 | 1,389 | 3-945 |
| Wood Duck/ACSS | 605.0 | 30/7 | 0.142 | 0.142 | 0.426 | 0.994 | 946.5 | 26,100 | 0.027 | 0.033 | 1,407 | 3-947 |
| Teal/ACSS | 605.0 | 30/19 | 0.142 | 0.085 | 0.426 | 0.994 | 938.6 | 26,600 | 0.027 | 0.034 | 1,406 | 3-955 |
| Rook/ACSS | 636.0 | 24/7 | 0.163 | 0.109 | 0.326 | 0.977 | 818.2 | 17,300 | 0.026 | 0.032 | 1,425 | 3-944 |
| Grosbeak/ACSS | 636.0 | 26/7 | 0.156 | 0.122 | 0.365 | 0.991 | 874.4 | 20,700 | 0.026 | 0.032 | 1,435 | 3-945 |
| Scoter/ACSS | 636.0 | 30/7 | 0.146 | 0.146 | 0.437 | 1.019 | 995.0 | 27,400 | 0.026 | 0.032 | 1,454 | 3-947 |
| Egret/ACSS | 636.0 | 30/19 | 0.146 | 0.087 | 0.437 | 1.019 | 986.8 | 28,000 | 0.026 | 0.032 | 1,453 | 3-955 |
| Flamingo/ACSS | 666.6 | 24/7 | 0.167 | 0.111 | 0.333 | 1.000 | 857.6 | 18,200 | 0.025 | 0.031 | 1,470 | 3-944 |
| Gannet/ACSS | 666.6 | 26/7 | 0.160 | 0.125 | 0.374 | 1.014 | 916.4 | 21,700 | 0.025 | 0.031 | 1,480 | 3-945 |
| Stilt/ACSS | 715.5 | 24/7 | 0.173 | 0.115 | 0.345 | 1.036 | 920.5 | 19,500 | 0.023 | 0.029 | 1,540 | 3-944 |
| Starling/ACSS | 715.5 | 26/7 | 0.166 | 0.129 | 0.387 | 1.051 | 983.7 | 23,300 | 0.023 | 0.029 | 1,550 | 3-945 |
| Redwing/ACSS | 715.5 | 30/19 | 0.154 | 0.093 | 0.463 | 1.081 | 1110.1 | 30,800 | 0.023 | 0.028 | 1,570 | 3-955 |
| Cuckoo/ACSS | 795.0 | 24/7 | 0.182 | 0.121 | 0.364 | 1.092 | 1022.7 | 21,700 | 0.021 | 0.026 | 1,650 | 3-944 |
| Drake/ACSS | 795.0 | 26/7 | 0.175 | 0.136 | 0.408 | 1.107 | 1093.0 | 25,900 | 0.021 | 0.026 | 1,662 | 3-945 |
| Macaw/ACSS | 795.0 | 42/7 | 0.138 | 0.076 | 0.229 | 1.055 | 857.5 | 11,800 | 0.021 | 0.026 | 1,621 | 3-949 |
| Tern/ACSS | 795.0 | 45/7 | 0.133 | 0.089 | 0.266 | 1.063 | 894.9 | 14,200 | 0.021 | 0.026 | 1,618 | 3-951 |
| Condor/ACSS | 795.0 | 54/7 | 0.121 | 0.121 | 0.364 | 1.092 | 1022.7 | 16,600 | 0.021 | 0.027 | 1,618 | 3-954 |
| Mallard/ACSS | 795.0 | 30/19 | 0.163 | 0.098 | 0.488 | 1.139 | 1233.4 | 34,300 | 0.021 | 0.026 | 1,683 | 3-955 |
| Ruddy/ACSS | 900.0 | 45/7 | 0.141 | 0.094 | 0.283 | 1.131 | 1013.1 | 15,800 | 0.019 | 0.023 | 1,755 | 3-951 |
| Canary/ACSS | 900.0 | 54/7 | 0.129 | 0.129 | 0.387 | 1.162 | 1157.8 | 24,600 | 0.018 | 0.024 | 1,756 | 3-954 |
| Redbird/ACSS | 954.0 | 24/7 | 0.199 | 0.133 | 0.399 | 1.196 | 1227.3 | 26,000 | 0.017 | 0.022 | 1,859 | 3-944 |
| Rail/ACSS | 954.0 | 45/7 | 0.146 | 0.097 | 0.291 | 1.165 | 1073.9 | 16,700 | 0.018 | 0.022 | 1,824 | 3-951 |
| Towhee/ACSS | 954.0 | 48/7 | 0.141 | 0.110 | 0.329 | 1.175 | 1122.3 | 19,700 | 0.018 | 0.022 | 1,842 | 3-953 |
| Cardinal/ACSS | 954.0 | 54/7 | 0.133 | 0.133 | 0.399 | 1.196 | 1227.3 | 26,000 | 0.017 | 0.022 | 1,825 | 3-954 |
| Canvasback/ACSS | 954.0 | 30/19 | 0.178 | 0.107 | 0.535 | 1.248 | 1480.1 | 41,100 | 0.017 | 0.021 | 1,897 | 3-955 |
| Snowbird/ACSS | 1033.5 | 42/7 | 0.157 | 0.087 | 0.261 | 1.203 | 1114.7 | 15,400 | 0.016 | 0.020 | 1,924 | 3-949 |
| Ortolan/ACSS | 1033.5 | 45/7 | 0.152 | 0.101 | 0.303 | 1.212 | 1163.4 | 18,100 | 0.016 | 0.020 | 1,921 | 3-951 |
| Curlew/ACSS | 1033.5 | 54/7 | 0.138 | 0.138 | 0.415 | 1.245 | 1329.6 | 28,200 | 0.016 | 0.021 | 1,924 | 3-954 |
| Bluejay/ACSS | 1113.0 | 45/7 | 0.157 | 0.105 | 0.315 | 1.258 | 1252.8 | 19,500 | 0.015 | 0.019 | 2,017 | 3-951 |
| Finch/ACSS | 1113.0 | 54/19 | 0.144 | 0.086 | 0.431 | 1.292 | 1428.9 | 30,400 | 0.015 | 0.019 | 2,015 | 3-957 |
| Bunting/ACSS | 1192.5 | 45/7 | 0.163 | 0.109 | 0.326 | 1.302 | 1342.4 | 20,900 | 0.014 | 0.018 | 2,110 | 3-951 |
| Bittern/ACSS | 1272.0 | 45/7 | 0.168 | 0.112 | 0.336 | 1.345 | 1431.9 | 22,300 | 0.013 | 0.017 | 2,200 | 3-951 |

REFERENCE MATERIAL

Conductor Information for ACSS Conductors (continued)

| CODE NAME | SIZE | STRANDING | DIAMETER (IN) | | | | WEIGHT PER 1000 FT | RATED STRENGTH | RESISTANCE OHMS/1000 FT | | AMPACITY @ 200° C | SAG10® CHART NUMBER |
|------------------|--------|-----------|------------------|-------|------------|----------------|--------------------|----------------|-------------------------|-----------|-------------------|---------------------|
| | | | INDIVIDUAL WIRES | | STEEL CORE | COMPLETE CABLE | | | DC @ 20°C | AC @ 75°C | | |
| | KCMIL | AL/ST | AL | ST | | | LBS | LBS | | | AMPS | |
| Pheasant/ACSS | 1272.0 | 54/19 | 0.154 | 0.092 | 0.460 | 1.381 | 1633.0 | 34,100 | 0.013 | 0.017 | 2,200 | 3-957 |
| Dipper/ACSS | 1351.0 | 45/7 | 0.173 | 0.116 | 0.347 | 1.386 | 1520.8 | 23,700 | 0.012 | 0.016 | 2,289 | 3-951 |
| Martin/ACSS | 1351.0 | 54/19 | 0.158 | 0.095 | 0.475 | 1.424 | 1734.5 | 36,200 | 0.012 | 0.016 | 2,288 | 3-957 |
| Bobolink/ACSS | 1431.0 | 45/7 | 0.178 | 0.119 | 0.357 | 1.427 | 1610.8 | 25,100 | 0.012 | 0.015 | 2,375 | 3-951 |
| Plover/ACSS | 1431.0 | 54/19 | 0.163 | 0.098 | 0.488 | 1.465 | 1837.2 | 38,400 | 0.012 | 0.015 | 2,375 | 3-957 |
| Nuthatch/ACSS | 1510.0 | 45/7 | 0.183 | 0.122 | 0.366 | 1.465 | 1699.8 | 26,500 | 0.011 | 0.014 | 2,459 | 3-951 |
| Parrot/ACSS | 1510.0 | 54/19 | 0.167 | 0.100 | 0.502 | 1.505 | 1938.6 | 40,500 | 0.011 | 0.014 | 2,460 | 3-957 |
| Ratite/ACSS | 1590.0 | 42/7 | 0.195 | 0.108 | 0.324 | 1.492 | 1715.0 | 23,400 | 0.011 | 0.014 | 2,543 | 3-949 |
| Lapwing/ACSS | 1590.0 | 45/7 | 0.188 | 0.125 | 0.376 | 1.504 | 1789.8 | 27,900 | 0.011 | 0.014 | 2,543 | 3-951 |
| Falcon/ACSS | 1590.0 | 54/19 | 0.172 | 0.103 | 0.515 | 1.544 | 2041.4 | 42,600 | 0.011 | 0.014 | 2,545 | 3-957 |
| Chukar/ACSS | 1780.0 | 84/19 | 0.146 | 0.087 | 0.437 | 1.601 | 2070.8 | 35,400 | 0.009 | 0.012 | 2,751 | 3-959 |
| Mockingbird/ACSS | 2034.5 | 72/7 | 0.168 | 0.112 | 0.336 | 1.681 | 2159.3 | 27,200 | 0.008 | 0.011 | 2,960 | 3-954 |
| Roadrunner/ACSS | 2057.0 | 76/19 | 0.165 | 0.077 | 0.384 | 1.700 | 2245.2 | 31,700 | 0.008 | 0.011 | 2,992 | 3-959 |
| Bluebird/ACSS | 2156.0 | 84/19 | 0.160 | 0.096 | 0.481 | 1.762 | 2508.2 | 42,100 | 0.008 | 0.010 | 3,106 | 3-959 |
| Kiwi/ACSS | 2167.0 | 72/7 | 0.174 | 0.116 | 0.347 | 1.735 | 2299.9 | 29,000 | 0.008 | 0.010 | 3,080 | 3-954 |
| Thrasher/ACSS | 2312.0 | 76/19 | 0.174 | 0.081 | 0.407 | 1.802 | 2523.5 | 35,600 | 0.007 | 0.010 | 3,218 | 3-959 |
| Joree/ACSS | 2515.0 | 76/19 | 0.182 | 0.085 | 0.425 | 1.880 | 2745.1 | 38,700 | 0.007 | 0.009 | 3,390 | 3-959 |

Notes:

1. Data based on a nominal cable manufactured in accordance with ASTM B 857.
2. Resistance and ampacity based on an aluminum conductivity of 63%, IACS at 20°C, and a steel conductivity of 8% IACS at 20°C.
3. Ampacity based on a 200°C conductor temperature, 25°C ambient temperature, 2 ft/sec. wind, in sun, with emissivity of 0.5 and a coefficient of solar absorption of 0.5, at sea level.
4. Rated strengths based on Class A galvanized steel core wire in accordance with ASTM B 498.

Conductor Information for ACSS/TW Conductors

| CODE NAME | SIZE | TYPE | STRANDING | DIAMETER (IN) | | WEIGHT PER 1000 FT | RATED STRENGTH | RESISTANCE OHMS/1000 FT | | AMPACITY @ 200° C | SAG10® CHART NUMBER |
|---------------------|--------|------|-----------|---------------|---------------|-----------------------|-------------------|----------------------------|--------------|----------------------|---------------------------|
| | KCMIL | | | AL/ST | STEEL CORE | | | COMPLETE CABLE | DC @ 20°C | | |
| | | | | | | | LBS | LBS | AMPS | | |
| Oriole/ACSS/TW | 336.4 | 23 | 18/7 | 0.318 | 0.693 | 524.9 | 14,800 | 0.2565 | 0.3151 | 940 | 3-955 |
| Flicker/ACSS/TW | 477.0 | 13 | 18/7 | 0.282 | 0.776 | 612.8 | 13,000 | 0.1838 | 0.2255 | 1151 | 3-944 |
| Hawk/ACSS/TW | 477.0 | 16 | 18/7 | 0.316 | 0.789 | 655.0 | 15,600 | 0.1825 | 0.2247 | 1159 | 3-945 |
| Hen/ACSS/TW | 477.0 | 23 | 18/7 | 0.378 | 0.825 | 744.5 | 21,000 | 0.1809 | 0.2225 | 1181 | 3-955 |
| Parakeet/ACSS/TW | 556.5 | 13 | 18/7 | 0.305 | 0.835 | 714.9 | 15,200 | 0.1569 | 0.1935 | 1271 | 3-944 |
| Dove/ACSS/TW | 556.5 | 16 | 20/7 | 0.341 | 0.852 | 764.5 | 18,200 | 0.1564 | 0.1928 | 1282 | 3-945 |
| Calumet/ACSS/TW | 565.3 | 16 | 18/7 | 0.344 | 0.858 | 775.8 | 18,400 | 0.1540 | 0.1898 | 1295 | 3-945 |
| Mohawk/ACSS/TW | 571.7 | 13 | 18/7 | 0.309 | 0.846 | 734.7 | 15,600 | 0.1527 | 0.1884 | 1294 | 3-644 |
| Rook/ACSS/TW | 636.0 | 13 | 19/7 | 0.326 | 0.890 | 816.0 | 17,300 | 0.1373 | 0.1696 | 1386 | 3-944 |
| Grosbeak/ACSS/TW | 636.0 | 16 | 20/7 | 0.365 | 0.908 | 873.5 | 20,700 | 0.1369 | 0.1689 | 1398 | 3-945 |
| Scoter/ACSS/TW | 636.0 | 23 | 18/7 | 0.437 | 0.953 | 992.4 | 27,400 | 0.1357 | 0.1672 | 1427 | 3-955 |
| Oswego/ACSS/TW | 664.8 | 16 | 20/7 | 0.373 | 0.927 | 913.4 | 21,700 | 0.1309 | 0.1617 | 1439 | 3-945 |
| Mystic/ACSS/TW | 666.6 | 13 | 20/7 | 0.333 | 0.913 | 856.3 | 18,200 | 0.1310 | 0.1619 | 1431 | 3-944 |
| Wabash/ACSS/TW | 762.8 | 16 | 20/7 | 0.399 | 0.990 | 1047.0 | 24,900 | 0.1141 | 0.1411 | 1573 | 3-945 |
| Maumee/ACSS/TW | 768.2 | 13 | 20/7 | 0.359 | 0.977 | 987.8 | 21,000 | 0.1137 | 0.1407 | 1569 | 3-944 |
| Tern/ACSS/TW | 795.0 | 7 | 17/7 | 0.236 | 0.960 | 891.0 | 15,200 | 0.1105 | 0.1373 | 1580 | 3-951 |
| Puffin/ACSS/TW | 795.0 | 10 | 18/7 | 0.332 | 0.980 | 974.0 | 18,900 | 0.1101 | 0.1365 | 1595 | 3-942 |
| Condor/ACSS/TW | 795.0 | 13 | 20/7 | 0.364 | 0.993 | 1020.0 | 21,700 | 0.1098 | 0.1361 | 1604 | 3-944 |
| Drake/ACSS/TW | 795.0 | 16 | 20/7 | 0.408 | 1.010 | 1091.0 | 25,900 | 0.1095 | 0.1355 | 1616 | 3-945 |
| Canary/ACSS/TW | 900.0 | 13 | 30/7 | 0.387 | 1.080 | 1159.0 | 24,600 | 0.0975 | 0.1211 | 1748 | 3-954 |
| Fraser/ACSS/TW | 946.7 | 10 | 35/7 | 0.346 | 1.077 | 1142.0 | 21,100 | 0.0930 | 0.1159 | 1786 | 3-942 |
| Phoenix/ACSS/TW | 954.0 | 5 | 30/7 | 0.251 | 1.044 | 1028.0 | 14,200 | 0.0927 | 0.1158 | 1769 | 3-949 |
| Rail/ACSS/TW | 954.0 | 7 | 32/7 | 0.291 | 1.061 | 1074.0 | 16,700 | 0.0926 | 0.1155 | 1781 | 3-951 |
| Cardinal/ACSS/TW | 954.0 | 13 | 20/7 | 0.399 | 1.084 | 1227.0 | 26,000 | 0.0915 | 0.1138 | 1805 | 3-954 |
| Kettle/ACSS/TW | 957.2 | 7 | 32/7 | 0.292 | 1.060 | 1079.0 | 16,800 | 0.0923 | 0.1152 | 1783 | 3-951 |
| Suwannee/ACSS/TW | 959.6 | 16 | 22/7 | 0.448 | 1.108 | 1318.0 | 30,700 | 0.0907 | 0.1127 | 1827 | 3-945 |
| Columbia/ACSS/TW | 966.2 | 13 | 21/7 | 0.401 | 1.092 | 1241.0 | 26,400 | 0.0938 | 0.1124 | 1821 | 3-954 |
| Snowbird/ACSS/TW | 1033.5 | 5 | 30/7 | 0.261 | 1.089 | 1114.0 | 15,400 | 0.0856 | 0.1072 | 1865 | 3-949 |
| Ortolan/ACSS/TW | 1033.5 | 7 | 32/7 | 0.303 | 1.102 | 1163.0 | 18,100 | 0.0854 | 0.1069 | 1875 | 3-951 |
| Curlew/ACSS/TW | 1033.5 | 13 | 22/7 | 0.415 | 1.128 | 1326.0 | 28,200 | 0.0845 | 0.1053 | 1902 | 3-954 |
| — | 1080.0 | 7 | 20/7 | 0.310 | 1.131 | 1211.0 | 18,900 | 0.0814 | 0.1020 | 1936 | 3-951 |
| Avocet/ACSS/TW | 1113.0 | 5 | 30/7 | 0.271 | 1.129 | 1199.0 | 16,300 | 0.0794 | 0.0999 | 1957 | 3-949 |
| Bluejay/ACSS/TW | 1113.0 | 7 | 33/7 | 0.315 | 1.143 | 1253.0 | 19,500 | 0.0793 | 0.0996 | 1967 | 3-951 |
| Finch/ACSS/TW | 1113.0 | 13 | 38/19 | 0.431 | 1.185 | 1427.0 | 30,400 | 0.0789 | 0.0986 | 1998 | 3-957 |
| Genesee/ACSS/TW | 1158.0 | 7 | 33/7 | 0.323 | 1.165 | 1308.0 | 20,500 | 0.0762 | 0.0959 | 2018 | 3-951 |
| Hudson/ACSS/TW | 1158.4 | 13 | 26/7 | 0.440 | 1.196 | 1489.0 | 31,100 | 0.0754 | 0.0943 | 2050 | 3-954 |
| Cheyenne/ACSS/TW | 1168.1 | 5 | 30/7 | 0.278 | 1.155 | 1260.0 | 17,200 | 0.0757 | 0.0954 | 2018 | 3-949 |
| Oxbird/ACSS/TW | 1192.5 | 5 | 30/7 | 0.281 | 1.167 | 1285.0 | 17,500 | 0.0741 | 0.0935 | 2046 | 3-949 |
| Bunting/ACSS/TW | 1192.5 | 7 | 33/7 | 0.326 | 1.181 | 1342.0 | 20,900 | 0.0740 | 0.0932 | 2056 | 3-951 |
| Grackle/ACSS/TW | 1192.5 | 13 | 38/19 | 0.446 | 1.225 | 1529.0 | 32,600 | 0.0737 | 0.0923 | 2089 | 3-957 |
| Yukon/ACSS/TW | 1233.6 | 13 | 38/19 | 0.445 | 1.245 | 1586.0 | 33,200 | 0.0712 | 0.0893 | 2136 | 3-954 |
| Nelson/ACSS/TW | 1257.1 | 7 | 35/7 | 0.335 | 1.213 | 1417.0 | 22,100 | 0.0702 | 0.0887 | 2127 | 3-951 |
| Scissortail/ACSS/TW | 1272.0 | 5 | 30/7 | 0.290 | 1.202 | 1371.0 | 18,700 | 0.0695 | 0.0880 | 2132 | 3-949 |
| Catawba/ACSS/TW | 1272.0 | 5 | 30/7 | 0.290 | 1.203 | 1372.0 | 18,700 | 0.0695 | 0.0880 | 2132 | 3-949 |
| Bittern/ACSS/TW | 1272.0 | 7 | 35/7 | 0.336 | 1.220 | 1432.0 | 22,300 | 0.0694 | 0.0877 | 2144 | 3-951 |
| Pheasant/ACSS/TW | 1272.0 | 13 | 39/19 | 0.461 | 1.264 | 1630.0 | 34,100 | 0.0691 | 0.0867 | 2178 | 3-957 |
| Thames/ACSS/TW | 1334.6 | 13 | 39/19 | 0.472 | 1.290 | 1713.0 | 35,800 | 0.0658 | 0.0828 | 2245 | 3-957 |

REFERENCE MATERIAL

Conductor Information for ACSS/TW Conductors (continued)

| CODE NAME | SIZE | TYPE | STRANDING | DIAMETER (IN) | | WEIGHT PER | RATED | RESISTANCE | | AMPACITY | SAG10® CHART NUMBER |
|--------------------|--------|------|-----------|---------------|-------------------|------------|----------|--------------|--------------|----------|---------------------------|
| | KCMIL | | | STEEL CORE | COMPLETE CABLE | 1000 FT | STRENGTH | OHMS/1000 FT | | @ 200° C | |
| | | | | | | LBS | LBS | DC @ 20°C | AC @ 75°C | AMPS | |
| Dipper/ACSS/TW | 1351.5 | 7 | 35/7 | 0.347 | 1.256 | 1521.0 | 23,700 | 0.0653 | 0.0828 | 2229 | 3-951 |
| Martin/ACSS/TW | 1351.5 | 13 | 39/19 | 0.475 | 1.300 | 1732.0 | 36,200 | 0.0650 | 0.0819 | 2264 | 3-957 |
| Mackenzie/ACSS/TW | 1359.7 | 7 | 36/7 | 0.348 | 1.259 | 1530.0 | 23,900 | 0.0649 | 0.0823 | 2237 | 3-951 |
| Truckee/ACSS/TW | 1372.5 | 5 | 30/7 | 0.301 | 1.248 | 1481.0 | 20,200 | 0.0644 | 0.0819 | 2238 | 3-949 |
| Bobolink/ACSS/TW | 1431.0 | 7 | 36/7 | 0.357 | 1.291 | 1611.0 | 25,100 | 0.0617 | 0.0785 | 2312 | 3-951 |
| Plover/ACSS/TW | 1431.0 | 13 | 37/19 | 0.489 | 1.337 | 1834.0 | 38,400 | 0.0614 | 0.0775 | 2350 | 3-957 |
| Merrimack/ACSS/TW | 1433.6 | 13 | 39/19 | 0.489 | 1.340 | 1840.0 | 38,400 | 0.0613 | 0.0774 | 2354 | 3-957 |
| Miramichi/ACSS/TW | 1455.3 | 7 | 36/7 | 0.360 | 1.302 | 1640.0 | 25,600 | 0.0607 | 0.0773 | 2338 | 3-951 |
| St. Croix/ACSS/TW | 1467.8 | 5 | 33/7 | 0.312 | 1.292 | 1585.0 | 21,600 | 0.0602 | 0.0770 | 2338 | 3-949 |
| Rio Grande/ACSS/TW | 1533.3 | 13 | 39/19 | 0.506 | 1.382 | 1968.0 | 41,200 | 0.0573 | 0.0726 | 2456 | 3-957 |
| Potomac/ACSS/TW | 1557.4 | 7 | 36/7 | 0.372 | 1.345 | 1755.0 | 27,300 | 0.0567 | 0.0726 | 2441 | 3-951 |
| Platte/ACSS/TW | 1569.0 | 5 | 33/7 | 0.322 | 1.334 | 1693.0 | 23,100 | 0.0564 | 0.0724 | 2439 | 3-949 |
| Lapwing/ACSS/TW | 1590.0 | 7 | 36/7 | 0.376 | 1.358 | 1790.0 | 27,900 | 0.0555 | 0.0712 | 2473 | 3-951 |
| Falcon/ACSS/TW | 1590.0 | 13 | 42/19 | 0.515 | 1.408 | 2038.0 | 42,600 | 0.0553 | 0.0702 | 2515 | 3-957 |
| Pecos/ACSS/TW | 1622.0 | 13 | 39/19 | 0.532 | 1.424 | 2107.0 | 45,000 | 0.0541 | 0.0688 | 2551 | 3-957 |
| Schuykill/ACSS/TW | 1657.4 | 7 | 36/7 | 0.384 | 1.386 | 1868.0 | 29,100 | 0.0533 | 0.0685 | 2539 | 3-951 |
| James/ACSS/TW | 1730.6 | 13 | 34/19 | 0.538 | 1.470 | 2221.0 | 46,400 | 0.0508 | 0.0649 | 2657 | 3-944 |
| Pee Dee/ACSS/TW | 1758.6 | 7 | 37/7 | 0.396 | 1.427 | 1982.0 | 30,900 | 0.0502 | 0.0649 | 2637 | 3-951 |
| Chukar/ACSS/TW | 1780.0 | 8 | 37/19 | 0.437 | 1.445 | 2061.0 | 35,300 | 0.0495 | 0.0639 | 2670 | 3-959 |
| Cumberland/ACSS/TW | 1926.9 | 13 | 42/19 | 0.567 | 1.545 | 2471.0 | 51,600 | 0.0564 | 0.0715 | 2569 | 3-957 |
| Athabaska/ACSS/TW | 1949.6 | 7 | 42/7 | 0.418 | 1.504 | 2199.0 | 34,300 | 0.0453 | 0.0592 | 2817 | 3-951 |
| Powder/ACSS/TW | 2153.8 | 8 | 64/19 | 0.481 | 1.602 | 2498.0 | 42,100 | 0.0412 | 0.0543 | 3009 | 3-959 |
| Bluebird/ACSS/TW | 2156.0 | 8 | 64/19 | 0.481 | 1.608 | 2512.0 | 42,100 | 0.0411 | 0.0543 | 3014 | 3-959 |
| Santee/ACSS/TW | 2627.3 | 8 | 64/19 | 0.531 | 1.762 | 3048.0 | 51,300 | 0.0338 | 0.0459 | 3403 | 3-959 |

Notes:

1. Data based on a nominal cable manufactured in accordance with ASTM B 857.
2. Resistance and ampacity based on an aluminum conductivity of 63%, IACS at 20°C, and a steel conductivity of 8% IACS at 20°C.
3. Ampacity based on a 200°C conductor temperature, 25°C ambient temperature, 2 ft/sec. wind, in sun, with emissivity of 0.5 and a coefficient of solar absorption of 0.5, at sea level.
4. Rated strengths based on Class A galvanized steel core wire in accordance with ASTM B 498.