

### DOSSERT<sup>®</sup> TYPE GW-AA

#### Grounding Clamp for 2 Cables to Pipe in Parallel

Ground clamp is designed to clamp two cables to pipe.

#### Material

Aluminum Alloy

#### Hardware

Yellow anodized aluminum nuts, U-bolt and lockwashers.

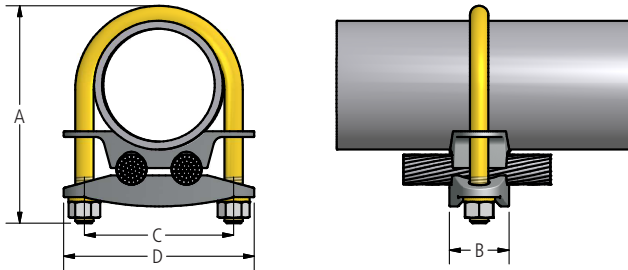
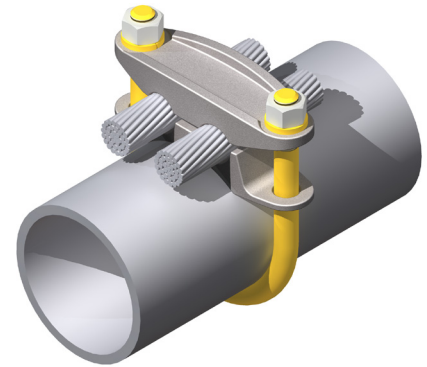

### Ordering Information

CATALOG NUMBER	GROUND ROD	SPS	CONDUCTOR RANGE ACC		U-BOLT SIZE	DIMENSIONS IN INCHES			
			MIN	MAX		A	B	C	D
GW75-4-AA	7/8 or 1	3/4	#8 Sol.	#4 Str.	3/8	-	-	-	-
GW75-13-AA	7/8 or 1	3/4	#4 Sol.	2/0 Str.	3/8	-	-	-	-
GW75-25-AA	7/8 or 1	3/4	2/0 Sol.	250 MCM	3/8	-	-	-	-
GW75-50-AA	7/8 or 1	3/4	300 MCM	500 MCM	3/8	-	-	-	-
GW100-4-AA	1 1/8-1 1/4	1	#8 Sol.	#4 Str.	3/8	2 7/8	1 1/8	1 3/4	2 9/16
GW100-13-AA	1 1/8-1 1/4	1	#4 Sol.	2/0 Str.	3/8	3	1 1/8	1 3/4	2 9/16
GW100-25-AA	1 1/8-1 1/4	1	2/0 Sol.	250 MCM	3/8	3 3/8	1 1/8	1 3/4	2 9/16
GW125-4-AA	1 3/8-1 5/8	1 1/4	#8 Sol.	#4 Str.	3/8	3 3/16	1 3/8	2 1/8	3
GW125-13-AA	1 3/8-1 5/8	1 1/4	#4 Sol.	2/0 Str.	3/8	3 3/8	1 3/8	2 1/8	3
GW125-25-AA	1 3/8-1 5/8	1 1/4	2/0 Sol.	250 MCM	3/8	3 5/8	1 7/16	2 1/8	3
GW150-4-AA	1 5/8-1 7/8	1 1/2	#8 Sol.	#4 Str.	3/8	3 1/2	1 3/8	2 3/8	3 1/4
GW150-13-AA	1 5/8-1 7/8	1 1/2	#4 Sol.	2/0 Str.	3/8	3 11/16	1 3/8	2 3/8	3 1/4
GW150-25-AA	1 5/8-1 7/8	1 1/2	2/0 Sol.	250 MCM	3/8	3 3/4	1 7/16	2 3/8	3 1/4
GW150-50-AA	1 5/8-1 7/8	1 1/2	300 MCM	500 MCM	1/2	4 3/8	1 9/16	2 1/2	3 1/4
GW200-4-AA	2-2 1/2	2	#8 Sol.	#4 Str.	3/8	4	1 3/8	2 13/16	3 5/8
GW200-13-AA	2-2 1/2	2	#4 Sol.	2/0 Str.	3/8	4 3/8	1 3/8	2 13/16	3 5/8
GW200-25-AA	2-2 1/2	2	2/0 Sol.	250 MCM	3/8	4 1/2	1 7/16	2 13/16	3 5/8
GW200-50-AA	2-2 1/2	2	300 MCM	500 MCM	1/2	4 7/8	1 9/16	2 15/16	4
GW250-4-AA	2 5/8-2 7/8	2 1/2	#8 Sol.	#4 Str.	3/8	4 1/2	1 3/8	3 5/16	4 3/16
GW250-13-AA	2 5/8-2 7/8	2 1/2	#4 Sol.	2/0 Str.	3/8	4 3/4	1 3/8	3 5/16	4 3/16
GW250-25-AA	2 5/8-2 7/8	2 1/2	2/0 Sol.	250 MCM	3/8	4 7/8	1 7/16	3 5/16	4 3/16
GW250-50-AA	2 5/8-2 7/8	2 1/2	300 MCM	500 MCM	1/2	5 1/4	1 9/16	3 7/16	4 5/8
GW300-13-AA	3 1/4-3 1/2	3	#4 Sol.	2/0 Str.	3/8	5 7/16	1 3/8	4	4 7/8
GW300-25-AA	3 1/4-3 1/2	3	2/0 Sol.	250 MCM	3/8	5 9/16	1 7/16	4	4 7/8
GW300-50-AA	3 1/4-3 1/2	3	300 MCM	500 MCM	1/2	5 7/8	1 9/16	4 1/8	5 3/16
GW350-4-AA	3 3/4-4	3 1/2	#8 Sol.	#4 Str.	3/8	5 5/8	1 1/2	4 7/16	5 3/8
GW350-13-AA	3 3/4-4	3 1/2	#4 Sol.	2/0 Str.	3/8	5 7/8	1 1/2	4 7/16	5 3/8
GW350-25-AA	3 3/4-4	3 1/2	2/0 Sol.	250 MCM	3/8	6 1/8	1 1/2	4 7/16	5 3/8
GW350-50-AA	3 3/4-4	3 1/2	300 MCM	500 MCM	1/2	6 3/8	1 5/8	4 9/16	5 3/4
GW400-4-AA	4 1/4-4 1/2	4	#8 Sol.	#4 Str.	3/8	6 1/8	1 5/8	4 15/16	5 7/8
GW400-13-AA	4 1/4-4 1/2	4	#4 Sol.	2/0 Str.	3/8	6 1/4	1 5/8	4 15/16	5 7/8
GW400-25-AA	4 1/4-4 1/2	4	2/0 Sol.	250 MCM	3/8	6 1/2	1 5/8	4 15/16	5 7/8
GW400-50-AA	4 1/4-4 1/2	4	300 MCM	500 MCM	1/2	6 7/8	1 5/8	5 1/16	6 3/16