

DOSSERT®

TYPE UPT-AA

U-bolt Pipe to Cable Tee Connector

Tee connector is designed for connecting stranded aluminum or ACSR conductor to tubular bus. Four clamp bolts on each conductor insures positive electrical contact.

Material

Aluminum Alloy

Hardware

Yellow anodized aluminum bolts, U-bolt, nuts, and lockwashers.

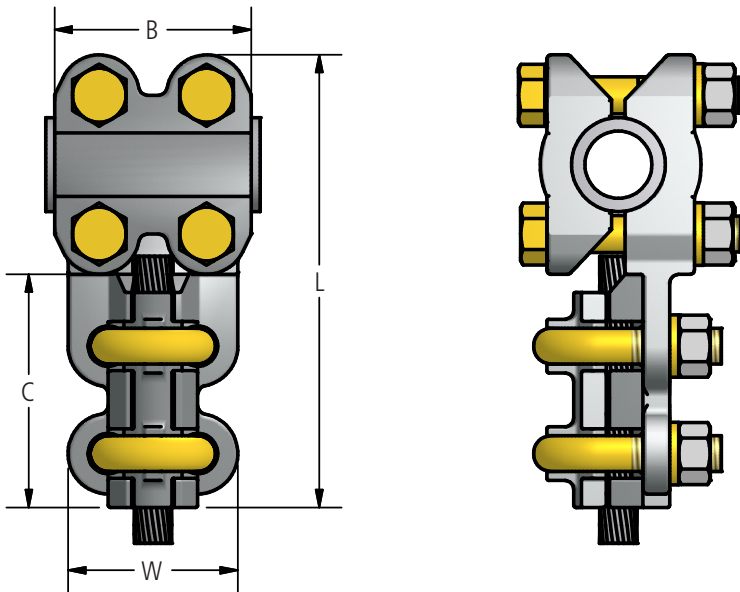
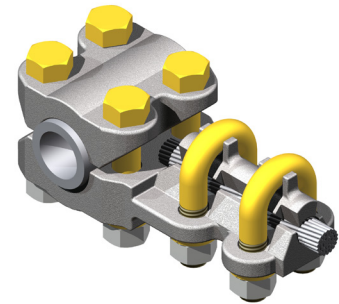

230 kV Aluminum Bolted Tee & Vee Connectors

Ordering Information

CATALOG NUMBER	SPS	AAC CABLE RANGE		DIMENSIONS IN INCHES				BOLT SIZE	
		MIN	MAX	B	C	L	W	MAIN	TAP
UPT50-13-AA	1/2	6STR	2/0STR	2 1/2	3	5 3/4	2 1/8	1/2	1/2
UPT50-21-AA	1/2	1STR	4/0STR	2 1/2	3	5 3/4	2 7/32	1/2	1/2
UPT50-30-AA	1/2	1/0STR	300MCM	2 1/2	3 1/4	6	2 5/16	1/2	1/2
UPT75-13-AA	3/4	6STR	2/0STR	2 3/4	3	6	2 1/8	1/2	1/2
UPT75-21-AA	3/4	1STR	4/0STR	2 3/4	3	6	2 7/32	1/2	1/2
UPT75-30-AA	3/4	1/0STR	300MCM	2 3/4	3 1/4	6 1/4	2 5/16	1/2	1/2
UPT75-50-AA	3/4	300MCM	500MCM	2 3/4	3 1/4	6 1/4	2 1/2	1/2	1/2
UPT100-13-AA	1	6STR	2/0STR	2 3/4	3	6 1/4	2 1/8	1/2	1/2
UPT100-21-AA	1	1STR	4/0STR	2 3/4	3	6 1/4	2 7/32	1/2	1/2
UPT100-30-AA	1	1/0STR	300MCM	2 3/4	3 1/4	6 1/2	2 5/16	1/2	1/2
UPT100-50-AA	1	300MCM	500MCM	2 3/4	3 1/4	6 1/2	2 1/2	1/2	1/2
UPT100-90-AA	1	500MCM	900MCM	2 3/4	3 1/2	6 3/4	2 13/16	1/2	1/2
UPT125-13-AA	1 1/4	6STR	2/0STR	3	3	6 5/8	2 1/8	1/2	1/2
UPT125-21-AA	1 1/4	1STR	4/0STR	3	3	6 5/8	2 7/32	1/2	1/2



230 kV Aluminum Bolted Tee & Vee Connectors

DOSSERT®

TYPE UPT-AA

U-bolt Pipe to Cable Tee Connector

Ordering Information

CATALOG NUMBER	SPS	AAC CABLE RANGE		DIMENSIONS IN INCHES				BOLT SIZE	
		MIN	MAX	B	C	L	W	MAIN	TAP
UPT125-30-AA	1 1/4	1/0STR	300MCM	3	3 1/4	6 7/8	2 5/16	1/2	1/2
UPT125-50-AA	1 1/4	300MCM	500MCM	3	3 1/4	6 7/8	2 1/2	1/2	1/2
UPT125-90-AA	1 1/4	500MCM	900MCM	3	3 1/2	7 1/8	2 13/16	1/2	1/2
UPT125-100-AA	1 1/4	750MCM	1000MCM	3	3 1/2	7 1/8	2 27/32	1/2	1/2
UPT150-13-AA	1 1/2	6STR	2/0STR	3	3	6 7/8	2 7/32	1/2	1/2
UPT150-21-AA	1 1/2	1STR	4/0STR	3	3	6 7/8	2 7/32	1/2	1/2
UPT150-30-AA	1 1/2	1/0STR	300MCM	3	3 1/4	7 1/8	2 5/16	1/2	1/2
UPT150-50-AA	1 1/2	300MCM	500MCM	3	3 1/4	7 1/8	2 1/2	1/2	1/2
UPT150-90-AA	1 1/2	500MCM	900MCM	3	3 1/2	7 3/8	2 13/16	1/2	1/2
UPT150-100-AA	1 1/2	800MCM	1000MCM	3	3 1/2	7 3/8	2 27/32	1/2	1/2
UPT150-150-AA	1 1/2	1000MCM	1500MCM	3	4 1/2	8 3/8	3 1/4	1/2	5/8
UPT150-200-AA	1 1/2	1500MCM	2000MCM	3	4 1/2	8 3/8	3 3/4	1/2	5/8
UPT200-21-AA	2	1STR	4/0STR	3 1/4	3	7 3/8	2 7/32	1/2	1/2
UPT200-30-AA	2	1/0STR	300MCM	3 1/4	3 1/4	7 5/8	2 5/16	1/2	1/2
UPT200-50-AA	2	300MCM	500MCM	3 1/4	3 1/4	7 5/8	2 1/2	1/2	1/2
UPT200-90-AA	2	500MCM	900MCM	3 1/4	3 1/2	7 7/8	2 13/16	1/2	1/2
UPT200-100-AA	2	750MCM	1000MCM	3 1/4	3 1/2	7 7/8	2 27/32	1/2	1/2
UPT200-150-AA	2	1000MCM	1500MCM	3 1/4	4 1/2	8 7/8	3 1/4	1/2	5/8
UPT200-200-AA	2	1500MCM	2000MCM	3 1/4	4 1/2	8 7/8	3 3/4	1/2	5/8
UPT25030AA	2 1/2	1/0STR	300MCM	3 1/4	3 1/4	8 1/8	2 5/16	1/2	1/2
UPT25050AA	2 1/2	300MCM	500MCM	3 1/4	3 1/4	8 1/8	2 1/2	1/2	1/2
UPT25090AA	2 1/2	500MCM	900MCM	3 1/4	3 1/2	8 3/8	2 13/16	1/2	1/2
UPT250100AA	2 1/2	750MCM	1000MCM	3 1/4	3 1/2	8 3/8	2 27/32	1/2	1/2
UPT250150AA	2 1/2	1000MCM	1500MCM	3 1/4	4 1/2	9 3/8	3 1/4	1/2	5/8
UPT250200AA	2 1/2	1500MCM	2000MCM	3 1/4	4 1/2	9 3/8	3 3/4	1/2	5/8
UPT30030AA	3	1/0STR	300MCM	3 1/4	3 1/4	8 3/4	2 5/16	1/2	1/2
UPT30050AA	3	300MCM	500MCM	3 1/4	3 1/4	8 3/4	2 1/2	1/2	1/2
UPT300-90-AA	3	500MCM	900MCM	3 1/4	3 1/2	9	2 13/16	1/2	1/2
UPT300100AA	3	750MCM	1000MCM	3 1/4	3 1/2	9	2 27/32	1/2	1/2
UPT300-150-AA	3	1000MCM	1500MCM	3 3/4	4 1/2	10 3/8	3 1/4	5/8	5/8
UPT300-200-AA	3	1500MCM	2000MCM	3 3/4	4 1/2	10 3/8	3 3/4	5/8	5/8
UPT400-30-AA	4	1/0STR	300MCM	3 3/4	4 1/2	10 3/8	2 1/3	5/8	5/8
UPT500150AA	5	1000MCM	1500MCM	3 3/4	4	10 3/8	3 1/4	5/8	5/8

230 kV Aluminum Bolted Tee & Vee Connectors