

## DOSSERT®

### TYPE AC, ACA Parallel Clamp

#### Material

Aluminum Alloy

#### Hardware

AC Galvanized steel U-bolts, nuts, and lockwashers.

ACA Yellow anodized aluminum U-bolts, nuts, and lockwashers.

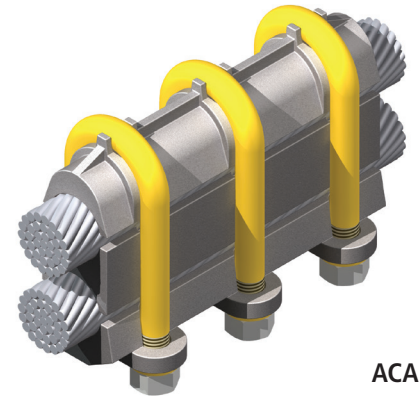

ACA

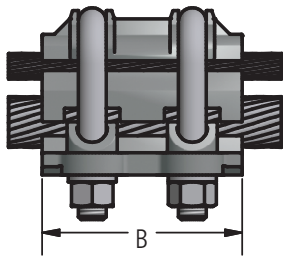

FIG. 1

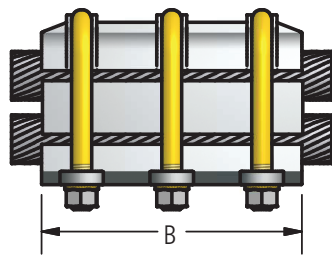

FIG. 2

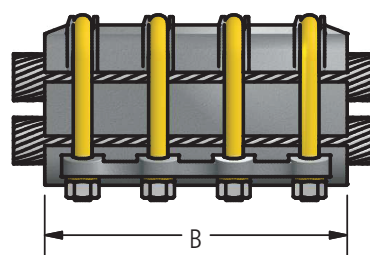
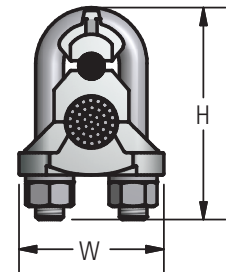

FIG. 3



### Ordering Information

| CATALOG NUMBER |         | FIG. NO. | ACSR RANGE |           |           |           | ALUMINUM RANGE |            |         |            | DIMENSIONS IN INCHES |         |        | BOLT SIZE |
|----------------|---------|----------|------------|-----------|-----------|-----------|----------------|------------|---------|------------|----------------------|---------|--------|-----------|
| AC             | ACA     |          | MAIN       |           | TAP       |           | MAIN           |            | TAP     |            | B                    | H       | W      |           |
|                |         |          | MIN        | MAX       | MIN       | MAX       | MIN            | MAX        | MIN     | MAX        |                      |         |        |           |
| AC401          | ACA401  | 1        | #2 SOL     | 1/0 STR   | #2 SOL    | 1/0 STR   | #2 SOL         | 2/0 STR    | #2 SOL  | 2/0 STR    | 3                    | 3 1/4   | 2 3/8  | 1/2       |
| AC402          | ACA402  | 1        | 2/0 STR    | 3/0 STR   | #2 SOL    | 1/0 STR   | 3/0 STR        | 4/0 STR    | #2 SOL  | 2/0 STR    | 3 3/8                | 3 1/2   | 2 3/8  | 1/2       |
| AC403          | ACA403  | 1        | 2/0 STR    | 3/0 STR   | 2/0 STR   | 3/0 STR   | 3/0 STR        | 4/0 STR    | 3/0 STR | 4/0 STR    | 3 3/8                | 3 1/2   | 2 3/8  | 1/2       |
| AC404          | ACA404  | 1        | 3/0 STR    | 300 MCM   | #2 SOL    | 1/0 STR   | 4/0 STR        | 350 MCM    | #2 SOL  | 2/0 STR    | 3 5/8                | 3 5/8   | 2 1/2  | 1/2       |
| AC405          | ACA405  | 1        | 3/0 STR    | 300 MCM   | 2/0 STR   | 3/0 STR   | 4/0 STR        | 350 MCM    | 3/0 STR | 4/0 STR    | 3 5/8                | 3 7/8   | 2 1/2  | 1/2       |
| AC406          | ACA406  | 1        | 3/0 STR    | 300 MCM   | 3/0 STR   | 300 MCM   | 4/0 STR        | 350 MCM    | 4/0 STR | 350 MCM    | 3 5/8                | 3 7/8   | 2 1/2  | 1/2       |
| AC407          | ACA407  | 1        | 300 MCM    | 397.5 MCM | #2 SOL    | 1/0 STR   | 350 MCM        | 477 MCM    | #2 SOL  | 2/0 STR    | 3 7/8                | 4 3/8   | 3      | 5/8       |
| AC408          | ACA408  | 1        | 300 MCM    | 397.5 MCM | 2/0 STR   | 3/0 STR   | 350 MCM        | 477 MCM    | 3/0 STR | 4/0 STR    | 3 7/8                | 4 3/8   | 3      | 5/8       |
| AC409          | ACA409  | 1        | 300 MCM    | 397.5 MCM | 3/0 STR   | 300 MCM   | 350 MCM        | 477 MCM    | 4/0 STR | 350 MCM    | 3 7/8                | 4 5/8   | 3      | 5/8       |
| AC410          | ACA410  | 1        | 300 MCM    | 397.5 MCM | 300 MCM   | 397.5 MCM | 350 MCM        | 477 MCM    | 350 MCM | 477 MCM    | 3 7/8                | 4 5/8   | 3      | 5/8       |
| AC411          | ACA411  | 1        | 397.5 MCM  | 605 MCM   | 2/0 STR   | 3/0 STR   | 500 MCM        | 715.5 MCM  | 500 MCM | 715.5 MCM  | 4 3/8                | 4 3/4   | 3 1/8  | 5/8       |
| AC412          | ACA412  | 1        | 397.5 MCM  | 605 MCM   | 3/0 STR   | 300 MCM   | 500 MCM        | 715.5 MCM  | 4/0 STR | 350 MCM    | 4 3/8                | 4 3/4   | 3 1/8  | 5/8       |
| AC413          | ACA413  | 1        | 397.5 MCM  | 605 MCM   | 300 MCM   | 397.5 MCM | 500 MCM        | 715.5 MCM  | 350 MCM | 477 MCM    | 4 3/8                | 5       | 3 1/8  | 5/8       |
| AC414          | ACA414  | 1        | 397.5 MCM  | 605 MCM   | 397.5 MCM | 605 MCM   | 500 MCM        | 715.5 MCM  | 500 MCM | 715.5 MCM  | 4 3/8                | 5       | 3 1/8  | 5/8       |
| AC415          | ACA415  | 1        | 605 MCM    | 900 MCM   | 3/0 STR   | 300 MCM   | 750 MCM        | 1033.5 MCM | 4/0 STR | 350 MCM    | 4 3/4                | 5 1/8   | 3 3/8  | 5/8       |
| AC416          | ACA416  | 1        | 605 MCM    | 900 MCM   | 300 MCM   | 397.5 MCM | 750 MCM        | 1033.5 MCM | 350 MCM | 477 MCM    | 4 3/4                | 5 1/8   | 3 3/8  | 5/8       |
| AC417          | ACA417  | 1        | 605 MCM    | 900 MCM   | 397.5 MCM | 605 MCM   | 750 MCM        | 1033.5 MCM | 500 MCM | 715.5 MCM  | 4 3/4                | 5 1/2   | 3 3/8  | 5/8       |
| AC418          | ACA418  | 1        | 605 MCM    | 900 MCM   | 605 MCM   | 900 MCM   | 750 MCM        | 1033.5 MCM | 750 MCM | 1033.5 MCM | 4 3/4                | 5 1/2   | 3 3/8  | 5/8       |
| AC418S         | ACA418S | 1        | 477 MCM    | 636.4 MCM | 2/0 STR   | 336.4 MCM | 477 MCM        | 795 MCM    | 477 MCM | 795 MCM    | 4 3/4                | 4 7/8   | 3 1/8  | 5/8       |
| AC450          | ACA450  | 1        | 1/0 STR    | 336.4 MCM | 1/0 STR   | 336.4 MCM | 1/0 STR        | 397.5 MCM  | 1/0 STR | 397.5 MCM  | 3 5/8                | 4 3/16  | 2 1/2  | 1/2       |
| AC460          | ACA460  | 1        | 300 MCM    | 795 MCM   | 1/0 STR   | 336.4 MCM | 336.4 MCM      | 954 MCM    | 1/0 STR | 397.5 MCM  | 4 5/8                | 4 15/16 | 3 1/16 | 1/2       |
| AC462          | ACA462  | 1        | 336.4 MCM  | 795 MCM   | 110.8 MCM | 447 MCM   | 397.5 MCM      | 954 MCM    | 3/0 STR | 500 MCM    | 4 5/8                | 4 15/16 | 3 1/16 | 1/2       |

continued



# 230 kV Aluminum Bolted Parallel Clamps

**DOSSERT®**

**TYPE AC, ACA**  
Parallel Clamp

## Ordering Information

| CATALOG NUMBER |        | FIG. NO. | ACSR RANGE |            |            |            | ALUMINUM RANGE |            |            |            | DIMENSIONS IN INCHES |        |         | BOLT SIZE |
|----------------|--------|----------|------------|------------|------------|------------|----------------|------------|------------|------------|----------------------|--------|---------|-----------|
| AC             | ACA    |          | MAIN       |            | TAP        |            | MAIN           |            | TAP        |            | B                    | H      | W       |           |
|                |        |          | MIN        | MAX        | MIN        | MAX        | MIN            | MAX        | MIN        | MAX        |                      |        |         |           |
| AC470          | ACA470 | 1        | 300 MCM    | 795 MCM    | 300 MCM    | 795 MCM    | 336.4 MCM      | 954 MCM    | 336.4 MCM  | 954 MCM    | 4 5/8                | 5 9/16 | 3 7/32  | 5/8       |
| AC480          | ACA480 | 1        | 795 MCM    | 1033.5 MCM | 795 MCM    | 1033.5 MCM | 800 MCM        | 1113 MCM   | 800 MCM    | 1113 MCM   | 4 5/8                | 5 3/4  | 3 5/16  | 5/8       |
| AC504          | ACA504 | 2        | 397.5 MCM  | 605 MCM    | 397.5 MCM  | 605 MCM    | 500 MCM        | 715.5 MCM  | 500 MCM    | 715.5 MCM  | 5 7/8                | 5      | 3 1/8   | 5/8       |
| AC505          | ACA505 | 2        | 605 MCM    | 900 MCM    | 3/0 STR    | 300 MCM    | 750 MCM        | 1033.5 MCM | 4/0 STR    | 350 MCM    | 6 3/4                | 5 1/8  | 3 3/8   | 5/8       |
| AC506          | ACA506 | 2        | 605 MCM    | 900 MCM    | 300 MCM    | 397.5 MCM  | 750 MCM        | 1033.5 MCM | 350 MCM    | 477 MCM    | 6 3/4                | 5 1/8  | 3 3/8   | 5/8       |
| AC507          | ACA507 | 2        | 605 MCM    | 900 MCM    | 397.5 MCM  | 605 MCM    | 750 MCM        | 1033.5 MCM | 500 MCM    | 715.5 MCM  | 6 3/4                | 5 1/2  | 3 3/8   | 5/8       |
| AC508          | ACA508 | 2        | 605 MCM    | 900 MCM    | 605 MCM    | 900 MCM    | 750 MCM        | 1033.5 MCM | 750 MCM    | 1033.5 MCM | 6 3/4                | 5 1/2  | 3 3/8   | 5/8       |
| AC509          | ACA509 | 2        | 954 MCM    | 1192.5 MCM | 300 MCM    | 397.5 MCM  | 1113 MCM       | 1351.5 MCM | 350 MCM    | 477 MCM    | 8 1/8                | 5 5/16 | 3 7/8   | 3/4       |
| AC510          | ACA510 | 2        | 954 MCM    | 1192.5 MCM | 397.5 MCM  | 605 MCM    | 1113 MCM       | 1351.5 MCM | 500 MCM    | 715.5 MCM  | 8 1/8                | 5 5/16 | 3 7/8   | 3/4       |
| AC511          | ACA511 | 2        | 954 MCM    | 1192.5 MCM | 605 MCM    | 900 MCM    | 1113 MCM       | 1351.5 MCM | 750 MCM    | 1033.5 MCM | 8                    | 6 3/8  | 3 7/8   | 5/8       |
| AC512          | ACA512 | 2        | 954 MCM    | 1192.5 MCM | 954 MCM    | 1192.5 MCM | 1113 MCM       | 1351.5 MCM | 1113 MCM   | 1351.5 MCM | 8                    | 6 3/8  | 3 7/8   | 3/4       |
| AC513          | ACA513 | 2        | 1272 MCM   | 1590 MCM   | 397.5 MCM  | 605 MCM    | 1431 MCM       | 1750 MCM   | 500 MCM    | 715.5 MCM  | 9 3/4                | 6 5/8  | 4 1/8   | 3/4       |
| AC514          | ACA514 | 2        | 1272 MCM   | 1590 MCM   | 605 MCM    | 900 MCM    | 1431 MCM       | 1750 MCM   | 750 MCM    | 1033.5 MCM | 9 3/4                | 6 5/8  | 4 1/8   | 3/4       |
| AC515          | ACA515 | 2        | 1272 MCM   | 1590 MCM   | 954 MCM    | 1192.5 MCM | 1431 MCM       | 1750 MCM   | 1113 MCM   | 1351.5 MCM | 9 3/4                | 7      | 4 1/8   | 3/4       |
| AC516          | ACA516 | 2        | 1033.5 MCM | 1590 MCM   | 1033.5 MCM | 1590 MCM   | 1033.5 MCM     | 1750 MCM   | 1033.5 MCM | 1750 MCM   | 9 3/4                | 7      | 4 1/8   | 5/8       |
| AC518          | ACA518 | 2        | 1780 MCM   | 2300 MCM   | 605 MCM    | 1033.5 MCM | 2000 MCM       | 2500 MCM   | 700 MCM    | 1192.5 MCM | 9 3/4                | 6 1/2  | 4 5/16  | 5/8       |
| AC520          | ACA520 | 2        | 1780 MCM   | 2300 MCM   | 1780 MCM   | 2300 MCM   | 2000 MCM       | 2500 MCM   | 2000 MCM   | 2500 MCM   | 9 3/4                | 7 3/8  | 4 5/16  | 5/8       |
| AC604          | ACA604 | 3        | 336.4 MCM  | 397.5 MCM  | 336.4 MCM  | 397.5 MCM  | 350 MCM        | 477 MCM    | 350 MCM    | 477 MCM    | 7                    | 4 1/2  | 2 1/2   | 1/2       |
| AC605          | ACA605 | 3        | 397.5 MCM  | 605 MCM    | 336.4 MCM  | 397.5 MCM  | 500 MCM        | 715.5 MCM  | 350 MCM    | 477 MCM    | 7                    | 4 3/4  | 2 11/16 | 1/2       |
| AC606          | ACA606 | 3        | 397.5 MCM  | 605 MCM    | 397.5 MCM  | 605 MCM    | 500 MCM        | 715.5 MCM  | 500 MCM    | 715.5 MCM  | 7 1/2                | 4 3/4  | 2 11/16 | 1/2       |
| AC607          | ACA607 | 3        | 605 MCM    | 900 MCM    | 336.4 MCM  | 397.5 MCM  | 715.5 MCM      | 1033.5 MCM | 350 MCM    | 477 MCM    | 7 1/2                | 4 7/8  | 2 15/16 | 1/2       |
| AC608          | ACA608 | 3        | 605 MCM    | 900 MCM    | 397.5 MCM  | 605 MCM    | 715.5 MCM      | 1033.5 MCM | 500 MCM    | 715.5 MCM  | 7 1/2                | 4 7/8  | 2 15/16 | 1/2       |
| AC609          | ACA609 | 3        | 605 MCM    | 900 MCM    | 605 MCM    | 900 MCM    | 715.5 MCM      | 1033.5 MCM | 715.5 MCM  | 1033.5 MCM | 7 1/2                | 4 7/8  | 2 15/16 | 1/2       |
| AC610          | ACA610 | 3        | 954 MCM    | 1192.5 MCM | 336.4 MCM  | 397.5 MCM  | 1000 MCM       | 1351.5 MCM | 350 MCM    | 477 MCM    | 10                   | 5 1/4  | 3 7/16  | 5/8       |
| AC611          | ACA611 | 3        | 954 MCM    | 1192.5 MCM | 397.5 MCM  | 605 MCM    | 1000 MCM       | 1351.5 MCM | 500 MCM    | 715.5 MCM  | 10                   | 5 1/4  | 3 7/16  | 5/8       |
| AC612          | ACA612 | 3        | 954 MCM    | 1192.5 MCM | 605 MCM    | 1033.5 MCM | 1000 MCM       | 1351.5 MCM | 700 MCM    | 1192.5 MCM | 10                   | 5 3/4  | 3 7/16  | 5/8       |
| AC613          | ACA613 | 3        | 954 MCM    | 1192.5 MCM | 954 MCM    | 1192.5 MCM | 1000 MCM       | 1351.5 MCM | 1000 MCM   | 1351.5 MCM | 10                   | 5 3/4  | 3 7/16  | 5/8       |
| AC614          | ACA614 | 3        | 1272 MCM   | 1590 MCM   | 336.4 MCM  | 397.5 MCM  | 1431 MCM       | 1750 MCM   | 350 MCM    | 477 MCM    | 10                   | 5 3/8  | 3 5/8   | 5/8       |
| AC615          | ACA615 | 3        | 1272 MCM   | 1590 MCM   | 397.5 MCM  | 605 MCM    | 1431 MCM       | 1750 MCM   | 500 MCM    | 715.5 MCM  | 10                   | 5 5/8  | 3 5/8   | 5/8       |
| AC616          | ACA616 | 3        | 1272 MCM   | 1590 MCM   | 605 MCM    | 900 MCM    | 1431 MCM       | 1750 MCM   | 715.5 MCM  | 1033.5 MCM | 10                   | 5 3/4  | 3 5/8   | 5/8       |
| AC617          | ACA617 | 3        | 1272 MCM   | 1590 MCM   | 954 MCM    | 1192.5 MCM | 1431 MCM       | 1750 MCM   | 1000 MCM   | 1351.5 MCM | 10                   | 6      | 3 5/8   | 5/8       |
| AC618          | ACA618 | 3        | 1272 MCM   | 1590 MCM   | 1272 MCM   | 1590 MCM   | 1431 MCM       | 1750 MCM   | 1431 MCM   | 1750 MCM   | 10                   | 6      | 3 5/8   | 5/8       |

230 kV – Bolted Parallel Clamps