

DOSSERT® S5600 Series, S5100 Series Terminal Connectors

The S5600, S5100 Series Terminal Connector is designed for ACSR and AAC conductors. The terminal is fabricated from ACA seamless drawn aluminum.

Notes

Other pads sizes can be custom ordered.

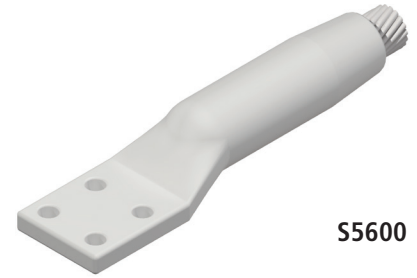

S5600



S5100

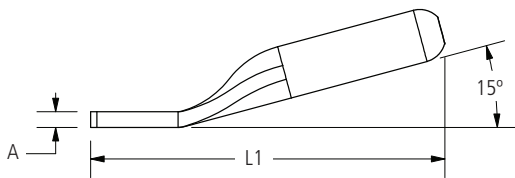

S5100

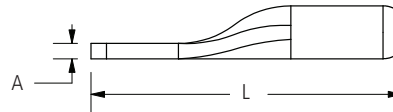

S5600

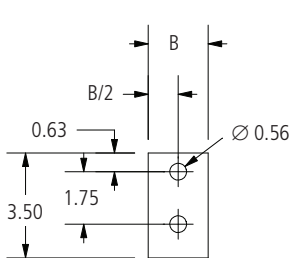

PAD B

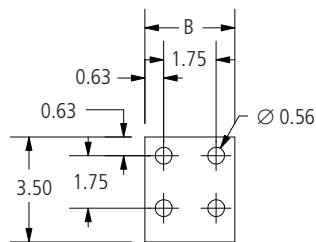

PAD D

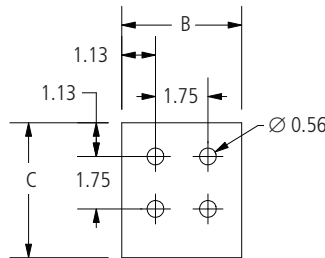

PAD E

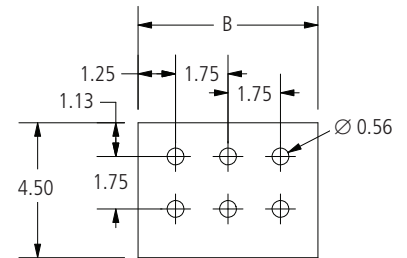

PAD G

Ordering Information

| CATALOG NUMBER | | CONDUCTOR | | | | | DIE SIZE ALUMINUM HEX DIE | DIMENSIONS IN INCHES | | | | | PAD SIZE |
|----------------|------------|----------------|-----------|---------------|--------------------|-----------------------|---------------------------------|----------------------|------|---|------|------|-------------|
| STRAIGHT | 15 DEGREE | ACSR OR AAC | CODE WORD | SIZE KCMIL | STRANDING AL/ST | DIAMETER IN INCHES | | A | B | C | L | L1 | |
| S5673.391 | S5173.391 | AAC | Poppy | 1/0 | 7 | 0.368 | 73AH | 0.20 | 1.00 | — | 7.44 | 6.44 | B |
| S5673.391D | S5173.391D | AAC | Poppy | 1/0 | 7 | 0.368 | 73AH | 0.50 | 3.00 | — | 7.84 | 6.44 | D |
| S5674.438 | S5174.438 | ACSR | Raven | 1/0 | 6/1 | 0.398 | 74AH | 0.30 | 1.00 | — | 7.81 | 7.31 | B |
| | | AAC | Aster | 2/0 | 7 | 0.414 | | | | | | | |
| S5674.438D | S5174.438D | ACSR | Raven | 1/0 | 6/1 | 0.398 | 74AH | 0.50 | 3.00 | — | 7.84 | 7.31 | D |
| | | AAC | Aster | 2/0 | 7 | 0.414 | | | | | | | |
| S5674.484 | S5174.484 | ACSR | Quail | 2/0 | 6/1 | 0.447 | 74AH | 0.30 | 1.00 | — | 7.81 | 7.31 | B |
| | | ACSR | Phlox | 3/0 | 7 | 0.464 | | | | | | | |
| S5675.547 | S5175.547 | ACSR | Pigeon | 3/0 | 6/1 | 0.502 | 75AH | 0.50 | 1.00 | — | 8.38 | 7.00 | B |
| | | AAC | Oxlip | 4/0 | 7 | 0.522 | | | | | | | |
| S5675.547D | S5175.547D | ACSR | Pigeon | 3/0 | 6/1 | 0.502 | 75AH | 0.50 | 3.00 | — | 8.20 | 6.88 | D |
| | | AAC | Oxlip | 4/0 | 7 | 0.522 | | | | | | | |
| S5675.609 | S5175.609 | ACSR | Penguin | 4/0 | 6/1 | 0.563 | 75AH | 0.50 | 1.00 | — | 8.38 | 7.00 | B |
| | | AAC | Valerian | 250 | 19 | 0.575 | | | | | | | |
| | | AAC | Laurel | 266.8 | 19 | 0.593 | | | | | | | |

DOSSERT®

S5600 Series, S5100 Series (cont.)

Terminal Connectors

Ordering Information

| CATALOG NUMBER | | CONDUCTOR | | | | | DIE SIZE ALUMINUM HEX DIE | DIMENSIONS IN INCHES | | | | | PAD SIZE |
|----------------|------------|----------------|-------------|---------------|--------------------|-----------------------|---------------------------------|----------------------|------|---|-------|-------|-------------|
| STRAIGHT | 15 DEGREE | ACSR OR AAC | CODE WORD | SIZE KCMIL | STRANDING AL/ST | DIAMETER IN INCHES | | A | B | C | L | L1 | |
| S5675.609D | S5175.609D | ACSR | Penguin | 4/0 | 6/1 | 0.563 | 75AH | 0.50 | 3.00 | — | 8.18 | 7.00 | D |
| | | AAC | Valerian | 250 | 19 | 0.575 | | | | | | | |
| | | AAC | Laurel | 266.8 | 19 | 0.593 | | | | | | | |
| S5676.656 | S5176.656 | ACSR | Waxwing | 266.8 | 18/1 | 0.609 | 76AH | 0.60 | 1.30 | — | 8.81 | 9.00 | B |
| | | AAC | Peony | 300 | 19 | 0.629 | | | | | | | |
| S5676.656D | S5176.656D | ACSR | Waxwing | 266.8 | 18/1 | 0.609 | 76AH | 0.50 | 3.00 | — | 7.36 | 9.00 | D |
| | | AAC | Peony | 300 | 19 | 0.629 | | | | | | | |
| S5676.688 | S5176.688 | ACSR | Owl | 266.8 | 6/7 | 0.633 | 76AH | 0.60 | 1.30 | — | 8.81 | 9.00 | B |
| | | ACSR | Partridge | 266.8 | 26/7 | 0.642 | | | | | | | |
| | | AAC | Tulip | 336.4 | 19 | 0.666 | | | | | | | |
| S5676.688D | S5176.688D | ACSR | Owl | 266.8 | 6/7 | 0.633 | 76AH | 0.50 | 3.00 | — | 7.34 | 9.00 | D |
| | | ACSR | Partridge | 266.8 | 26/7 | 0.642 | | | | | | | |
| | | AAC | Tulip | 336.4 | 19 | 0.666 | | | | | | | |
| S5620.719 | S5120.719 | AAC | Daffodil | 350 | 19 | 0.679 | 20AH | 0.50 | 1.30 | — | 10.50 | 8.50 | B |
| S5676.719 | S5176.719 | ACSR | Ostrich | 300 | 26/7 | 0.680 | 76AH | 0.50 | 1.30 | — | 8.81 | 9.00 | B |
| | | ACSR | Merlin | 336.4 | 18/1 | 0.684 | | | | | | | |
| S5676.719D | S5176.719D | ACSR | Ostrich | 300 | 26/7 | 0.680 | 76AH | 0.50 | 3.00 | — | 7.33 | 9.00 | D |
| | | ACSR | Merlin | 336.4 | 18/1 | 0.684 | | | | | | | |
| S5620.781 | S5120.781 | ACSR | Linnet | 336.4 | 26/7 | 0.720 | 20AH | 0.50 | 1.30 | — | 10.50 | 8.50 | B |
| | | ACSR | Oriole | 336.4 | 30/7 | 0.741 | | | | | | | |
| | | ACSR | Chickadee | 397.5 | 18/1 | 0.743 | | | | | | | |
| S5620.781D | S5120.781D | ACSR | Linnet | 336.4 | 26/7 | 0.720 | 20AH | 0.50 | 3.00 | — | 7.61 | 8.50 | D |
| | | ACSR | Oriole | 336.4 | 30/7 | 0.741 | | | | | | | |
| | | ACSR | Chickadee | 397.5 | 18/1 | 0.743 | | | | | | | |
| S5676.781 | S5176.781 | ACSR | Linnet | 336.4 | 26/7 | 0.720 | 76AH | 0.50 | 1.30 | — | 8.81 | 9.00 | B |
| | | ACSR | Chickadee | 397.5 | 18/1 | 0.743 | | | | | | | |
| S5676.781D | S5176.781D | ACSR | Linnet | 336.4 | 26/7 | 0.720 | 76AH | 0.50 | 3.00 | — | 7.36 | 9.00 | D |
| | | ACSR | Chickadee | 397.5 | 18/1 | 0.743 | | | | | | | |
| S5676.750 | S5176.750 | AAC | Canna | 397.5 | 19 | 0.724 | 76AH | 0.50 | 1.30 | — | 8.81 | 9.00 | B |
| S5676.750D | S5176.750D | AAC | Canna | 397.5 | 19 | 0.724 | 76AH | 0.50 | 3.00 | — | 8.31 | 9.00 | D |
| S5620.812 | S5120.812 | ACSR | Brant | 397.5 | 24/7 | 0.772 | 20AH | 0.50 | 1.30 | — | 10.50 | 8.50 | B |
| | | AAC | Goldentuft | 450 | 19 | 0.770 | | | | | | | |
| | | AAC | Yarrow | 450 | 37 | 0.772 | | | | | | | |
| | | AAC | Cosmos | 477 | 19 | 0.793 | | | | | | | |
| | | AAC | Syringa | 477 | 37 | 0.795 | | | | | | | |
| S5620.812D | S5120.812D | ACSR | Brant | 397.5 | 24/7 | 0.772 | 20AH | 0.50 | 3.00 | — | 8.47 | 8.50 | D |
| | | AAC | Goldentuft | 450 | 19 | 0.770 | | | | | | | |
| | | AAC | Yarrow | 450 | 37 | 0.772 | | | | | | | |
| | | AAC | Cosmos | 477 | 19 | 0.793 | | | | | | | |
| | | AAC | Syringa | 477 | 37 | 0.795 | | | | | | | |
| S5620.844 | S5120.844 | ACSR | Ibis | 397.5 | 26/7 | 0.783 | 20AH | 0.50 | 1.30 | — | 10.50 | 8.50 | B |
| | | ACSR | Lark | 397.5 | 30/7 | 0.806 | | | | | | | |
| S5624.875 | S5124.875 | ACSR | Pelican | 477 | 18/1 | 0.814 | 24AH | 0.60 | 1.50 | — | 11.46 | 10.25 | B |
| | | AAC | Cosmos | 477 | 19 | 0.793 | | | | | | | |
| | | AAC | Syringa | 477 | 37 | 0.795 | | | | | | | |
| | | AAC | Zinnia | 500 | 19 | 0.811 | | | | | | | |
| | | AAC | Hyacinth | 500 | 37 | 0.813 | | | | | | | |
| S5624.875D | S5124.875D | ACSR | Pelican | 477 | 18/1 | 0.814 | 24AH | 0.50 | 3.00 | — | 8.78 | 10.25 | D |
| | | AAC | Cosmos | 477 | 19 | 0.793 | | | | | | | |
| | | AAC | Syringa | 477 | 37 | 0.795 | | | | | | | |
| | | AAC | Zinnia | 500 | 19 | 0.811 | | | | | | | |
| S5624.938 | S5124.938 | ACSR | Flicker | 477 | 24/7 | 0.846 | 24AH | 0.60 | 1.50 | — | 11.46 | 10.25 | B |
| | | ACSR | Hawk | 477 | 26/7 | 0.858 | | | | | | | |
| | | ACSR | Hen | 477 | 30/7 | 0.883 | | | | | | | |
| | | ACSR | Osprey | 556.5 | 18/1 | 0.879 | | | | | | | |
| | | AAC | Dahlia | 556.5 | 19 | 0.856 | | | | | | | |
| | | AAC | Mistletoe | 556.5 | 37 | 0.858 | | | | | | | |
| | | AAC | Meadowsweet | 600 | 37 | 0.891 | | | | | | | |

DOSSERT®

S5600 Series, S5100 Series (cont.)

Terminal Connectors

Ordering Information

| CATALOG NUMBER | | CONDUCTOR | | | | | DIE SIZE ALUMINUM HEX DIE | DIMENSIONS IN INCHES | | | | | PAD SIZE |
|----------------|------------|----------------|-------------|---------------|--------------------|-----------------------|---------------------------------|----------------------|------|------|-------|-------|-------------|
| STRAIGHT | 15 DEGREE | ACSR OR AAC | CODE WORD | SIZE KCMIL | STRANDING AL/ST | DIAMETER IN INCHES | | A | B | C | L | L1 | |
| S5624.938D | S5124.938D | ACSR | Flicker | 477 | 24/7 | 0.846 | 24AH | 0.50 | 3.00 | — | 9.25 | 10.25 | D |
| | | ACSR | Hawk | 477 | 26/7 | 0.858 | | | | | | | |
| | | ACSR | Hen | 477 | 30/7 | 0.883 | | | | | | | |
| | | ACSR | Osprey | 556.5 | 18/1 | 0.879 | | | | | | | |
| | | AAC | Dahlia | 556.5 | 19 | 0.856 | | | | | | | |
| | | AAC | Mistletoe | 556.5 | 37 | 0.858 | | | | | | | |
| S5624.969 | S5124.969 | AAC | Meadowsweet | 600 | 37 | 0.891 | 24AH | 0.60 | 1.50 | — | 11.46 | 10.25 | B |
| | | ACSR | Parakeet | 556.5 | 24/7 | 0.914 | | | | | | | |
| | | ACSR | Dove | 556.5 | 26/7 | 0.927 | | | | | | | |
| | | AAC | Orchid | 636 | 37 | 0.918 | | | | | | | |
| S5624.969D | S5124.969D | AAC | Heuchera | 650 | 37 | 0.928 | 24AH | 0.50 | 3.00 | — | 9.23 | 10.25 | D |
| | | ACSR | Parakeet | 556.5 | 24/7 | 0.914 | | | | | | | |
| | | ACSR | Dove | 556.5 | 26/7 | 0.927 | | | | | | | |
| | | AAC | Orchid | 636 | 37 | 0.918 | | | | | | | |
| S5624.969E | S5124.969E | AAC | Heuchera | 650 | 37 | 0.928 | 24AH | 0.50 | 4.00 | 4.00 | 9.83 | 10.25 | E |
| | | ACSR | Parakeet | 556.5 | 24/7 | 0.914 | | | | | | | |
| | | ACSR | Dove | 556.5 | 26/7 | 0.927 | | | | | | | |
| S5627.100 | S5127.100 | AAC | Heuchera | 650 | 37 | 0.928 | 27AH | 0.40 | 3.00 | — | 11.72 | 10.82 | D |
| | | ACSR | Parakeet | 556.5 | 30/7 | 0.953 | | | | | | | |
| | | ACSR | Peacock | 605 | 24/7 | 0.953 | | | | | | | |
| | | ACSR | Squab | 605 | 26/7 | 0.966 | | | | | | | |
| | | ACSR | Swift | 636 | 36/1 | 0.930 | | | | | | | |
| S5627.106 | S5127.106 | ACSR | Kingbird | 636 | 18/1 | 0.940 | 27AH | 0.40 | 3.00 | — | 11.72 | 10.82 | D |
| | | AAC | Flag | 700 | 61 | 0.964 | | | | | | | |
| | | ACSR | Teal | 605 | 30/19 | 0.994 | | | | | | | |
| | | ACSR | Rook | 636 | 24/7 | 0.977 | | | | | | | |
| | | ACSR | Grosbeak | 636 | 26/7 | 0.990 | | | | | | | |
| | | ACSR | Egret | 636 | 30/19 | 1.019 | | | | | | | |
| | | ACSR | Flamingo | 666.6 | 24/7 | 1.000 | | | | | | | |
| | | AAC | Violet | 715.5 | 37 | 0.974 | | | | | | | |
| | | AAC | Nasturtium | 715.5 | 61 | 0.975 | | | | | | | |
| S5627.106E | S5127.106E | AAC | Petunia | 750 | 37 | 0.997 | 27AH | 0.50 | 4.00 | 4.00 | 10.06 | 10.07 | E |
| | | AAC | Cattail | 750 | 61 | 0.998 | | | | | | | |
| | | ACSR | Teal | 605 | 30/19 | 0.994 | | | | | | | |
| | | ACSR | Rook | 636 | 24/7 | 0.977 | | | | | | | |
| | | ACSR | Grosbeak | 636 | 26/7 | 0.990 | | | | | | | |
| | | ACSR | Egret | 636 | 30/19 | 1.019 | | | | | | | |
| | | ACSR | Flamingo | 666.6 | 24/7 | 1.000 | | | | | | | |
| S5630.109 | S5130.109 | AAC | Nasturtium | 715.5 | 61 | 0.975 | 30AH | 0.50 | 3.00 | — | 12.50 | 11.27 | D |
| | | AAC | Petunia | 750 | 37 | 0.997 | | | | | | | |
| | | AAC | Cattail | 750 | 61 | 0.998 | | | | | | | |
| | | ACSR | Stilt | 715.5 | 24/7 | 1.036 | | | | | | | |
| | | ACSR | Starling | 715.5 | 26/7 | 1.051 | | | | | | | |
| | | ACSR | Coot | 795 | 36/1 | 1.040 | | | | | | | |
| | | AAC | Arbutus | 795 | 37 | 1.026 | | | | | | | |
| S5630.109E | S5130.109E | AAC | Lilac | 795 | 61 | 1.028 | 30AH | 0.50 | 4.00 | 4.00 | 9.74 | 9.67 | E |
| | | AAC | — | 800 | 37 | 1.031 | | | | | | | |
| | | AAC | Heliotrope | 800 | 61 | 1.031 | | | | | | | |
| | | ACSR | Stilt | 715.5 | 24/7 | 1.036 | | | | | | | |
| | | ACSR | Starling | 715.5 | 26/7 | 1.051 | | | | | | | |
| | | ACSR | Coot | 795 | 36/1 | 1.040 | | | | | | | |

DOSSERT®

S5600 Series, S5100 Series (cont.)

Terminal Connectors

Ordering Information

| CATALOG NUMBER | | CONDUCTOR | | | | | DIE SIZE ALUMINUM HEX DIE | DIMENSIONS IN INCHES | | | | | PAD SIZE |
|----------------|------------|----------------|------------|---------------|--------------------|-----------------------|---------------------------------|----------------------|------|------|-------|-------|-------------|
| STRAIGHT | 15 DEGREE | ACSR OR AAC | CODE WORD | SIZE KCMIL | STRANDING AL/ST | DIAMETER IN INCHES | | A | B | C | L | L1 | |
| S5630.109G | S5130.109G | ACSR | Stilt | 715.5 | 24/7 | 1.036 | 30AH | 0.50 | 6.00 | — | 13.75 | 13.75 | G |
| | | ACSR | Starling | 715.5 | 26/7 | 1.051 | | | | | | | |
| | | ACSR | Coot | 795 | 36/1 | 1.040 | | | | | | | |
| | | AAC | Arbutus | 795 | 37 | 1.026 | | | | | | | |
| | | AAC | Lilac | 795 | 61 | 1.028 | | | | | | | |
| | | AAC | — | 800 | 37 | 1.031 | | | | | | | |
| S5630.116 | S5130.116 | AAC | Heliotrope | 800 | 61 | 1.031 | 30AH | 0.50 | 3.00 | — | 12.50 | 11.27 | D |
| | | ACSR | Redwing | 715.5 | 30/19 | 1.081 | | | | | | | |
| | | ACSR | Tern | 795 | 45/7 | 1.063 | | | | | | | |
| | | ACSR | Condor | 795 | 54/7 | 1.093 | | | | | | | |
| | | ACSR | Drake | 795 | 26/7 | 1.108 | | | | | | | |
| | | ACSR | Cuckoo | 795 | 24/7 | 1.092 | | | | | | | |
| S5630.116B | S5130.116B | AAC | Snapdragon | 900 | 61 | 1.094 | 30AH | 0.69 | 1.75 | — | 12.50 | 12.75 | B |
| | | ACSR | Redwing | 715.5 | 30/19 | 1.081 | | | | | | | |
| | | ACSR | Tern | 795 | 45/7 | 1.063 | | | | | | | |
| | | ACSR | Condor | 795 | 54/7 | 1.093 | | | | | | | |
| | | ACSR | Drake | 795 | 26/7 | 1.108 | | | | | | | |
| | | ACSR | Cuckoo | 795 | 24/7 | 1.092 | | | | | | | |
| — | S5130.116E | AAC | Snapdragon | 900 | 61 | 1.094 | 30AH | 1.00 | 4.00 | 4.50 | — | 11.22 | E |
| | | ACSR | Redwing | 715.5 | 30/19 | 1.081 | | | | | | | |
| | | ACSR | Tern | 795 | 45/7 | 1.063 | | | | | | | |
| | | ACSR | Condor | 795 | 54/7 | 1.093 | | | | | | | |
| | | ACSR | Drake | 795 | 26/7 | 1.108 | | | | | | | |
| | | ACSR | Cuckoo | 795 | 24/7 | 1.092 | | | | | | | |
| S5630.122 | S5130.122 | AAC | Snapdragon | 900 | 61 | 1.094 | 30AH | 0.40 | 3.00 | — | 12.50 | 11.27 | D |
| | | ACSR | Mallard | 795 | 30/19 | 1.140 | | | | | | | |
| | | ACSR | Ruddy | 900 | 45/7 | 1.131 | | | | | | | |
| | | ACSR | Canary | 900 | 54/7 | 1.162 | | | | | | | |
| | | ACSR | Catbird | 954 | 36/1 | 1.140 | | | | | | | |
| | | ACSR | Rail | 954 | 45/7 | 1.165 | | | | | | | |
| | | AAC | Magnolia | 954 | 37 | 1.124 | | | | | | | |
| | | AAC | Goldenrod | 954 | 61 | 1.126 | | | | | | | |
| S5630.122E | — | AAC | Camellia | 1000 | 61 | 1.152 | 30AH | 0.50 | 4.00 | 4.00 | 10.05 | — | E |
| | | AAC | Bluebell | 1033.5 | 37 | 1.170 | | | | | | | |
| | | AAC | Larkspur | 1033.5 | 61 | 1.172 | | | | | | | |
| | | ACSR | Mallard | 795 | 30/19 | 1.140 | | | | | | | |
| | | ACSR | Ruddy | 900 | 45/7 | 1.131 | | | | | | | |
| | | ACSR | Canary | 900 | 54/7 | 1.162 | | | | | | | |
| | | ACSR | Catbird | 954 | 36/1 | 1.140 | | | | | | | |
| | | ACSR | Rail | 954 | 45/7 | 1.165 | | | | | | | |
| — | S5130.122E | AAC | Magnolia | 954 | 37 | 1.124 | 30AH | 1.00 | 4.00 | 4.50 | — | 11.27 | E |
| | | AAC | Goldenrod | 954 | 61 | 1.126 | | | | | | | |
| | | AAC | Camellia | 1000 | 61 | 1.152 | | | | | | | |
| | | AAC | Bluebell | 1033.5 | 37 | 1.170 | | | | | | | |
| | | AAC | Larkspur | 1033.5 | 61 | 1.172 | | | | | | | |
| | | ACSR | Mallard | 795 | 30/19 | 1.140 | | | | | | | |
| | | ACSR | Ruddy | 900 | 45/7 | 1.131 | | | | | | | |
| | | ACSR | Canary | 900 | 54/7 | 1.162 | | | | | | | |
| S5630.125 | S5130.125 | ACSR | Catbird | 954 | 36/1 | 1.140 | 30AH | 0.40 | 3.00 | — | 12.50 | 11.27 | B |
| | | ACSR | Cardinal | 954 | 54/7 | 1.196 | | | | | | | |
| S5630.125E | — | ACSR | Tanager | 1033.5 | 36/1 | 1.186 | 30AH | 0.50 | 4.00 | 4.00 | 10.03 | — | E |
| | | ACSR | Cardinal | 954 | 54/7 | 1.196 | | | | | | | |
| — | S5130.125E | ACSR | Tanager | 1033.5 | 36/1 | 1.186 | 30AH | 1.00 | 4.00 | 4.50 | — | 11.25 | E |
| | | ACSR | Cardinal | 954 | 54/7 | 1.196 | | | | | | | |
| S5634.128 | S5134.128 | ACSR | Ortolan | 1033.5 | 45/7 | 1.212 | 34AH | 0.60 | 3.00 | — | 12.20 | 12.44 | D |
| | | AAC | Marigold | 1113 | 61 | 1.216 | | | | | | | |

DOSSERT®

S5600 Series, S5100 Series (cont.)

Terminal Connectors

Ordering Information

| CATALOG NUMBER | | CONDUCTOR | | | | | DIE SIZE ALUMINUM HEX DIE | DIMENSIONS IN INCHES | | | | | PAD SIZE |
|----------------|------------|-------------|------------|------------|-----------------|--------------------|---------------------------|----------------------|------|------|-------|-------|----------|
| STRAIGHT | 15 DEGREE | ACSR OR AAC | CODE WORD | SIZE KCMIL | STRANDING AL/ST | DIAMETER IN INCHES | | A | B | C | L | L1 | |
| S5634.128 | S5134.128 | ACSR | Ortolan | 1033.5 | 45/7 | 1.212 | 34AH | 0.60 | 3.00 | — | 12.20 | 12.44 | D |
| | | AAC | Marigold | 1113 | 61 | 1.216 | | | | | | | |
| S5634.134 | S5134.134 | ACSR | Curlew | 1033.5 | 54/7 | 1.244 | 34AH | 0.60 | 3.00 | — | 12.20 | 12.44 | D |
| | | ACSR | Bluejay | 1113 | 45/7 | 1.259 | | | | | | | |
| | | AAC | Hawthorn | 1192.5 | 61 | 1.258 | | | | | | | |
| | | AAC | Narcissus | 1272 | 61 | 1.300 | | | | | | | |
| | | ACSR | Curlew | 1033.5 | 54/7 | 1.244 | | | | | | | |
| S5634.134E | S5134.134E | ACSR | Bluejay | 1113 | 45/7 | 1.259 | 34AH | 1.00 | 4.00 | 4.50 | 11.02 | 10.83 | E |
| | | AAC | Hawthorn | 1192.5 | 61 | 1.258 | | | | | | | |
| | | AAC | Narcissus | 1272 | 61 | 1.300 | | | | | | | |
| S5634.138 | S5134.138 | ACSR | Bunting | 1192.5 | 45/7 | 1.302 | 34AH | 0.60 | 3.00 | — | 12.20 | 12.44 | D |
| | | ACSR | Finch | 1113 | 54/19 | 1.293 | | | | | | | |
| | | ACSR | Bittern | 1272 | 45/7 | 1.345 | | | | | | | |
| S5636.144 | S5136.144 | ACSR | Grackle | 1192.5 | 54/19 | 1.333 | 36AH | 0.60 | 3.00 | — | 13.76 | 12.50 | D |
| | | AAC | Columbine | 1351 | 61 | 1.340 | | | | | | | |
| | | AAC | Carnation | 1431 | 61 | 1.379 | | | | | | | |
| S5636.144E | S5136.144E | ACSR | Bittern | 1272 | 45/7 | 1.345 | 36AH | 1.00 | 4.00 | 4.50 | 10.85 | 10.73 | E |
| | | ACSR | Grackle | 1192.5 | 54/19 | 1.333 | | | | | | | |
| | | AAC | Columbine | 1351 | 61 | 1.340 | | | | | | | |
| | | AAC | Carnation | 1431 | 61 | 1.379 | | | | | | | |
| S5636.147 | S5136.147 | ACSR | Pheasant | 1272 | 54/19 | 1.382 | 36AH | 0.60 | 3.00 | — | 13.76 | 12.50 | D |
| | | ACSR | Dipper | 1351.5 | 45/7 | 1.386 | | | | | | | |
| | | ACSR | — | 1500 | 91 | 1.412 | | | | | | | |
| | | AAC | Gladiolus | 1510.5 | 61 | 1.187 | | | | | | | |
| S5638.150 | S5138.150 | ACSR | Martin | 1351.5 | 54/19 | 1.424 | 38AH | 0.80 | 3.00 | — | 13.94 | 13.69 | D |
| | | ACSR | Bobolink | 1431 | 45/7 | 1.427 | | | | | | | |
| S5638.150E | S5138.150E | ACSR | Martin | 1351.5 | 54/19 | 1.424 | 38AH | 1.00 | 4.00 | 4.50 | 11.44 | 13.69 | E |
| | | ACSR | Bobolink | 1431 | 45/7 | 1.427 | | | | | | | |
| S5638.156 | S5138.156 | ACSR | Plover | 1431 | 54/19 | 1.465 | 38AH | 0.70 | 3.00 | — | 13.94 | 13.69 | D |
| | | ACSR | Nuthatch | 1510.5 | 45/7 | 1.466 | | | | | | | |
| | | AAC | Coreopsis | 1590 | 61 | 1.250 | | | | | | | |
| | | AAC | Dogwood | 1590 | 91 | 1.454 | | | | | | | |
| S5638.156E | S5138.156E | ACSR | Plover | 1431 | 54/19 | 1.465 | 38AH | 1.00 | 4.00 | 4.50 | 11.41 | 14.69 | E |
| | | ACSR | Nuthatch | 1510.5 | 45/7 | 1.466 | | | | | | | |
| | | AAC | Coreopsis | 1590 | 61 | 1.250 | | | | | | | |
| | | AAC | Dogwood | 1590 | 91 | 1.454 | | | | | | | |
| S5640.162 | S5140.162 | ACSR | Parrot | 1510.5 | 54/19 | 1.506 | 40AH | 0.70 | 4.00 | 4.50 | 15.58 | 14.88 | E |
| | | ACSR | Lapwing | 1590 | 45/7 | 1.504 | | | | | | | |
| | | ACSR | Falcon | 1590 | 54/19 | 1.545 | | | | | | | |
| | | AAC | Jessamine | 1750 | 61 | 1.525 | | | | | | | |
| S5640.162E | S5140.162E | ACSR | Parrot | 1510.5 | 54/19 | 1.506 | 40AH | 1.00 | 4.00 | 4.50 | 11.83 | 11.92 | E |
| | | ACSR | Lapwing | 1590 | 45/7 | 1.504 | | | | | | | |
| | | ACSR | Falcon | 1590 | 54/19 | 1.545 | | | | | | | |
| | | AAC | Jessamine | 1750 | 61 | 1.525 | | | | | | | |
| S5642.178 | S5142.178 | ACSR | Chukar | 1780 | 84/19 | 1.602 | 42AH | 0.66 | 4.00 | 4.50 | 15.91 | 15.50 | E |
| | | ACSR | — | 2034 | 72/7 | 1.681 | | | | | | | |
| | | AAC | Cowslip | 2000 | 91 | 1.630 | | | | | | | |
| S5644.181 | S5144.181 | ACSR | Kiwi | 2167 | 72/7 | 1.737 | 44AH | 0.70 | 4.00 | 4.50 | 17.84 | 16.00 | E |
| | | AAC | Sagebrush | 2250 | 91 | 1.729 | | | | | | | |
| | | AAC | — | 2300 | 61 | 1.750 | | | | | | | |
| | | AAC | — | 2300 | 91 | 1.750 | | | | | | | |
| S5644.184 | S5144.184 | ACSR | Bluebird | 2156 | 84/19 | 1.762 | 44AH | 0.70 | 4.00 | 4.50 | 17.84 | 16.00 | E |
| S5644.188 | S5144.188 | ACSR | Thrasher | 2312 | 76/19 | 1.802 | 44AH | 0.72 | 4.00 | 4.50 | 17.84 | 16.00 | E |
| | | ACSR | Lupine | 2500 | 91 | 1.823 | | | | | | | |
| S5648.197 | S5148.197 | ACSR | Joree | 2515 | 76/19 | 1.880 | 48AH | 0.80 | 4.00 | 4.50 | 18.72 | 17.31 | E |
| | | AAC | Bitterroot | 2750 | 91 | 1.912 | | | | | | | |