

DOSSERT® TYPE BM SERIES Bi-Metal Transition Plate

The transition plate is for connecting copper and aluminum terminals together.

Material

Copper Clad Aluminum

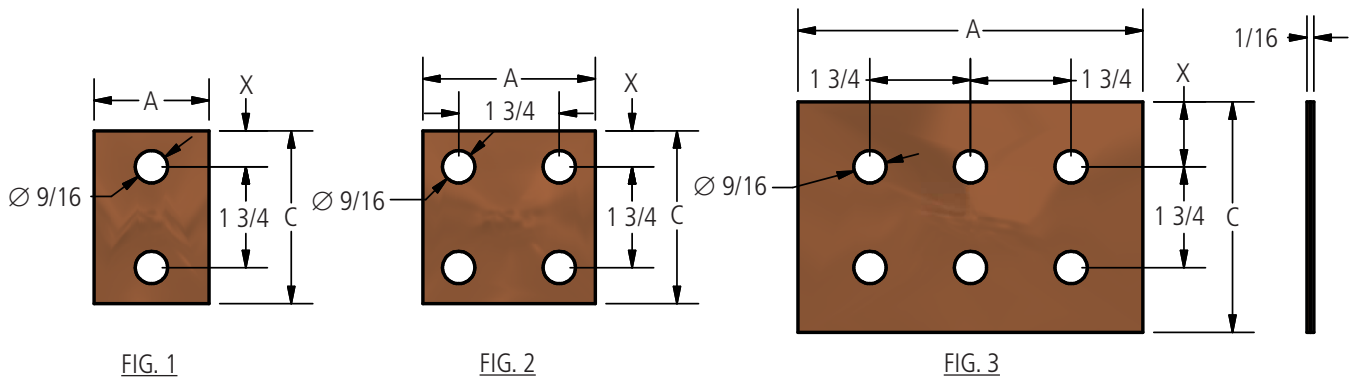
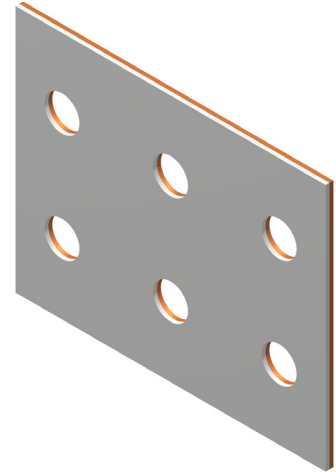

Ordering Information

CATALOG NUMBER	FIGURE NUMBER	DIMENSIONS IN INCHES		
		A	C	X
BM1 1/2N	1	1 1/2	3	5/8
BM2N	1	2	3	5/8
BM 2 3/4 X 5 1/4-2N	1	2 3/4	5 1/4	3/4
BM4N	2	3	3	5/8
BM4N4	2	4	4	1 1/8
BM5N4	3	5	4	1 1/8
BM6N4	3	6	4	1 1/8