

DOSSERT®

TYPE CFTV-S

Tee Connector For Cable To Flat Bar Tap

A cable run to flat bar tap tee connector.

Material

Copper Alloy

Hardware

Everdur-bolts, nuts, and lockwashers.

Note

For a tin plated finish add suffix "-SN" to end of catalog number.

Ex: CFTV60-2N-S-SN

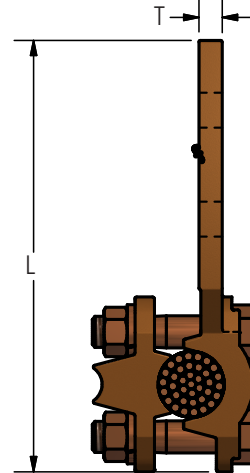
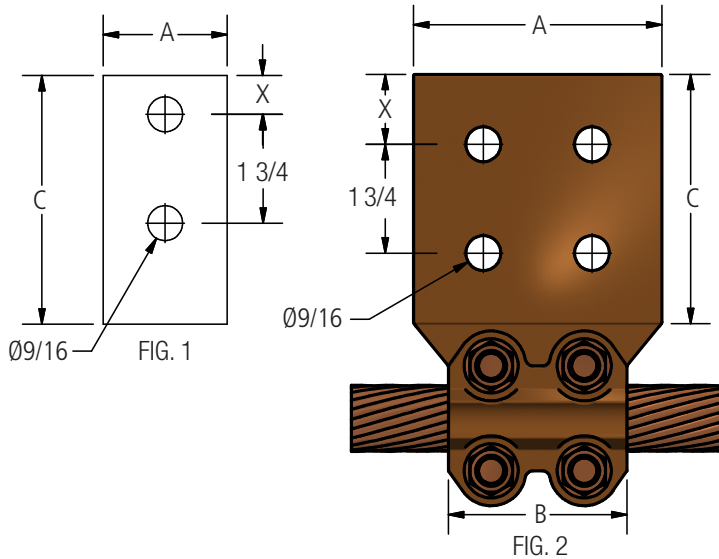
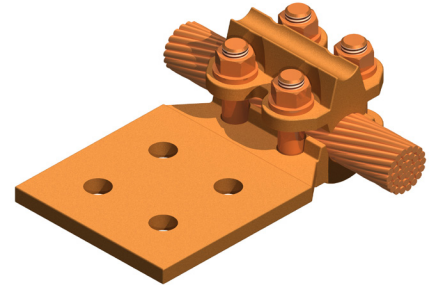

Ordering Information

CATALOG NUMBER	CABLE RANGE				FIG. NUM.	DIMENSIONS IN INCHES						BOLT SIZE
	SMALL GROOVE		LARGE GROOVE			A	B	C	L	T	X	
	MIN	MAX	MIN	MAX								
CFTV60-2N-S	4 SOL	3/0 STR	4/0 STR	600 MCM	1	2	2 1/2	3	5 1/2	3/8	5/8	3/8
CFTV60-4N-S	4 SOL	3/0 STR	4/0 STR	600 MCM	2	3	2 1/2	3	5 1/2	3/8	5/8	3/8
CFTV80-2N-S	2/0 SOL	300 MCM	350 MCM	800 MCM	1	2	2 7/8	3	6 1/4	3/8	5/8	1/2
CFTV80-4N-S	2/0 SOL	300 MCM	350 MCM	800 MCM	2	3	2 7/8	3	6 1/4	3/8	5/8	1/2
CFTV80-4N4-S	2/0 SOL	300 MCM	350 MCM	800 MCM	2	4	2 7/8	4	7 1/4	3/8	1 1/8	1/2
CFTV85-2N-S	6 SOL	300 MCM	350 MCM	850 MCM	1	2	2 7/8	3	5 15/16	3/8	5/8	1/2
CFTV85-4N-S	6 SOL	300 MCM	350 MCM	850 MCM	2	3	2 7/8	3	5 15/16	3/8	5/8	1/2
CFTV85-4N4-S	6 SOL	300 MCM	350 MCM	850 MCM	2	4	2 7/8	4	6 15/16	3/8	1 1/8	1/2
CFTV100-2N-S	4/0 SOL	400 MCM	450 MCM	1000 MCM	1	2	2 7/8	3	6	1/2	5/8	1/2
CFTV100-4N-S	4/0 SOL	400 MCM	450 MCM	1000 MCM	2	3	2 7/8	3	6	1/2	5/8	1/2
CFTV100-4N4-S	4/0 SOL	400 MCM	450 MCM	1000 MCM	2	4	2 7/8	4	7	1/2	1 1/8	1/2
CFTV150-2N-S	250 MCM	750 MCM	800 MCM	1500 MCM	1	2	3 3/8	3	6 1/4	1/2	5/8	1/2
CFTV150-4N-S	250 MCM	750 MCM	800 MCM	1500 MCM	2	3	3 3/8	3	6 1/4	1/2	5/8	1/2
CFTV150-4N4-S	250 MCM	750 MCM	800 MCM	1500 MCM	2	4	3 3/8	4	7 1/4	1/2	1 1/8	1/2
CFTV200-4N-S	500 MCM	900 MCM	1000 MCM	2000 MCM	2	3	3 3/8	3	6 1/2	11/16	5/8	1/2
CFTV200-4N4-S	500 MCM	900 MCM	1000 MCM	2000 MCM	2	4	3 3/8	4	7 1/2	11/16	1 1/8	1/2