

DOSSERT®

TYPE HL, H2L, H3L, H4L

Copper Set Screw Terminal. HL is a single conductor Herculon Connector, H2L is a two conductor HERCULON™ Connector, H3L is a three conductor Herculon Connector, and H4L is a four conductor Herculon Connector. HL-A has a set screw instead of the hex bolt.

The HERCULON™ Lug is designed for quick and efficient installation. Its compact rigid structure makes it especially adaptable for assembly in inaccessible quarters. A high compressive clamping force on the cable conductors plus the additional gripping action of special serrated bearing areas makes for high electrical contact efficiency and pull out strength.

Material

Copper Alloy

Hardware

Everdur pressure bolt

Notes

- For a 2 conductor, 4N NEMA pad, and 750 MCM cable order H2L75-4N
- For a 3 conductor, 4N NEMA pad, 750 MCM cable, and cap screw order H3L75-4NA
- For a 4 conductor, 4N NEMA pad, and 750 MCM cable order H4L75-4N
- For angled terminals add angle to end of catalog number. Example: H4L1-1-45

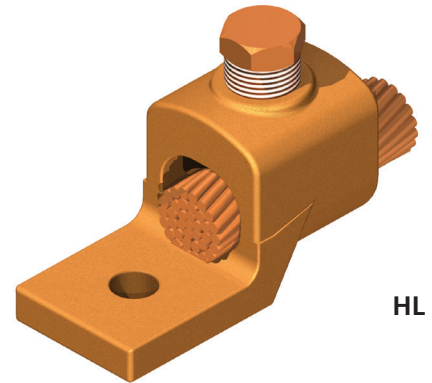

HL

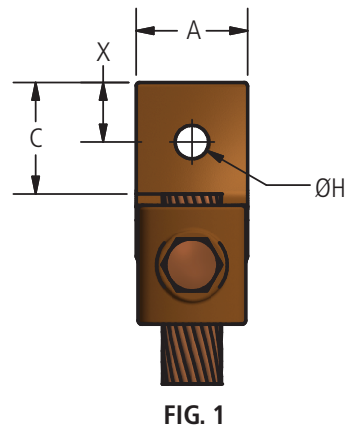
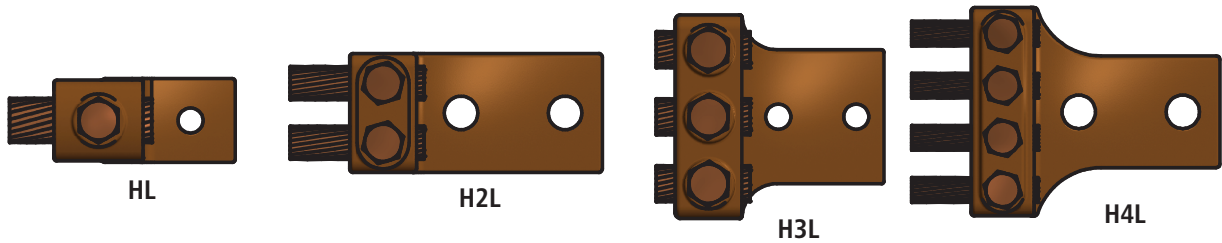

FIG. 1

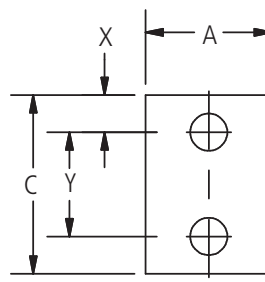
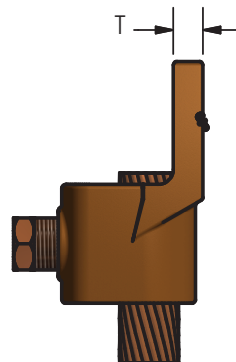

FIG. 2

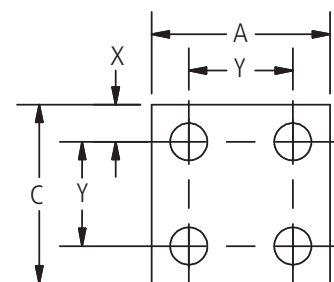

FIG. 3

DOSSERT®

TYPE HL, H2L, H3L, H4L

Copper Set Screw Terminal. HL is a single conductor Herculon Connector, H2L is a two conductor HERCULON™ Connector, H3L is a three conductor Herculon Connector, and H4L is a four conductor Herculon Connector. HL-A has a set screw instead of the hex bolt.

Ordering Information

CATALOG NUMBER				COMMERCIAL CABLE SIZE		NAVY CABLE SIZE		FIG. NO.	DIMENSIONS IN INCHES					
ONE CABLE	TWO CABLES	THREE CABLES	FOUR CABLES	MIN	MAX	MIN	MAX		A	C	H	X	Y	T
HL1-1	H2L1-1	H3L1-1	H4L1-1	14 SOL	8 STR	4	14	1	1/2	5/8	7/32	5/16	-	3/16
HL1-2	H2L1-2	H3L1-2	H4L1-2	14 SOL	8 STR	4	14	2	1/2	1 1/4	7/32	5/16	5/8	3/16
HL4-1	H2L4-1	H3L4-1	H4L4-1	8 SOL	4 STR	23	40	1	1/2	5/8	9/32	5/16	-	3/16
HL4-2	H2L4-2	H3L4-2	H4L4-2	8 SOL	4 STR	23	40	2	1/2	1 1/4	9/32	5/16	5/8	3/16
HL8-1	H2L8-1	H3L8-1	H4L8-1	4 SOL	1 STR	50	75	1	11/16	11/16	9/32	11/32	-	7/32
HL8-2	H2L8-2	H3L8-2	H4L8-2	4 SOL	1 STR	50	75	2	11/16	1 3/8	9/32	5/16	3/4	7/32
HL13-1	H2L13-1	H3L13-1	H4L13-1	1 STR	2/0 STR	100	125	1	13/16	7/8	7/16	7/16	-	7/32
HL13-2	H2L13-2	H3L13-2	H4L13-2	1 STR	2/0 STR	100	125	2	13/16	1 3/4	11/32	3/8	1	7/32
HL21-1	H2L21-1	H3L21-1	H4L21-1	2/0 STR	4/0 STR	150	200	1	1	1	7/16	1/2	-	1/4
HL21-2	H2L21-2	H3L21-2	H4L21-2	2/0 STR	4/0 STR	150	200	2	1	1 3/4	7/16	3/8	1	1/4
HL21-2N	H2L21-2N	H3L21-2N	H4L21-2N	2/0 STR	4/0 STR	150	200	2	1	3	9/16	5/8	1 3/4	1/4
HL30-1	H2L30-1	H3L30-1	H4L30-1	4/0 STR	300 MCM	250	300	1	1 1/16	1 1/4	9/16	5/8	-	5/16
HL30-2	H2L30-2	H3L30-2	H4L30-2	4/0 STR	300 MCM	250	300	2	1 1/16	2	7/16	7/16	1	5/16
HL30-2N	H2L30-2N	H3L30-2N	H4L30-2N	4/0 STR	300 MCM	250	300	2	1 1/16	3	9/16	5/8	1 3/4	5/16
HL35-1	H2L35-1	H3L35-1	H4L35-1	250 MCM	350 MCM	250	350	1	1 1/8	1 1/4	9/16	5/8	-	5/16
HL35-2	H2L35-2	H3L35-2	H4L35-2	250 MCM	350 MCM	250	350	2	1 1/8	2	7/16	7/16	1	5/16
HL35-2N	H2L35-2N	H3L35-2N	H4L35-2N	250 MCM	350 MCM	250	350	2	1 1/8	3	9/16	5/8	1 3/4	5/16
HL50-1	H2L50-1	H3L50-1	H4L50-1	300 MCM	500 MCM	400	500	1	1 3/8	1 3/8	9/16	11/16	-	11/32
HL50-2	H2L50-2	H3L50-2	H4L50-2	300 MCM	500 MCM	400	500	2	1 3/8	2	7/16	7/16	1	11/32
HL50-2N	H2L50-2N	H3L50-2N	H4L50-2N	300 MCM	500 MCM	400	500	2	1 3/8	3	9/16	5/8	1 3/4	11/32
HL50-4	H2L50-4	H3L50-4	H4L50-4	300 MCM	500 MCM	400	500	3	2	2	7/16	7/16	1	11/32
HL50-4N	H2L50-4N	H3L50-4N	H4L50-4N	300 MCM	500 MCM	400	500	3	3	3	9/16	5/8	1 3/4	11/32
HL75-1	H2L75-1	H3L75-1	H4L75-1	500 MCM	750 MCM	500	750	1	1 5/8	1 3/4	11/16	7/8	-	3/8
HL75-2	H2L75-2	H3L75-2	H4L75-2	500 MCM	750 MCM	500	750	2	1 5/8	2 1/4	9/16	9/16	1 1/8	3/8
HL75-2N	H2L75-2N	H3L75-2N	H4L75-2N	500 MCM	750 MCM	500	750	2	1 5/8	3	9/16	5/8	1 3/4	3/8
HL75-4	H2L75-4	H3L75-4	H4L75-4	500 MCM	750 MCM	500	750	3	2 1/4	2 1/4	7/16	5/8	1	3/8
HL75-4N	H2L75-4N	H3L75-4N	H4L75-4N	500 MCM	750 MCM	500	750	3	3	3	9/16	5/8	1 3/4	3/8
HL100-1	H2L100-1	H3L100-1	H4L100-1	750 MCM	1000 MCM	800	1000	1	1 7/8	1 7/8	11/16	15/16	-	1/2
HL100-2	H2L100-2	H3L100-2	H4L100-2	750 MCM	1000 MCM	800	1000	2	1 7/8	2 1/2	9/16	5/8	1 1/4	1/2
HL100-2N	H2L100-2N	H3L100-2N	H4L100-2N	750 MCM	1000 MCM	800	1000	2	1 7/8	3	9/16	5/8	1 3/4	1/2
HL100-4	H2L100-4	H3L100-4	H4L100-4	750 MCM	1000 MCM	800	1000	3	2 1/2	2 1/2	7/16	5/8	1 1/4	1/2
HL100-4N	H2L100-4N	H3L100-4N	H4L100-4N	750 MCM	1000 MCM	800	1000	3	3	3	9/16	5/8	1 3/4	1/2
HL150-1	H2L150-1	H3L150-1	H4L150-1	1000 MCM	1500 MCM	1300	1300	1	2 3/16	2 1/8	13/16	1 1/16	-	9/16
HL150-2	H2L150-2	H3L150-2	H4L150-2	1000 MCM	1500 MCM	1300	1300	2	2 3/16	2 5/8	9/16	5/8	1 3/8	9/16
HL150-2N	H2L150-2N	H3L150-2N	H4L150-2N	1000 MCM	1500 MCM	1300	1300	2	2 3/16	3	9/16	5/8	1 3/4	9/16
HL150-4	H2L150-4	H3L150-4	H4L150-4	1000 MCM	1500 MCM	1300	1300	3	2 1/2	2 5/8	9/16	5/8	1 3/8	1/2
HL150-4N	H2L150-4N	H3L150-4N	H4L150-4N	1000 MCM	1500 MCM	1300	1300	3	3	3	9/16	5/8	1 3/4	1/2
HL200-1	H2L200-1	H3L200-1	H4L200-1	1600 MCM	2000 MCM	1600	2000	1	2 1/2	2 3/8	13/16	13/16	-	5/8
HL200-2	H2L200-2	H3L200-2	H4L200-2	1600 MCM	2000 MCM	1600	2000	2	2 1/2	2 3/4	9/16	5/8	1 1/2	5/8
HL200-2N	H2L200-2N	H3L200-2N	H4L200-2N	1600 MCM	2000 MCM	1600	2000	2	2 1/2	3	9/16	5/8	1 3/4	5/8
HL200-4	H2L200-4	H3L200-4	H4L200-4	1600 MCM	2000 MCM	1600	2000	3	2 5/8	2 3/4	9/16	5/8	1 1/2	5/8
HL200-4N	H2L200-4N	H3L200-4N	H4L200-4N	1600 MCM	2000 MCM	1600	2000	3	3	3	9/16	5/8	1 3/4	5/8

Bronze Terminals, Taps