

DOSSERT®

TYPE TCVH, TCVHA-15, TCVHA-30, TCVHA-45, TCVHA-90 Heavy Duty Copper Terminal For Cable to a Flat Pad

A heavy duty variable clamp type terminal for connecting a cable to a flat bar bus. Each size terminal accommodates a wide range of cable sizes. Designed to carry the full rated load of the maximum conductor without overheating. Contact pads other than those listed below can be promptly furnished to any specified size or drilling.

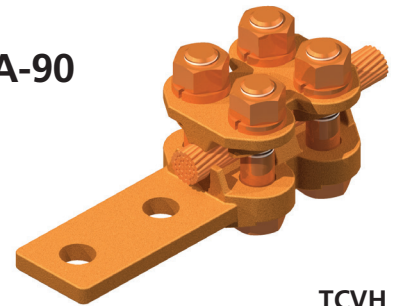

TCVH

Material

Copper Alloy

Hardware

Everdur bolts, nuts and lock washers.

Notes

- For Electro Tin plate, add "-SN" to catalog number. Ex: TCVH50-2N-SN
- For Angled Pad, add "A" to prefix and angle to catalog number. EX: TCVHA50-45
- For Undrilled Pad, add "-U" to pad size in catalog number. Ex: TCVH50-4N4U

Bronze Terminals, Taps

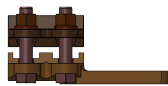

TCVH

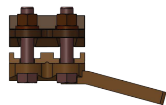

TCVHA-15

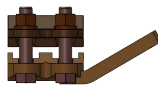

TCVHA-30



TCVHA-45

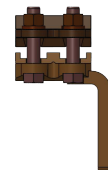

TCVHA-90

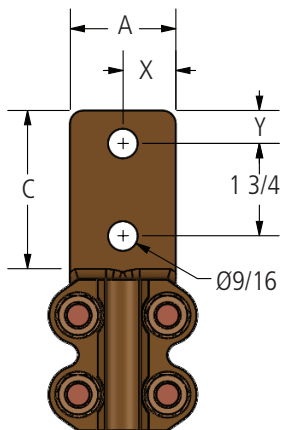

FIG. 1

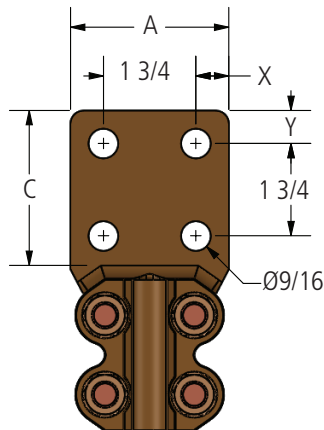

FIG. 2

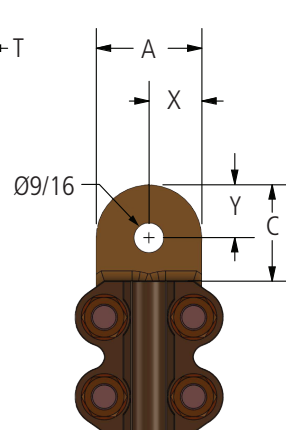
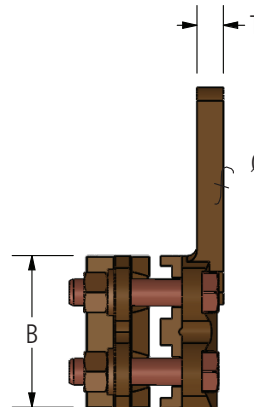

FIG. 3

DOSSERT®

TYPE TCVH, TCVHA-15, TCVHA-30, TCVHA-45, TCVHA-90 Heavy Duty Copper Terminal For Cable to a Flat Pad

Ordering Information

CATALOG NUMBER					CABLE RANGE		FIG. NO.	DIMENSIONS IN INCHES						BOLT SIZE
STRAIGHT	15 DEG.	30 DEG.	45 DEG.	90 DEG.	MIN	MAX		A	B	C	T	X	Y	
TCVH25-1	TCVHA25-1-15	TCVHA25-1-30	TCVHA25-1-45	TCVHA25-1-90	#4 SOL.	250 MCM	3	1.50	2.75	1.38	0.31	0.75	0.75	1/2
TCVH25-2N	TCVHA25-2N-15	TCVHA25-2N-30	TCVHA25-2N-45	TCVHA25-2N-90	#4 SOL.	250 MCM	1	1.50	2.75	3.00	0.31	0.75	0.63	1/2
TCVH25-4N	TCVHA25-4N-15	TCVHA25-4N-30	TCVHA25-4N-45	TCVHA25-4N-90	#4 SOL.	250 MCM	2	3.00	2.75	3.00	0.31	0.63	0.63	1/2
TCVH25-4N4	TCVHA25-4N4-15	TCVHA25-4N4-30	TCVHA25-4N4-45	TCVHA25-4N4-90	#4 SOL.	250 MCM	2	4.00	2.75	4.00	0.31	1.13	1.13	1/2
TCVH50-1	TCVHA50-1-15	TCVHA50-1-30	TCVHA50-1-45	TCVHA50-1-90	1/0 SOL.	500 MCM	3	2.00	2.63	1.50	0.38	1.00	0.88	1/2
TCVH50-2N	TCVHA50-2N-15	TCVHA50-2N-30	TCVHA50-2N-45	TCVHA50-2N-90	1/0 SOL.	500 MCM	1	2.00	2.63	3.00	0.38	1.00	0.63	1/2
TCVH50-2N3	TCVHA50-2N3-15	TCVHA50-2N3-30	TCVHA50-2N3-45	TCVHA50-2N3-90	1/0 SOL.	500 MCM	1	2.00	2.63	3.00	0.38	1.00	0.63	1/2
TCVH50-4N	TCVHA50-4N-15	TCVHA50-4N-30	TCVHA50-4N-45	TCVHA50-4N-90	1/0 SOL.	500 MCM	2	3.00	2.63	3.00	0.38	0.63	0.63	1/2
TCVH50-4N4	TCVHA50-4N4-15	TCVHA50-4N4-30	TCVHA50-4N4-45	TCVHA50-4N4-90	1/0 SOL.	500 MCM	2	4.00	2.63	4.00	0.38	1.13	1.13	1/2
TCVH80-2N	TCVHA80-2N-15	TCVHA80-2N-30	TCVHA80-2N-45	TCVHA80-2N-90	2/0 SOL.	800 MCM	1	2.00	2.88	3.00	0.50	1.00	0.63	1/2
TCVH80-2N3	TCVHA80-2N3-15	TCVHA80-2N3-30	TCVHA80-2N3-45	TCVHA80-2N3-90	2/0 SOL.	800 MCM	1	2.00	2.88	3.00	0.50	1.00	0.63	1/2
TCVH80-4N	TCVHA80-4N-15	TCVHA80-4N-30	TCVHA80-4N-45	TCVHA80-4N-90	2/0 SOL.	800 MCM	2	3.00	2.88	3.00	0.50	0.63	0.63	1/2
TCVH80-4N4	TCVHA80-4N4-15	TCVHA80-4N4-30	TCVHA80-4N4-45	TCVHA80-4N4-90	2/0 SOL.	800 MCM	2	4.00	2.88	4.00	0.50	1.13	1.13	1/2
TCVH100-2N	TCVHA100-2N-15	TCVHA100-2N-30	TCVHA100-2N-45	TCVHA100-2N-90	4/0 SOL.	1000 MCM	1	2.00	2.88	3.00	0.50	1.00	0.63	1/2
TCVH100-4N	TCVHA100-4N-15	TCVHA100-4N-30	TCVHA100-4N-45	TCVHA100-4N-90	4/0 SOL.	1000 MCM	2	3.00	2.88	3.00	0.50	0.63	0.63	1/2
TCVH100-4N4	TCVHA100-4N4-15	TCVHA100-4N4-30	TCVHA100-4N4-45	TCVHA100-4N4-90	4/0 SOL.	1000 MCM	2	4.00	2.88	4.00	0.50	1.13	1.13	1/2
TCVH200-4N	TCVHA200-4N-15	TCVHA200-4N-30	TCVHA200-4N-45	TCVHA200-4N-90	500 MCM	2000 MCM	2	3.00	3.38	3.00	0.69	0.63	0.63	1/2
TCVH200-4N4	TCVHA200-4N4-15	TCVHA200-4N4-30	TCVHA200-4N4-45	TCVHA200-4N4-90	500 MCM	2000 MCM	2	4.00	3.38	4.00	0.69	1.13	1.13	1/2
TCVH250-4N	TCVHA250-4N-15	TCVHA250-4N-30	TCVHA250-4N-45	TCVHA250-4N-90	2000 MCM	2500 MCM	2	3.00	4.50	3.00	0.81	0.63	0.63	5/8