

DOSSERT® TYPE ULI, UULI Copper U-Bolt Variable Range Terminal

A single and double U-bolt type terminal. Each size accommodates a wide range of cable sizes. The inverted clamping member and the offset pad provides for contact mounting clearance when required.

Material

High Conductivity Copper Alloy

Hardware

Everdur U-bolts, nuts and lockwashers.

Note

Contact pads can be furnished to any specification of size undrilled or drilled to specified hole sizes and center to center dimensions.

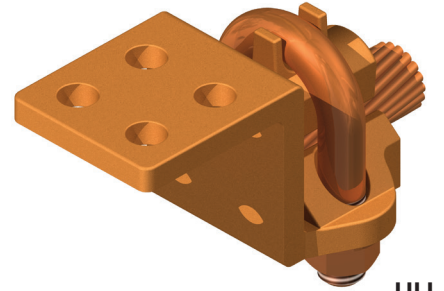

ULI

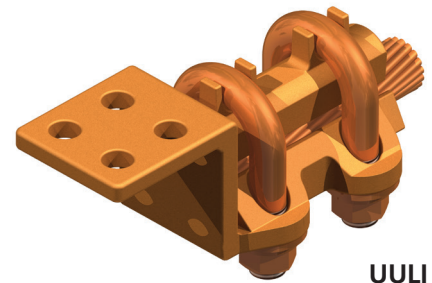

UULI

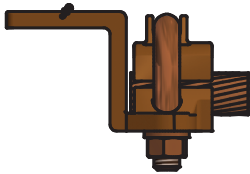

ULI

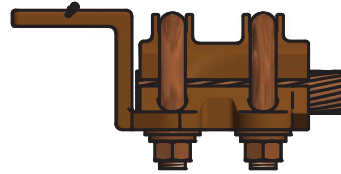

UULI

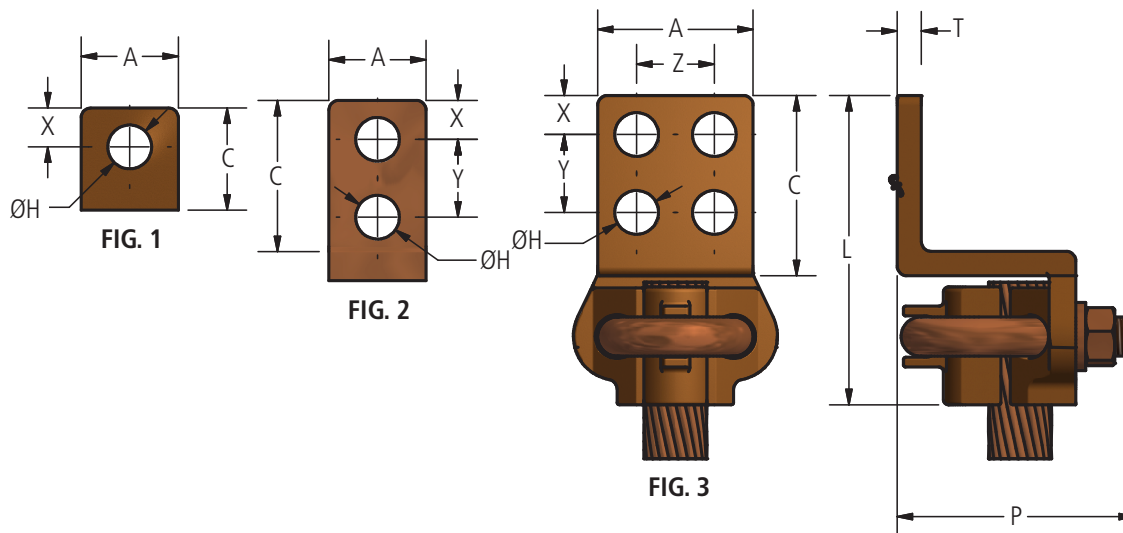

DOSSERT®

TYPE ULI, UULI Copper U-Bolt Variable Range Terminal

Ordering Information

CATALOG NUMBER		CABLE RANGE		FIG. NO.	DIMENSIONS IN INCHES										U-BOLT SIZE
ULI	UULI	MIN	MAX		A	C	H	L	P	T	X	Y	Z		
ULI13-1	UULI13-1	6 SOL	2/0 STR	1	1 1/4	1 1/4	7/16	3	2 1/16	5/16	5/8	-	-	5/16	
ULI13-2	UULI13-2	6 SOL	2/0 STR	2	1 1/4	1 7/8	7/16	3 5/8	2 1/16	5/16	7/16	1	-	5/16	
ULI13-2N	UULI13-2N	6 SOL	2/0 STR	2	1 1/2	3	9/16	4 3/4	2 1/16	5/16	5/8	1 3/4	-	5/16	
ULI13-4	UULI13-4	6 SOL	2/0 STR	3	2	2	7/16	3 3/4	2 1/16	5/16	1/2	1	1	5/16	
ULI13-4N	UULI13-4N	6 SOL	2/0 STR	3	3	3	9/16	4 3/4	2 1/16	5/16	5/8	1 3/4	1 3/4	5/16	
ULI21-1	UULI21-1	1 SOL	4/0 STR	1	1 1/2	1 1/2	9/16	3 5/16	2 3/16	5/16	3/4	-	-	3/8	
ULI21-2	UULI21-2	1 SOL	4/0 STR	2	1 1/4	2 1/8	7/16	3 15/16	2 3/16	5/16	1/2	1 1/8	-	3/8	
ULI21-2N	UULI21-2N	1 SOL	4/0 STR	2	1 1/2	3	9/16	4 13/16	2 3/16	5/16	5/8	1 3/4	-	3/8	
ULI21-4	UULI21-4	1 SOL	4/0 STR	3	2	2	7/16	3 13/16	2 3/16	5/16	1/2	1	1	3/8	
ULI21-4N	UULI21-4N	1 SOL	4/0 STR	3	3	3	9/16	4 13/16	2 3/16	5/16	5/8	1 3/4	1 3/4	3/8	
ULI30-1	UULI30-1	1/0 STR	300 MCM	1	1 7/8	1 7/8	9/16	3 3/4	2 5/16	3/8	15/16	-	-	3/8	
ULI30-2	UULI30-2	1/0 STR	300 MCM	2	1 5/8	2 5/8	9/16	4 1/2	2 5/16	3/8	5/8	1 1/8	-	3/8	
ULI30-2N	UULI30-2N	1/0 STR	300 MCM	2	1 1/2	3	9/16	4 7/8	2 5/16	3/8	5/8	1 3/4	-	1/2	
ULI30-4	UULI30-4	1/0 STR	300 MCM	3	2	2	7/16	3 7/8	2 5/16	3/8	1/2	1	1	3/8	
ULI30-4N	UULI30-4N	1/0 STR	300 MCM	3	3	3	9/16	4 7/8	2 5/16	3/8	5/8	1 3/4	1 3/4	1/2	
ULI50-1	UULI50-1	300 MCM	500 MCM	1	2 1/8	2 1/8	9/16	4 1/8	2 7/8	3/8	1 1/16	-	-	3/8	
ULI50-2	UULI50-2	300 MCM	500 MCM	2	1 3/4	2 3/4	9/16	4 7/8	2 7/8	3/8	1 1/16	1 3/8	-	3/8	
ULI50-2N	UULI50-2N	300 MCM	500 MCM	2	1 1/2	3	9/16	5 1/8	2 7/8	3/8	5/8	1 3/4	-	1/2	
ULI50-4	UULI50-4	300 MCM	500 MCM	3	2 1/4	2 1/4	7/16	4 3/8	2 7/8	3/8	9/16	1 1/8	1 1/8	3/8	
ULI50-4N	UULI50-4N	300 MCM	500 MCM	3	3	3	9/16	5 1/8	2 7/8	3/8	5/8	1 3/4	1 3/4	1/2	
ULI80-1	UULI80-1	500 MCM	800 MCM	1	2 3/8	2 3/4	9/16	4 5/8	3 3/8	1/2	1 1/16	-	-	1/2	
ULI80-2	UULI80-2	500 MCM	800 MCM	2	1 3/4	3	9/16	5 1/4	3 3/8	1/2	3/4	1 1/8	-	1/2	
ULI80-2N	UULI80-2N	500 MCM	800 MCM	2	1 3/4	3	9/16	5 1/4	3 3/8	1/2	5/8	1 3/4	-	1/2	
ULI80-4	UULI80-4	500 MCM	800 MCM	3	2 1/4	2 1/4	7/16	4 1/2	3 3/8	1/2	9/16	1 1/8	1 1/8	1/2	
ULI80-4N	UULI80-4N	500 MCM	800 MCM	3	3	3	9/16	5 1/4	3 3/8	1/2	5/8	1 3/4	1 3/4	1/2	
ULI100-1	UULI100-1	750 MCM	1000 MCM	1	2 1/2	2 1/2	9/16	4 7/8	3 1/2	1/2	1 1/4	-	-	1/2	
ULI100-2	UULI100-2	750 MCM	1000 MCM	2	2	3 1/8	9/16	5 1/2	3 1/2	1/2	3/4	1 5/8	-	1/2	
ULI100-2N	UULI100-2N	750 MCM	1000 MCM	2	2	3	9/16	5 3/8	3 1/2	1/2	5/8	1 3/4	-	1/2	
ULI100-4	UULI100-4	750 MCM	1000 MCM	3	2 3/8	2 3/8	7/16	4 3/4	3 1/2	1/2	9/16	1 1/4	1 1/4	1/2	
ULI100-4N	UULI100-4N	750 MCM	1000 MCM	3	3	3	9/16	5 3/8	3 1/2	1/2	5/8	1 3/4	1 3/4	1/2	
ULI150-1	UULI150-1	1000 MCM	1500 MCM	1	2 3/4	2 3/4	9/16	5 1/2	3 3/4	9/16	1 3/8	-	-	1/2	
ULI150-2	UULI150-2	1000 MCM	1500 MCM	2	2	3 1/8	9/16	5 3/4	3 3/4	9/16	3/4	1 5/8	-	1/2	
ULI150-2N	UULI150-2N	1000 MCM	1500 MCM	2	2	3	9/16	5 5/8	3 3/4	9/16	5/8	1 3/4	-	1/2	
ULI150-4	UULI150-4	1000 MCM	1500 MCM	3	2 3/4	2 3/4	9/16	5 3/8	3 3/4	9/16	11/16	1 1/2	1 1/2	1/2	
ULI150-4N	UULI150-4N	1000 MCM	1500 MCM	3	3	3	9/16	5 5/8	3 3/4	9/16	5/8	1 3/4	1 3/4	1/2	
ULI200-1	UULI200-1	1500 MCM	2000 MCM	1	2 3/4	2 3/4	9/16	5 7/8	4 1/8	9/16	1 3/8	-	-	1/2	
ULI200-2	UULI200-2	1500 MCM	2000 MCM	2	2 1/8	3 1/4	9/16	6 1/8	4 1/8	9/16	11/16	1 5/8	-	1/2	
ULI200-2N	UULI200-2N	1500 MCM	2000 MCM	2	2 3/4	3	9/16	5 7/8	4 1/8	9/16	5/8	1 3/4	-	1/2	
ULI200-4	UULI200-4	1500 MCM	2000 MCM	3	3 1/8	3 1/8	9/16	6	4 1/8	9/16	3/4	1 3/4	1 3/4	1/2	
ULI200-4N	UULI200-4N	1500 MCM	2000 MCM	3	3	3	9/16	5 7/8	4 1/8	9/16	5/8	1 3/4	1 3/4	1/2	

Bronze Terminals, Taps