

## DOSSERT® TYPE PSC

### Bus Support For Two Tubular Busses

A bus support for joining and supporting two tubular busses on a post type insulator. Designed for a high resistance to impact or sustained cantilever and torsional stresses. Nuts and bolts are furnished for a base mounting or slotted cap mounting or cap screws for an insulator cap mounting.

#### Material

Copper Alloy

#### Note

For tin plating add "-SN" to end of catalog number.

#### Hardware

Everdur bolts, nuts and lockwashers  
Mounting hardware galvanized steel

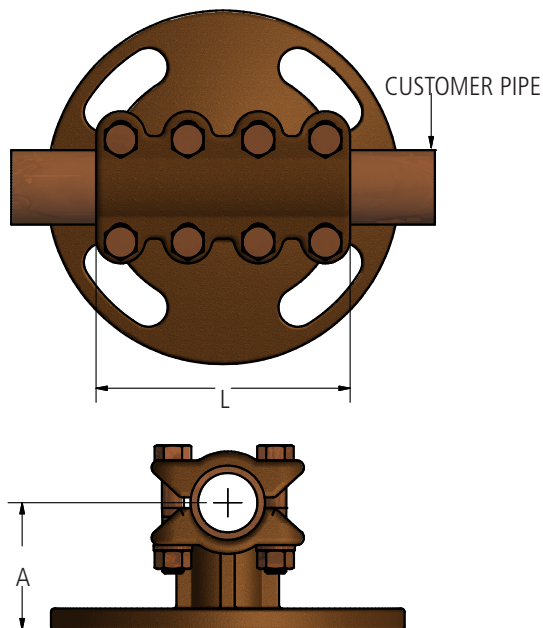
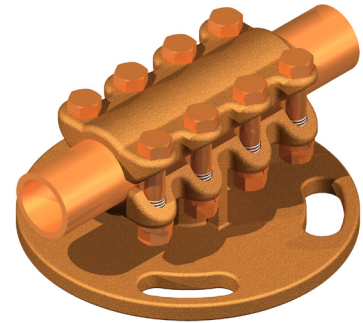

### Ordering Information

CATALOG NUMBER	SPS	BOLT CIRCLE	DIMENSIONS IN INCHES		
			A	L	BOLT SIZE
PSC75-3	3/4	3	2	3 1/2	3/8
PSC75-5	3/4	5	2 1/4	3 1/2	3/8
PSC100-3	1	3	2	4 1/2	3/8
PSC100-5	1	5	2 1/4	4 1/2	3/8
PSC125-3	1 1/4	3	2 1/4	5 1/2	1/2
PSC125-5	1 1/4	5	2 3/8	5 1/2	1/2
PSC150-3	1 1/2	3	2 1/2	5 3/4	1/2
PSC150-5	1 1/2	5	2 1/2	5 3/4	1/2
PSC200-3	2	3	2 3/4	6	1/2
PSC200-5	2	5	2 3/4	6	1/2
PSC250-3	2 1/2	3	3 1/8	6	1/2
PSC250-5	2 1/2	5	3 1/8	6	1/2
PSC300-5	3	5	3 5/8	7	5/8
PSC350-5	3 1/2	5	4	8	5/8
PSC400-5	4	5	4 1/2	8 3/4	5/8