

## DOSSERT®

### TYPE CAP

#### Bus Support for Tubular Bus To Insulator Cap

A two piece high strength bronze cable support which mounts conductor to cap of insulator. Furnished with cap screws for threading into tapped holes on insulator. For base mounting, if specified, bolts and nuts will be furnished. When ordering specify conductor size to be employed so that correct length of bolt can be supplied.

#### Material

Copper Alloy

#### Hardware

Everdur bolts and lockwashers

#### Notes

- For Electro Tin Plate, add "-SN" to catalog number. EX: CAP21-3-SN

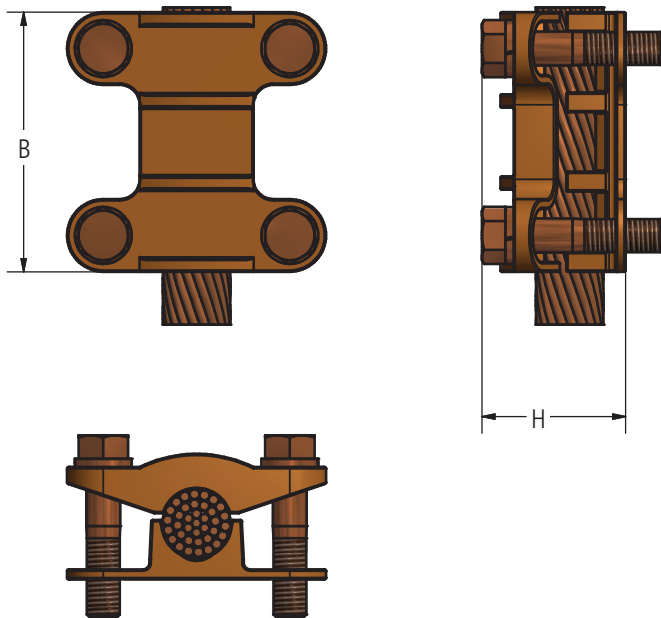
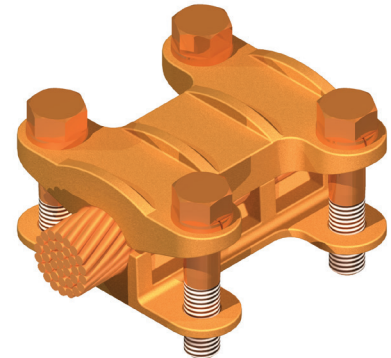

### Ordering Information

CATALOG NUMBER	CABLE RANGE		BOLT CIRCLE	DIMENSIONS IN INCHES		
	MIN	MAX		B	H	BOLT SIZE
CAP21-3	2 Stranded	4/0 Stranded	3	3 1/4	1 9/16	1/2
CAP21-5	2 Stranded	4/0 Stranded	5	4 15/16	1 13/16	5/8
CAP50-3	2/0 Stranded	500 kcmil	3	3 1/4	1 13/16	1/2
CAP50-5	2/0 Stranded	500 kcmil	5	4 15/16	2 1/16	5/8
CAP125-3	550 kcmil	1250 kcmil	3	3 1/4	2 3/16	1/2
CAP125-5	550 kcmil	1250 kcmil	5	4 15/16	2 3/4	5/8