

DOSSERT®

TYPE UPK

Copper U-Bolt Coupler for Pipe to Cable

A U-bolt cable to pipe coupler. Made of high conductivity copper alloy and designed for rugged service. The variable U-bolt feature makes it possible for a connector for a given pipe size to accommodate individually several different cable sizes.

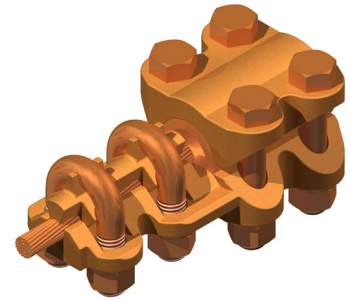

Material

Copper Alloy

Hardware

Everdur bolts, nuts, lockwashers, and U-bolts

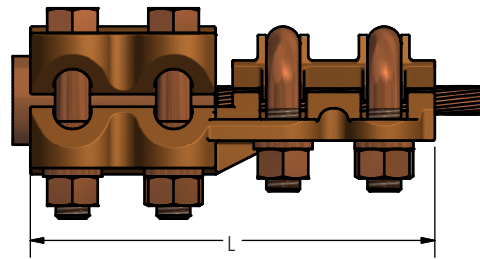
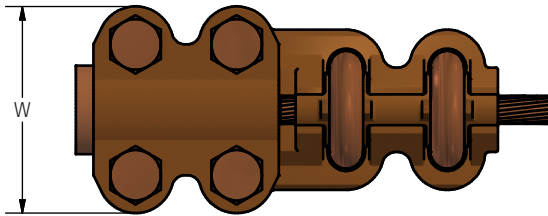

Ordering Information

CATALOG NUMBER	SPS	CABLE RANGE		DIMENSIONS IN INCHES		BOLT DIAMETER	
		MIN	MAX	L	W	PIPE	CABLE
UPK50-13	1/2	6 Str	2/0 STR	4	2 7/32	3/8	3/8
UPK50-21	1/2	1 Str	4/0 STR	4 1/8	2 7/32	3/8	3/8
UPK50-30	1/2	1/0 STR	300 MCM	4 1/4	2 7/32	3/8	3/8
UPK75-13	3/4	6 Str	2/0 STR	4 1/4	2 7/16	3/8	3/8
UPK75-21	3/4	1 Str	4/0 STR	4 3/8	2 7/16	3/8	3/8
UPK75-30	3/4	1/0 STR	300 MCM	4 1/2	2 7/16	3/8	3/8
UPK75-50	3/4	300 MCM	500 MCM	4 3/4	2 7/16	3/8	3/8
UPK100-13	1 Str	-	2/0 STR	4 1/4	2 11/16	3/8	3/8
UPK100-21	1 Str	1 Str	4/0 STR	4 3/8	2 11/16	3/8	3/8
UPK100-30	1 Str	1/0 STR	300 MCM	4 1/2	2 11/16	3/8	3/8
UPK100-50	1 Str	300 MCM	500 MCM	4 7/8	2 11/16	3/8	3/8
UPK100-80	1 Str	500 MCM	800 MCM	5 3/4	2 11/16	3/8	1/2
UPK125-13	1 1/4	6 Str	2/0 STR	4 3/8	3 1/2	3/8	3/8
UPK125-21	1 1/4	1 Str	4/0 STR	4 1/2	3 1/2	3/8	3/8
UPK125-30	1 1/4	1/0 STR	300 MCM	4 5/8	3 1/2	3/8	3/8
UPK125-50	1 1/4	300 MCM	500 MCM	4 7/8	3 1/2	3/8	3/8
UPK125-80	1 1/4	500 MCM	800 MCM	6 Str	3 1/2	1/2	1/2
UPK125-100	1 1/4	750 MCM	1000 MCM	6 1/4	3 1/2	1/2	1/2
UPK150-21	1 1/2	1 Str	4/0 STR	4 5/8	3 3/4	3/8	3/8
UPK150-30	1 1/2	1/0 STR	300 MCM	4 3/4	3 3/4	3/8	3/8
UPK150-50	1 1/2	300 MCM	500 MCM	5	3 3/4	3/8	3/8
UPK150-80	1 1/2	500 MCM	800 MCM	6 1/2	3 3/4	1/2	1/2
UPK150-100	1 1/2	750 MCM	1000 MCM	6 3/4	3 3/4	1/2	1/2
UPK200-21	2	1 Str	4/0 STR	4 5/8	4 3/16	3/8	3/8
UPK200-30	2	1/0 STR	300 MCM	4 3/4	4 3/16	3/8	3/8
UPK200-50	2	300 MCM	500 MCM	5	4 3/16	3/8	3/8
UPK200-80	2	500 MCM	800 MCM	6 3/4	4 3/16	1/2	1/2
UPK200-100	2	750 MCM	1000 MCM	6 3/4	4 3/16	1/2	1/2
UPK200-150	2	1000 MCM	1500 MCM	7 1/4	4 3/16	1/2	1/2
UPK250-21	2 1/2	1 Str	4/0 STR	4 5/8	4 11/16	3/8	3/8
UPK250-30	2 1/2	1/0 STR	300 MCM	4 3/4	4 11/16	3/8	3/8
UPK250-50	2 1/2	300 MCM	500 MCM	5	4 11/16	3/8	3/8
UPK250-80	2 1/2	500 MCM	800 MCM	6 1/2	4 11/16	1/2	1/2
UPK250-100	2 1/2	750 MCM	1000 MCM	6 3/4	4 11/16	1/2	1/2
UPK250-150	2 1/2	1000 MCM	1500 MCM	7 1/4	4 11/16	1/2	1/2
UPK300-30	3	1/0 STR	300 MCM	4 3/4	5 3/4	3/8	3/8
UPK300-50	3	300 MCM	500 MCM	5	5 3/4	3/8	3/8
UPK300-80	3	500 MCM	800 MCM	6 3/4	5 3/4	1/2	1/2
UPK300-100	3	750 MCM	1000 MCM	7	5 3/4	1/2	1/2
UPK300-150	3	1000 MCM	1500 MCM	7 1/4	5 3/4	1/2	1/2
UPK400-30	4	1/0 STR	300 MCM	4 3/4	6 3/4	3/8	3/8
UPK400-50	4	300 MCM	500 MCM	5	6 3/4	3/8	3/8
UPK400-80	4	500 MCM	800 MCM	6 3/4	6 3/4	1/2	1/2
UPK400-100	4	750 MCM	1000 MCM	7	6 3/4	1/2	1/2
UPK400-150	4	1000 MCM	1500 MCM	7 1/2	6 3/4	1/2	1/2
UPK400-200	4	1500 MCM	2000 MCM	8	6 3/4	1/2	1/2