

DOSSERT®

TYPE UPT

Copper Pipe To Cable Tee Connector

A pipe to cable tee connector. The U-bolt variable clamping feature on the tap permits a number of cable sizes for one size of pipe. All bolts, nuts, lockwashers are of Everdur material.

Material

Cast High Conductivity Copper Alloy

Hardware

Everdur bolts, nuts, lockwashers, and U-bolts

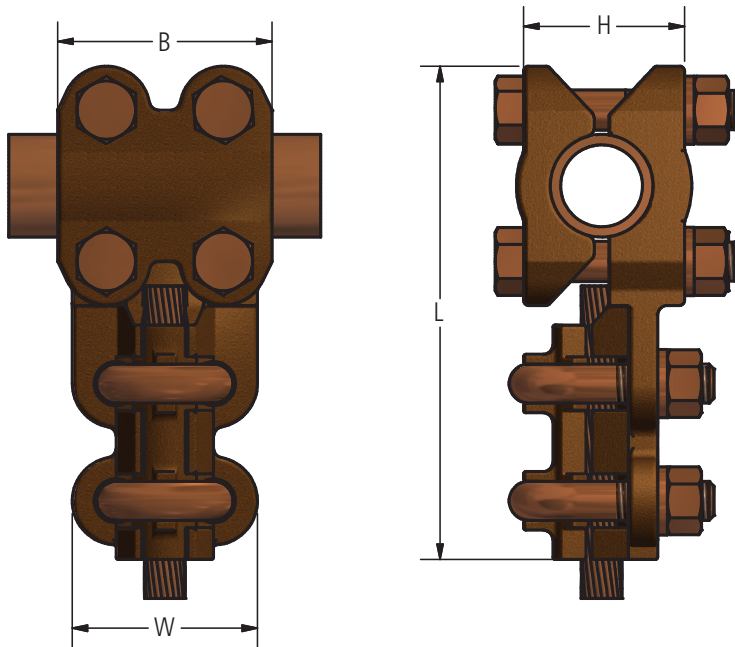
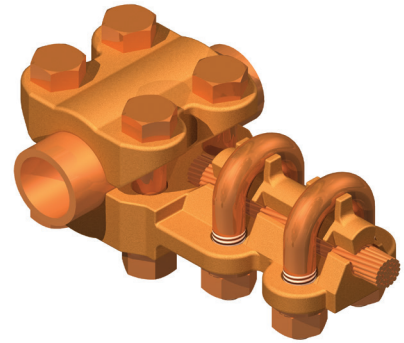

DOSSERT®

TYPE UPT

Copper Pipe To Cable Tee Connector

Ordering Information

CATALOG NUMBER	SPS	CABLE RANGE		DIMENSIONS IN INCHES				U-BOLT DIAMETER	
		MIN	MAX	B	H MAX	L	W	SPS	CABLE
UPT50-13	1/2	6 STR	2/0 STR	2	1 3/4	5 1/8	1 5/8	3/8	3/8
UPT50-21	1/2	1 STR	4/0 STR	2	1 3/4	5 1/4	1 15/16	3/8	3/8
UPT50-30	1/2	1/0 STR	300 MCM	2	1 3/4	5 3/8	2	3/8	3/8
UPT75-13	3/4	6 STR	2/0 STR	2	2	5 1/8	1 5/8	3/8	3/8
UPT75-21	3/4	1 STR	4/0 STR	2	2	5 1/4	1 15/16	3/8	3/8
UPT75-30	3/4	1/0 STR	300 MCM	2	2	5 3/8	2	3/8	3/8
UPT75-50	3/4	300 MCM	500 MCM	2	2	5 1/2	2 1/8	3/8	3/8
UPT100-13	1	6 STR	2/0 STR	2	2	5 5/8	1 5/8	3/8	3/8
UPT100-21	1	1 STR	4/0 STR	2	2 1/8	5 3/4	1 15/16	3/8	3/8
UPT100-30	1	1/0 STR	300 MCM	2	2 1/8	5 7/8	2	3/8	3/8
UPT100-50	1	300 MCM	500 MCM	2	2 1/8	6	2 1/8	3/8	3/8
UPT100-80	1	500 MCM	800 MCM	2	2 1/8	6 1/8	2 3/8	3/8	1/2
UPT125-13	1 1/4	6 STR	2/0 STR	2	2 3/8	5 7/8	1 5/8	3/8	3/8
UPT125-21	1 1/4	1 STR	4/0 STR	2	2 3/8	6	1 15/16	3/8	3/8
UPT125-30	1 1/4	1/0 STR	300 MCM	2	2 3/8	6 1/8	2	3/8	3/8
UPT125-50	1 1/4	300 MCM	500 MCM	2	2 3/8	6 1/4	2 1/8	3/8	3/8
UPT125-80	1 1/4	500 MCM	800 MCM	2	2 3/8	6 3/8	2 3/8	3/8	1/2
UPT125-100	1 1/4	750 MCM	1000 MCM	2 3/4	2 1/2	7 1/4	2 7/8	1/2	1/2
UPT150-21	1 1/2	1 STR	4/0 STR	2	2 3/8	6 1/8	1 15/16	3/8	3/8
UPT150-30	1 1/2	1/0 STR	300 MCM	2	2 1/2	6 1/4	2	3/8	3/8
UPT150-50	1 1/2	300 MCM	500 MCM	2	2 1/2	6 3/8	2 1/8	3/8	3/8
UPT150-80	1 1/2	500 MCM	800 MCM	2	2 1/2	6 1/2	2 3/8	3/8	1/2
UPT150-100	1 1/2	750 MCM	1000 MCM	2 3/4	2 3/4	7 3/8	2 7/8	1/2	1/2
UPT200-21	2	1 STR	4/0 STR	2	2 7/8	6 13/16	1 15/16	3/8	3/8
UPT200-30	2	1/0 STR	300 MCM	2	2 7/8	6 15/16	2	3/8	3/8
UPT200-50	2	300 MCM	500 MCM	2	3	7 1/16	2 1/8	3/8	3/8
UPT200-80	2	500 MCM	800 MCM	2	3	7 3/16	2 3/8	3/8	1/2
UPT200-100	2	750 MCM	1000 MCM	2 3/4	3	8 1/16	2 7/8	1/2	1/2
UPT200-150	2	1000 MCM	1500 MCM	2 3/4	3 1/8	8 9/16	3 1/4	1/2	1/2
UPT250-21	2 1/2	1 STR	4/0 STR	2	3 7/16	7 1/8	1 15/16	3/8	3/8
UPT250-30	2 1/2	1/0 STR	300 MCM	2	3 1/2	7 1/4	2	3/8	3/8
UPT250-50	2 1/2	300 MCM	500 MCM	2	3 1/2	7 3/8	2 1/8	3/8	3/8
UPT250-80	2 1/2	500 MCM	800 MCM	2	3 1/2	7 1/2	2 3/8	3/8	1/2
UPT250-100	2 1/2	750 MCM	1000 MCM	2 3/4	3 5/8	8 1/2	2 7/8	1/2	1/2
UPT250-150	2 1/2	1000 MCM	1500 MCM	2 3/4	3 5/8	9	3 1/4	1/2	1/2
UPT300-21	3	1 STR	4/0 STR	2	4 1/8	7 3/4	1 15/16	3/8	3/8
UPT300-30	3	1/0 STR	300 MCM	2	4 1/8	7 7/8	2	3/8	3/8
UPT300-50	3	300 MCM	500 MCM	2	4 3/16	8	2 1/8	3/8	3/8
UPT300-80	3	500 MCM	800 MCM	2	4 3/16	8 1/8	2 3/8	3/8	3/8
UPT300-100	3	750 MCM	1000 MCM	2 3/4	4 1/4	8 7/8	2 7/8	1/2	1/2
UPT300-150	3	1000 MCM	1500 MCM	2 3/4	4 1/4	9 3/8	3 1/4	1/2	1/2
UPT400-21	4	1 STR	4/0 STR	2	5 1/8	8 3/4	1 15/16	3/8	3/8
UPT400-30	4	1/0 STR	300 MCM	2	5 1/8	8 7/8	2	3/8	3/8
UPT400-50	4	300 MCM	500 MCM	2	5 1/4	9	2 1/8	3/8	3/8
UPT400-80	4	500 MCM	800 MCM	2	5 1/4	9 1/8	2 3/8	3/8	3/8
UPT400-100	4	750 MCM	1000 MCM	2 3/4	5 3/8	10 1/8	2 7/8	1/2	1/2
UPT400-150	4	1000 MCM	1500 MCM	2 3/4	5 3/8	10 5/8	3 1/4	1/2	1/2
UPT400-200	4	1500 MCM	2000 MCM	2 3/4	5 3/8	11 1/8	3 1/2	1/2	1/2