

DOSSERT®

TYPE PC

Copper Connector For Two Cable In Parallel

A clamp type connector for connecting two cable or wire conductors in parallel. Specially serated bearing areas provide a high electrical contact efficiency and high pull-out strength.

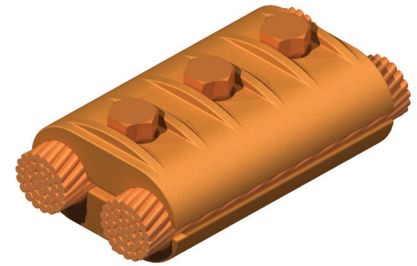

Material

Copper Alloy

Hardware

Everdur bolts, nuts and lockwashers

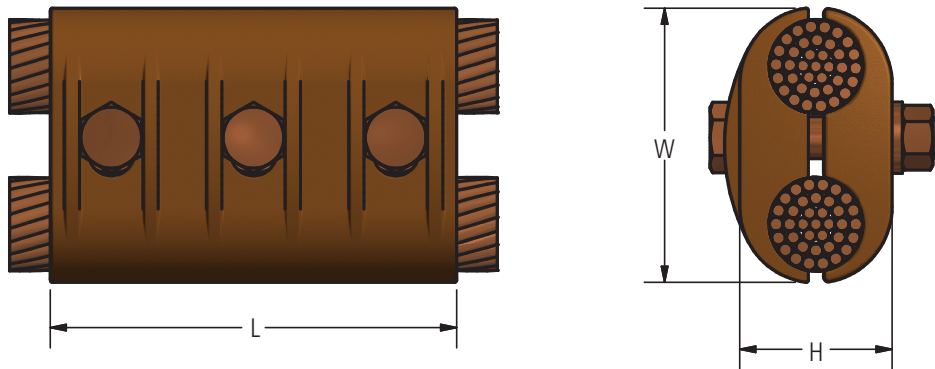

Ordering Information

CATALOG NUMBER	CABLE RANGE		DIMENSIONS IN INCHES			BOLT SIZE
	RUN	TAP	H	L	W	
PC4-4	4	4 Str	9/16	2 1/4	1 5/16	5/16
PC5-4	3	4 Str	9/16	2 1/4	1 5/16	5/16
PC5-5	3	3 Str	9/16	2 1/4	1 5/16	5/16
PC6-4	2	4 Str	5/8	2 1/4	1 3/8	5/16
PC6-5	2	3 Str	5/8	2 1/4	1 3/8	5/16
PC6-6	1	2 Str	3/4	2 1/4	1 1/2	5/16
PC8-4	1 Str	4 Str	3/4	2 1/4	1 3/8	5/16
PC8-5	1 Str	3 Str	3/4	2 1/4	1 3/8	5/16
PC8-6	1 Str	2 Str	3/4	2 1/4	1 7/16	5/16
PC8-8	1 Str	1 Str	3/4	2 1/4	1 7/16	5/16
PC10-4	1/0 Str	4 Str	1	2 1/2	1 5/16	3/8
PC10-5	1/0 Str	3 Str	1	2 1/2	1 7/16	3/8
PC10-6	1/0 Str	2 Str	1	2 1/2	1 1/2	3/8
PC10-8	1/0 Str	1 Str	1	2 1/2	1 1/2	3/8
PC10-10	1/0 Str	1/0 Str	1	3	1 5/8	3/8
PC13-4	2/0 Str	4 Str	1 3/16	2 1/2	1 7/16	3/8
PC13-5	2/0 Str	3 Str	1 3/16	2 1/2	1 1/2	3/8
PC13-6	2/0 Str	2 Str	1 3/16	2 1/2	1 1/2	3/8
PC13-8	2/0 Str	1 Str	1 3/16	2 1/2	1 9/16	3/8
PC13-10	2/0 Str	1/0 Str	1 3/16	3	1 9/16	3/8
PC13-13	2/0 Str	2/0 Str	1 3/16	3	1 5/8	3/8
PC17-4	3/0 Str	4 Str	1 3/16	2 1/2	1 1/2	3/8
PC17-5	3/0 Str	3 Str	1 3/16	2 1/2	1 1/2	3/8
PC17-6	3/0 Str	2 Str	1 3/16	2 3/4	1 9/16	3/8
PC17-8	3/0 Str	1 Str	1 3/16	2 3/4	1 9/16	3/8
PC17-10	3/0 Str	1/0 Str	1 3/16	3	1 5/8	3/8
PC17-13	3/0 Str	2/0 Str	1 3/16	3	1 5/8	3/8
PC17-17	3/0 Str	3/0 Str	1 3/16	4	1 11/16	3/8
PC21-4	4/0 Str	4 Str	1 3/16	2 1/2	1 1/2	3/8
PC21-5	4/0 Str	3 Str	1 3/16	2 1/2	1 9/16	3/8
PC21-6	4/0 Str	2 Str	1 1/8	3	1 7/8	1/2
PC21-8	4/0 Str	1 Str	1 3/16	2 3/4	1 5/8	3/8

Bronze Parallel, Cross, and Bar Taps

DOSSERT®

TYPE PC

Copper Connector For Two Cable In Parallel

Ordering Information

CATALOG NUMBER	CABLE RANGE		DIMENSIONS IN INCHES			BOLT SIZE
	RUN	TAP	H	L	W	
PC21-10	4/0 Str	1/0 Str	1 3/16	3	1 11/16	3/8
PC21-13	4/0 Str	2/0 Str	1 1/16	3	1 11/16	3/8
PC21-17	4/0 Str	3/0 Str	1 3/16	4	1 13/16	3/8
PC21-21	4/0 Str	4/0 Str	1 3/16	4	1 3/4	3/8
PC25-6	250 MCM	2 Str	1 3/16	2 3/4	1 5/8	3/8
PC25-8	250 MCM	1 Str	1 3/16	2 3/4	1 5/8	3/8
PC25-10	250 MCM	1/0 Str	1 3/16	3	1 3/4	3/8
PC25-13	250 MCM	2/0 Str	1 3/16	3	1 3/4	3/8
PC25-17	250 MCM	3/0 Str	1 3/16	4	1 7/8	3/8
PC25-21	250 MCM	4/0 Str	1 3/16	4	1 15/16	3/8
PC25-25	250 MCM	250 MCM	1 3/16	4	2	3/8
PC30-8	300 MCM	1 Str	1 3/16	2 3/4	1 3/4	3/8
PC30-10	300 MCM	1/0 Str	1 3/16	3	1 13/16	3/8
PC30-13	300 MCM	2/0 Str	1 3/16	3	1 15/16	3/8
PC30-17	300 MCM	3/0 Str	1 3/16	4	1 15/16	3/8
PC30-21	300 MCM	4/0 Str	1 3/16	4	2	3/8
PC30-25	300 MCM	250 MCM	1 3/16	4	2 1/16	3/8
PC30-30	300 MCM	300 MCM	1 3/16	4	2 1/16	3/8
PC35-8	350 MCM	1 Str	1 1/4	2 3/4	1 7/8	3/8
PC35-10	350 MCM	1/0 Str	1 1/4	3	1 7/8	3/8
PC35-13	350 MCM	2/0 Str	1 1/4	3	1 7/8	3/8
PC35-17	350 MCM	3/0 Str	1 1/4	4	2	3/8
PC35-21	350 MCM	4/0 Str	1 1/4	4	2	3/8
PC35-25	350 MCM	250 MCM	1 1/4	4	2 1/8	3/8
PC35-30	350 MCM	300 MCM	1 1/4	4	2 1/8	3/8
PC35-35	350 MCM	350 MCM	1 1/4	4	2 3/16	3/8
PC40-10	400 MCM	1/0 Str	1 5/16	3	1 7/8	3/8
PC40-13	400 MCM	2/0 Str	1 5/16	3	1 7/8	3/8
PC40-17	400 MCM	3/0 Str	1 5/16	4	2 1/16	3/8
PC40-21	400 MCM	4/0 Str	1 5/16	4	2 1/16	3/8
PC40-25	400 MCM	250 MCM	1 5/16	4	2 1/8	3/8
PC40-30	400 MCM	300 MCM	1 5/16	4	2 1/8	3/8
PC40-35	400 MCM	350 MCM	1 5/16	4	2 1/4	3/8
PC40-40	400 MCM	400 MCM	1 5/16	4	2 1/4	3/8
PC50-10	500 MCM	1/0 Str	1 3/8	3	1 15/16	3/8
PC50-13	500 MCM	2/0 Str	1 3/8	3	2	3/8
PC50-17	500 MCM	3/0 Str	1 3/8	4	2 3/16	3/8
PC50-21	500 MCM	4/0 Str	1 3/8	4	2 3/16	3/8
PC50-25	500 MCM	250 MCM	1 3/8	4	2 1/4	3/8
PC50-30	500 MCM	300 MCM	1 3/8	4	2 1/4	3/8
PC50-35	500 MCM	350 MCM	1 3/8	4	2 5/16	3/8
PC50-40	500 MCM	400 MCM	1 3/8	4	2 5/16	3/8
PC50-50	500 MCM	500 MCM	1 1/2	5	2 1/2	1/2
PC60-13	600 MCM	2/0 Str	1 1/2	3	2 1/8	3/8
PC60-17	600 MCM	3/0 Str	1 1/2	4	2 3/16	3/8
PC60-21	600 MCM	4/0 Str	1 1/2	4	2 3/16	3/8
PC60-25	600 MCM	250 MCM	1 1/2	4	2 5/16	3/8
PC60-30	600 MCM	300 MCM	1 1/2	4	2 5/16	3/8
PC60-35	600 MCM	350 MCM	1 1/2	4	2 3/8	3/8
PC60-40	600 MCM	400 MCM	1 1/2	4	2 3/8	3/8
PC60-50	600 MCM	500 MCM	1 11/16	5	2 5/8	1/2
PC60-60	600 MCM	600 MCM	1 11/16	5	2 3/4	1/2
PC70-13	700 MCM	2/0 Str	1 5/8	3	2 3/16	3/8
PC70-17	700 MCM	3/0 Str	1 5/8	4	2 1/4	3/8
PC70-21	700 MCM	4/0 Str	1 5/8	4	2 1/4	3/8
PC70-25	700 MCM	250 MCM	1 5/8	4	2 3/8	3/8
PC70-30	700 MCM	300 MCM	1 5/8	4	2 3/8	3/8
PC70-35	700 MCM	350 MCM	1 5/8	4	2 1/2	3/8
PC70-40	700 MCM	400 MCM	1 5/8	4	2 1/2	3/8
PC70-50	700 MCM	500 MCM	1 13/16	5	2 11/16	1/2
PC70-60	700 MCM	600 MCM	1 13/16	5	2 13/16	1/2
PC70-70	700 MCM	700 MCM	1 13/16	5	2 7/8	1/2
PC75-21	750 MCM	4/0 Str	1 11/16	4	2 5/16	3/8

Bronze Parallel,
Cross, and Bar Taps

DOSSERT®

TYPE PC

Copper Connector For Two Cable In Parallel

Ordering Information

CATALOG NUMBER	CABLE RANGE		DIMENSIONS IN INCHES			BOLT SIZE
	RUN	TAP	H	L	W	
PC75-25	750 MCM	250 MCM	1 11/16	4	2 7/16	3/8
PC75-30	750 MCM	300 MCM	1 11/16	4	2 7/16	3/8
PC75-35	750 MCM	350 MCM	1 11/16	4	2 1/2	3/8
PC75-40	750 MCM	400 MCM	1 11/16	4	2 1/2	3/8
PC75-50	750 MCM	500 MCM	1 3/4	5	2 3/4	1/2
PC75-60	750 MCM	600 MCM	1 3/4	5	2 7/8	1/2
PC75-70	750 MCM	700 MCM	1 3/4	5	2 15/16	1/2
PC75-75	750 MCM	750 MCM	1 3/4	5	3	1/2
PC80-21	800 MCM	4/0 Str	1 3/4	4	2 15/16	3/8
PC80-25	800 MCM	250 MCM	1 3/4	4	2 7/16	3/8
PC80-30	800 MCM	300 MCM	1 3/4	4	2 7/16	3/8
PC80-35	800 MCM	350 MCM	1 3/4	4	2 1/2	3/8
PC80-40	800 MCM	400 MCM	1 3/4	4	2 5/8	3/8
PC80-50	800 MCM	500 MCM	1 7/8	5	2 3/4	1/2
PC80-60	800 MCM	600 MCM	1 7/8	5	2 7/8	1/2
PC80-70	800 MCM	700 MCM	1 7/8	5	2 15/16	1/2
PC80-75	800 MCM	750 MCM	1 7/8	5	3	1/2
PC80-80	800 MCM	800 MCM	1 7/8	5	3	1/2
PC100-21	1000 MCM	4/0 Str	1 3/4	4	2 1/2	3/8
PC100-25	1000 MCM	250 MCM	1 3/4	4	2 9/16	3/8
PC100-30	1000 MCM	300 MCM	1 3/4	4	2 9/16	3/8
PC100-35	1000 MCM	350 MCM	1 3/4	4	2 5/8	3/8
PC100-40	1000 MCM	400 MCM	1 3/4	4	2 5/8	3/8
PC100-50	1000 MCM	500 MCM	1 7/8	5	2 7/8	1/2
PC100-60	1000 MCM	600 MCM	1 7/8	5	3	1/2
PC100-70	1000 MCM	700 MCM	1 7/8	5	3 1/16	1/2
PC100-75	1000 MCM	750 MCM	1 7/8	5	3 1/8	1/2
PC100-80	1000 MCM	800 MCM	1 7/8	5	3 1/8	1/2
PC100-100	1000 MCM	1000 MCM	1 7/8	5	3 1/4	1/2