

DOSSERT®

TYPE UD Universal Parallel Clamp

A universal clamp to provide a connection for two cables or wires over a wide range of sizes. The interlocking of the halves of this clamp insures a good grip and high area of a contact for all conductors.

Material

Copper Alloy

Hardware

Everdur bolts, nuts and lockwashers

Notes

- Voltage rating is 230KV
- For tin plating add "-SN" to end of catalog number. EX: UD50-21-SN
- Also add "GS" for galvanized steel hardware.

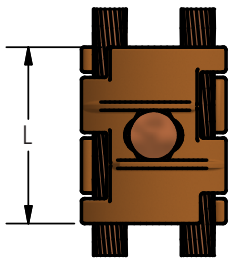
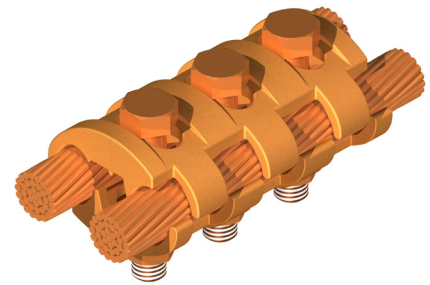

FIG. 1

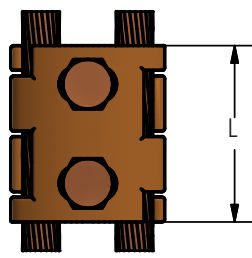

FIG. 2

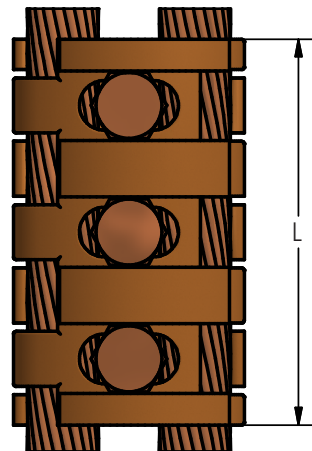
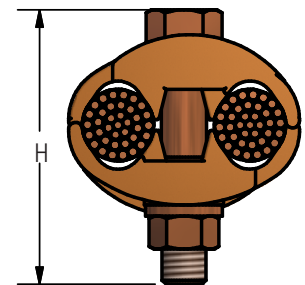

FIG. 3



Ordering Information

CATALOG NUMBER	CONDUCTOR RANGE FOR RUN AND TAP	FIGURE NUMBER	DIMENSIONS IN INCHES		
			H	L	BOLT SIZE
UD10-2	No. 6 Solid - 1/0 Stranded	1	1 3/4	2	3/8
UD21-4	No. 4 Solid - 4/0 Stranded	2	2	2 1/4	3/8
UD30-6	No. 2 Solid - 300 kcmil	2	2 1/4	2 1/2	3/8
UD50-21	4/0 Stranded - 500 kcmil	3	2 3/4	4 3/8	1/2
UD80-30	300 Stranded - 800 kcmil	3	3 1/4	4 1/2	1/2
UD100-50	500 Stranded - 1000 kcmil	3	3 1/2	4 5/8	1/2