

DOSSERT® TYPE CF-N (NEMA Pad Sizes) Flexible Copper Braid

Flexible copper braid for linking conductors that are subject to motion. The braid is tin plated copper wire, terminated at each end by a non-plated copper pad.

Material

Copper Alloy

Notes

- Braid may be custom made for any configuration of length, pad size and hole diameter.
- For Electro Tin Plate, add suffix "-SN" to end of catalog number. Ex: CF771-10-N-SN
- For Undrilled Pad, add suffix "-U" to pad size in catalog number. Ex: CF772-16-N-U

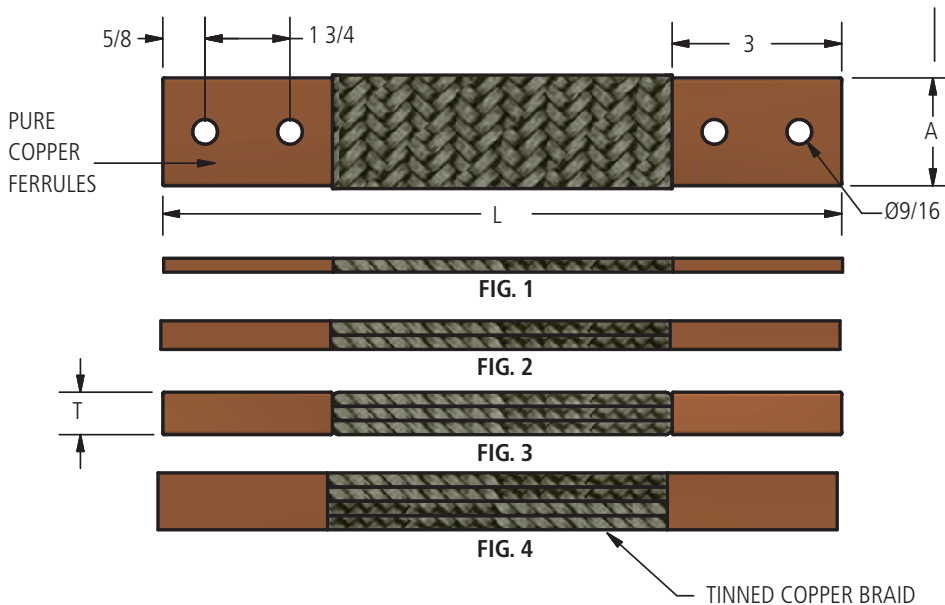
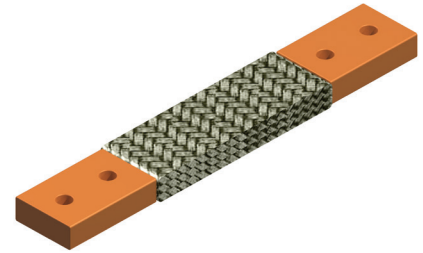

Ordering Information

| CATALOG NUMBER | FIG. NO. | INDOOR AMPERE RATING* | DIMENSIONS IN INCHES | | |
|----------------|----------|-----------------------|----------------------|----|------|
| | | | A | L | T |
| CF 724-12-N | 4 | 520 | 1 1/2 | 12 | 1/4 |
| CF 771-10-N | 1 | 190 | 1 | 10 | 3/16 |
| CF 771-16-N | 1 | 190 | 1 | 16 | 3/16 |
| CF 771-18-N | 1 | 190 | 1 | 18 | 3/16 |
| CF 771-20-N | 1 | 190 | 1 | 20 | 3/16 |
| CF 771-24-N | 1 | 190 | 1 | 24 | 3/16 |
| CF 771-36-N | 1 | 190 | 1 | 36 | 3/16 |
| CF 772-16-N | 2 | 330 | 1 | 16 | 1/4 |
| CF 772-18-N | 2 | 330 | 1 | 18 | 1/4 |
| CF 772-20-N | 2 | 330 | 1 | 20 | 1/4 |
| CF 772-21-N | 2 | 330 | 1 | 21 | 1/4 |
| CF 772-24-N | 2 | 330 | 1 | 24 | 1/4 |
| CF 772-30-N | 2 | 330 | 1 | 30 | 1/4 |
| CF 773-15-N | 3 | 470 | 1 | 15 | 5/16 |
| CF 773-16-N | 3 | 470 | 1 | 16 | 5/16 |
| CF 773-18-N | 3 | 470 | 1 | 18 | 5/16 |
| CF 773-20-N | 3 | 470 | 1 | 20 | 5/16 |
| CF 773-24-N | 3 | 470 | 1 | 24 | 5/16 |

*Note: A.C. Ampere ratings in still but confined air for maximum temperature rise 30°C above 40°C ambient with major surfaces of braid in horizontal position.

DOSSERT® TYPE CF-N (NEMA Pad Sizes) Flexible Copper Braid

Ordering Information

| CATALOG NUMBER | FIG. NO. | INDOOR AMPERE RATING* | DIMENSIONS IN INCHES | | |
|------------------|----------|-----------------------|----------------------|--------|-------|
| | | | A | L | T |
| CF 774-16-N | 4 | 600 | 1 | 16 | 3/8 |
| CF 774-18-N | 4 | 600 | 1 | 18 | 3/8 |
| CF 774-20-N | 4 | 600 | 1 | 20 | 3/8 |
| CF 774-24-N | 4 | 600 | 1 | 24 | 3/8 |
| CF 1051-16-N | 1 | 255 | 1 1/2 | 16 | 5/32 |
| CF 1051-18-N | 1 | 255 | 1 1/2 | 18 | 5/32 |
| CF 1051-20-N | 1 | 255 | 1 1/2 | 20 | 5/32 |
| CF 1051-24-N | 1 | 255 | 1 1/2 | 24 | 5/32 |
| CF 1052-16-N | 2 | 360 | 1 1/2 | 16 | 7/32 |
| CF 1052-18-N | 2 | 360 | 1 1/2 | 18 | 7/32 |
| CF 1052-20-N | 2 | 360 | 1 1/2 | 20 | 7/32 |
| CF 1052-24-N | 2 | 360 | 1 1/2 | 24 | 7/32 |
| CF 1053-16-N | 3 | 570 | 1 1/2 | 16 | 9/32 |
| CF 1053-18-N | 3 | 570 | 1 1/2 | 18 | 9/32 |
| CF 1053-20-N | 3 | 570 | 1 1/2 | 20 | 9/32 |
| CF 1053-24-N | 3 | 570 | 1 1/2 | 24 | 9/32 |
| CF 1054-16-N | 4 | 650 | 1 1/2 | 16 | 11/32 |
| CF 1054-18-N | 4 | 650 | 1 1/2 | 18 | 11/32 |
| CF 1054-20-N | 4 | 650 | 1 1/2 | 20 | 11/32 |
| CF 1054-24-N | 4 | 650 | 1 1/2 | 24 | 11/32 |
| CF 1541-16-N | 1 | 340 | 1 1/2 | 16 | 3/16 |
| CF 1541-18-N | 1 | 340 | 1 1/2 | 18 | 3/16 |
| CF 1541-20-N | 1 | 340 | 1 1/2 | 20 | 3/16 |
| CF 1541-24-N | 1 | 340 | 1 1/2 | 24 | 3/16 |
| CF 1542-16-N | 2 | 530 | 1 1/2 | 16 | 1/4 |
| CF 1542-18-N | 2 | 530 | 1 1/2 | 18 | 1/4 |
| CF 1542-20-N | 2 | 530 | 1 1/2 | 20 | 1/4 |
| CF 1542-24-N | 2 | 530 | 1 1/2 | 24 | 1/4 |
| CF 1542-25-N | 2 | 530 | 1 1/2 | 25 | 1/4 |
| CF 1542-36-N | 2 | 530 | 1 1/2 | 36 | 1/4 |
| CF 1543-16-N | 3 | 700 | 1 1/2 | 16 | 5/16 |
| CF 1543-18-N | 3 | 700 | 1 1/2 | 18 | 5/16 |
| CF 1543-20-N | 3 | 700 | 1 1/2 | 20 | 5/16 |
| CF 1543-21-N | 3 | 700 | 1 1/2 | 21 | 5/16 |
| CF 1543-23-N | 3 | 700 | 1 1/2 | 23 | 5/16 |
| CF 1543-24-N | 3 | 700 | 1 1/2 | 24 | 5/16 |
| CF 1544-16-N | 4 | 850 | 1 1/2 | 16 | 13/32 |
| CF 1544-16 1/2-N | 4 | 850 | 1 1/2 | 16 1/2 | 13/32 |
| CF 1544-18-N | 4 | 850 | 1 1/2 | 18 | 13/32 |
| CF 1544-20-N | 4 | 850 | 1 1/2 | 20 | 13/32 |
| CF 1544-24-N | 4 | 850 | 1 1/2 | 24 | 13/32 |
| CF 2301-16-N | 1 | 360 | 1 1/2 | 16 | 1/4 |
| CF 2301-18-N | 1 | 360 | 1 1/2 | 18 | 1/4 |
| CF 2301-20-N | 1 | 360 | 1 1/2 | 20 | 1/4 |
| CF 2301-24-N | 1 | 360 | 1 1/2 | 24 | 1/4 |
| CF 2301-30-N | 1 | 360 | 1 1/2 | 30 | 1/4 |
| CF 2302-9-N | 2 | 600 | 1 1/2 | 9 | 3/8 |
| CF 2302-16-N | 2 | 600 | 1 1/2 | 16 | 3/8 |
| CF 2302-18-N | 2 | 600 | 1 1/2 | 18 | 3/8 |
| CF 2302-20-N | 2 | 600 | 1 1/2 | 20 | 3/8 |
| CF 2302-24-N | 2 | 600 | 1 1/2 | 24 | 3/8 |
| CF 2302-25-N | 2 | 600 | 1 1/2 | 25 | 3/8 |
| CF 2302-30-N | 2 | 600 | 1 1/2 | 30 | 3/8 |
| CF 2303-15-N | 3 | 820 | 1 1/2 | 15 | 1/2 |
| CF 2303-16-N | 3 | 820 | 1 1/2 | 16 | 1/2 |
| CF 2303-18-N | 3 | 820 | 1 1/2 | 18 | 1/2 |
| CF 2303-20-N | 3 | 820 | 1 1/2 | 20 | 1/2 |
| CF 2303-22-N | 3 | 820 | 1 1/2 | 22 | 1/2 |
| CF 2303-24-N | 3 | 820 | 1 1/2 | 24 | 1/2 |
| CF 2303-25-N | 3 | 820 | 1 1/2 | 25 | 1/2 |
| CF 2304-15 1/2-N | 4 | 1000 | 1 1/2 | 15 1/2 | 13/16 |
| CF 2304-16-N | 4 | 1000 | 1 1/2 | 16 | 13/16 |

*Note: A.C. Ampere ratings in still but confined air for maximum temperature rise 30°C above 40°C ambient with major surfaces of braid in horizontal position.

DOSSERT®

TYPE CF-N (NEMA Pad Sizes)

Flexible Copper Braid

Ordering Information

| CATALOG NUMBER | FIG. NO. | INDOOR AMPERE RATING* | DIMENSIONS IN INCHES | | |
|------------------|----------|-----------------------|----------------------|--------|-------|
| | | | A | L | T |
| CF 2304-18-N | 4 | 1000 | 1 1/2 | 18 | 13/16 |
| CF 2304-20-N | 4 | 1000 | 1 1/2 | 20 | 13/16 |
| CF 2304-24-N | 4 | 1000 | 1 1/2 | 24 | 13/16 |
| CF 2304-36-N | 4 | 1000 | 1 1/2 | 36 | 13/16 |
| CF 2304-42-N | 4 | 1000 | 1 1/2 | 42 | 13/16 |
| CF 3021-9 1/2-N | 1 | 415 | 1 1/2 | 9 1/2 | 5/16 |
| CF3021-14-N | 1 | 415 | 1 1/2 | 14 | 5/16 |
| CF 3021-16-N | 1 | 415 | 1 1/2 | 16 | 5/16 |
| CF 3021-18-N | 1 | 415 | 1 1/2 | 18 | 5/16 |
| CF 3021-20-N | 1 | 415 | 1 1/2 | 20 | 5/16 |
| CF 3201-24-N | 1 | 415 | 1 1/2 | 24 | 5/16 |
| CF 3021-27-N | 1 | 415 | 1 1/2 | 27 | 5/16 |
| CF 3022-9 3/4-N | 2 | 700 | 1 1/2 | 9 3/4 | 1/2 |
| CF 3022-10 1/2-N | 2 | 700 | 1 1/2 | 10 1/2 | 1/2 |
| CF 3022-14-N | 2 | 700 | 1 1/2 | 14 | 1/2 |
| CF 3022-16-N | 2 | 700 | 1 1/2 | 16 | 1/2 |
| CF 3022-18-N | 2 | 700 | 1 1/2 | 18 | 1/2 |
| CF 3022-20-N | 2 | 700 | 1 1/2 | 20 | 1/2 |
| CF 3022-24-N | 2 | 700 | 1 1/2 | 24 | 1/2 |
| CF 3022-30-N | 2 | 700 | 1 1/2 | 30 | 1/2 |
| CF 3022-60-N | 2 | 700 | 1 1/2 | 60 | 1/2 |
| CF 3023-16-N | 3 | 960 | 1 1/2 | 16 | 13/16 |
| CF 3023-18-N | 3 | 960 | 1 1/2 | 18 | 13/16 |
| CF 3023-20-N | 3 | 960 | 1 1/2 | 20 | 13/16 |
| CF 3023-24-N | 3 | 960 | 1 1/2 | 24 | 13/16 |
| CF 3024-14-N | 4 | 1200 | 1 1/2 | 14 | 15/16 |
| CF 3024-16-N | 4 | 1200 | 1 1/2 | 16 | 15/16 |
| CF 3024-18-N | 4 | 1200 | 1 1/2 | 18 | 15/16 |
| CF 3024-20-N | 4 | 1200 | 1 1/2 | 20 | 15/16 |
| CF 3024-24-N | 4 | 1200 | 1 1/2 | 24 | 15/16 |
| CF 3024-28-N | 4 | 1200 | 1 1/2 | 28 | 15/16 |
| CF 3024-29-N | 4 | 1200 | 1 1/2 | 29 | 15/16 |
| CF 3024-64-N | 4 | 1200 | 1 1/2 | 64 | 15/16 |

*Note: A.C. Ampere ratings in still but confined air for maximum temperature rise 30°C above 40°C ambient with major surfaces of braid in horizontal position.

Bronze Braided or Laminated Expansion