

DOSSERT®

TYPE CF Flexible Copper Braid

Flexible copper braid for linking conductors that are subject to motion. The braid is tin plated copper wire, terminated at each end by a non-plated pad.

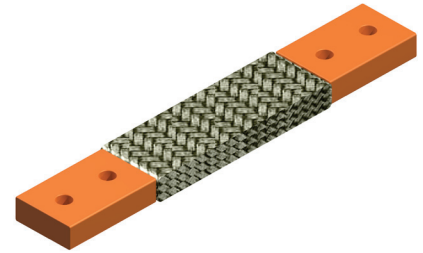

Material

Copper

Note

- Braid may be custom made for any configuration of length, pad size or hole diameter.
- For tin plated contact pads add suffix "-SN" to end of catalog number. Ex: CF771-SN
- For undrilled contact pads add suffix "-U" to end of catalog number. Ex: CF771-U
- For undrilled contact pads and tin plated pads, add suffix "-U-SN" to end of catalog number. Ex: CF771-U-SN

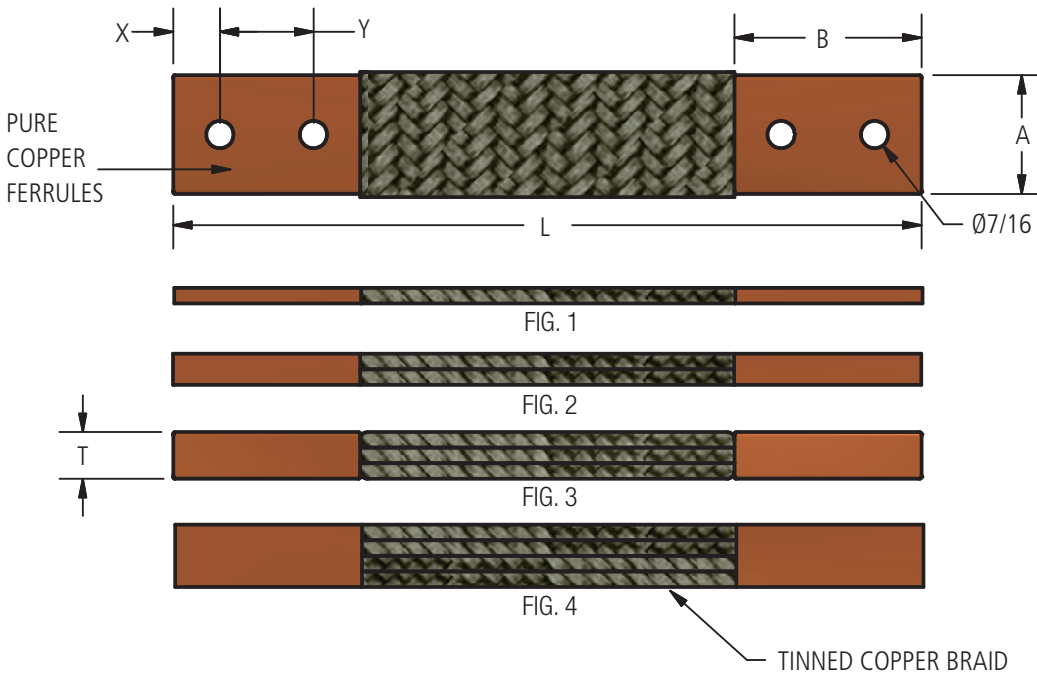



Bronze Braided or Laminated Expansion

DOSSERT®

TYPE CF Flexible Copper Braid

Ordering Information

| CATALOG NUMBER | CIRCULAR MIL AREA | FIGURE NUMBER | INDOOR AMPERE RATING* | DIMENSIONS IN INCHES | | | | | |
|----------------|-------------------|---------------|-----------------------|----------------------|-------|----------|-------|-------|-------|
| | | | | A | B | L | T | X | Y |
| CF771 | 76,800 | 1 | 190 | 1 | 2 5/8 | 12 | 3/16 | 11/16 | 1 1/4 |
| CF771-7 | 76,800 | 1 | 190 | 1 | 2 5/8 | 7 | 3/16 | 11/16 | 1 1/4 |
| CF771-10 | 76,800 | 1 | 190 | 1 | 2 5/8 | 10 | 3/16 | 11/16 | 1 1/4 |
| CF771-11 | 76,800 | 1 | 190 | 1 | 2 5/8 | 11 | 3/16 | 11/16 | 1 1/4 |
| CF771-15 | 76,800 | 1 | 190 | 1 | 2 5/8 | 15 | 3/16 | 11/16 | 1 1/4 |
| CF771-18 | 76,800 | 1 | 190 | 1 | 2 5/8 | 18 | 3/16 | 11/16 | 1 1/4 |
| CF771-20 | 76,800 | 1 | 190 | 1 | 2 5/8 | 20 | 3/16 | 11/16 | 1 1/4 |
| CF771-24 | 76,800 | 1 | 190 | 1 | 2 5/8 | 24 | 3/16 | 11/16 | 1 1/4 |
| CF771-36 | 76,800 | 1 | 190 | 1 | 2 5/8 | 36 | 3/16 | 11/16 | 1 1/4 |
| CF772 | 153,600 | 2 | 330 | 1 | 2 5/8 | 12 | 1/4 | 11/16 | 1 1/4 |
| CF772-10 | 153,600 | 2 | 330 | 1 | 2 5/8 | 10 | 1/4 | 11/16 | 1 1/4 |
| CF772-18 | 153,600 | 2 | 330 | 1 | 2 5/8 | 18 | 1/4 | 11/16 | 1 1/4 |
| CF773 | 230,400 | 3 | 470 | 1 | 2 5/8 | 12 | 5/16 | 11/16 | 1 1/4 |
| CF774-14 | 230,400 | 4 | 600 | 1 | 2 5/8 | 14 | 5/16 | 11/16 | 1 1/4 |
| CF774-16 | 230,400 | 4 | 600 | 1 | 2 5/8 | 16 | 5/16 | 11/16 | 1 1/4 |
| CF774-19 21/32 | 230,400 | 4 | 600 | 1 | 2 5/8 | 19 21/32 | 5/16 | 11/16 | 1 1/4 |
| CF774-24 | 230,400 | 4 | 600 | 1 | 2 5/8 | 24 | 5/16 | 11/16 | 1 1/4 |
| CF1541 | 153,600 | 1 | 340 | 1 1/2 | 3 | 12 | 3/16 | 3/4 | 1 1/2 |
| CF1541-18 | 153,600 | 1 | 340 | 1 1/2 | 3 | 18 | 3/16 | 3/4 | 1 1/2 |
| CF1541-24 | 153,600 | 1 | 340 | 1 1/2 | 3 | 24 | 3/16 | 3/4 | 1 1/2 |
| CF1542 | 307,200 | 2 | 530 | 1 1/2 | 3 | 12 | 1/4 | 3/4 | 1 1/2 |
| CF1542-18 | 307,200 | 2 | 530 | 1 1/2 | 3 | 18 | 1/4 | 3/4 | 1 1/2 |
| CF1542-22 | 307,200 | 2 | 530 | 1 1/2 | 3 | 22 | 1/4 | 3/4 | 1 1/2 |
| CF1542-24 | 307,200 | 2 | 530 | 1 1/2 | 3 | 24 | 1/4 | 3/4 | 1 1/2 |
| CF1543 | 460,800 | 3 | 700 | 1 1/2 | 3 | 12 | 5/16 | 3/4 | 1 1/2 |
| CF1543-14 | 460,800 | 3 | 700 | 1 1/2 | 3 | 14 | 5/16 | 3/4 | 1 1/2 |
| CF1543-14 1/2 | 460,800 | 3 | 700 | 1 1/2 | 3 | 14 1/2 | 5/16 | 3/4 | 1 1/2 |
| CF1543-16 | 460,800 | 3 | 700 | 1 1/2 | 3 | 16 | 5/16 | 3/4 | 1 1/2 |
| CF1543-18 | 460,800 | 3 | 700 | 1 1/2 | 3 | 18 | 5/16 | 3/4 | 1 1/2 |
| CF1543-20 | 460,800 | 3 | 700 | 1 1/2 | 3 | 20 | 5/16 | 3/4 | 1 1/2 |
| CF1543-24 | 460,800 | 3 | 700 | 1 1/2 | 3 | 24 | 5/16 | 3/4 | 1 1/2 |
| CF1543-28 | 460,800 | 3 | 700 | 1 1/2 | 3 | 28 | 5/16 | 3/4 | 1 1/2 |
| CF1543-30 | 460,800 | 3 | 700 | 1 1/2 | 3 | 30 | 5/16 | 3/4 | 1 1/2 |
| CF1543-36 | 460,800 | 3 | 700 | 1 1/2 | 3 | 36 | 5/16 | 3/4 | 1 1/2 |
| CF1544-10 | 616,000 | 4 | 850 | 1 1/2 | 3 | 10 | 13/32 | 3/4 | 1 1/2 |
| CF2301 | 230,400 | 1 | 360 | 1 1/2 | 3 | 12 | 1/4 | 3/4 | 1 1/2 |
| CF2301-18 | 230,400 | 1 | 360 | 1 1/2 | 3 | 18 | 1/4 | 3/4 | 1 1/2 |
| CF2302 | 460,800 | 2 | 600 | 1 1/2 | 3 | 12 | 3/8 | 3/4 | 1 1/2 |
| CF2303 | 691,200 | 3 | 820 | 1 1/2 | 3 | 12 | 1/2 | 3/4 | 1 1/2 |
| CF2303-18 | 691,200 | 3 | 820 | 1 1/2 | 3 | 18 | 1/2 | 3/4 | 1 1/2 |
| CF2303-20 | 691,200 | 3 | 820 | 1 1/2 | 3 | 20 | 1/2 | 3/4 | 1 1/2 |
| CF2303-24 | 691,200 | 3 | 820 | 1 1/2 | 3 | 24 | 1/2 | 3/4 | 1 1/2 |
| CF3021 | 302,400 | 1 | 415 | 1 1/2 | 3 | 12 | 5/16 | 3/4 | 1 1/2 |
| CF3021-18 | 302,400 | 1 | 415 | 1 1/2 | 3 | 18 | 5/16 | 3/4 | 1 1/2 |
| CF3021-24 | 302,400 | 1 | 415 | 1 1/2 | 3 | 24 | 5/16 | 3/4 | 1 1/2 |
| CF3021-30 | 302,400 | 1 | 415 | 1 1/2 | 3 | 30 | 5/16 | 3/4 | 1 1/2 |
| CF3022 | 604,800 | 2 | 700 | 1 1/2 | 3 | 12 | 1/2 | 3/4 | 1 1/2 |
| CF3022-14 | 604,800 | 2 | 700 | 1 1/2 | 3 | 14 | 1/2 | 3/4 | 1 1/2 |
| CF3022-19 | 604,800 | 2 | 700 | 1 1/2 | 3 | 19 | 1/2 | 3/4 | 1 1/2 |
| CF3022-20 | 604,800 | 2 | 700 | 1 1/2 | 3 | 20 | 1/2 | 3/4 | 1 1/2 |
| CF3022-24 | 604,800 | 2 | 700 | 1 1/2 | 3 | 24 | 1/2 | 3/4 | 1 1/2 |
| CF3022-30 | 604,800 | 2 | 700 | 1 1/2 | 3 | 30 | 1/2 | 3/4 | 1 1/2 |
| CF3023 | 907,200 | 3 | 960 | 1 1/2 | 3 | 12 | 11/16 | 3/4 | 1 1/2 |
| CF3023-22 | 907,200 | 3 | 960 | 1 1/2 | 3 | 22 | 11/16 | 3/4 | 1 1/2 |
| CF3023-24 | 907,200 | 3 | 960 | 1 1/2 | 3 | 24 | 11/16 | 3/4 | 1 1/2 |
| CF3023-30 | 907,200 | 3 | 960 | 1 1/2 | 3 | 30 | 11/16 | 3/4 | 1 1/2 |
| CF3024-48 | 1,209,600 | 4 | 1200 | 1 1/2 | 3 | 48 | 15/16 | 3/4 | 1 1/2 |

*Note: A.C. Ampere ratings in still but confined air for maximum temperature rise 30°C above 40°C ambient with major surfaces of braid in horizontal position.

Bronze Braided or Laminated Expansion