

DOSSERT® Type 3400-EHV

Substation 90° terminals are designed for limited space applications as found in substations. Designed for 500 kV service. Terminals are shorter than conventional terminals which saves space and allows for faster installation. Terminals are installed with standard AFL hex dies. Terminals can be supplied pre filled if required.



500 kV Compression Connectors

Material

Aluminum Alloy

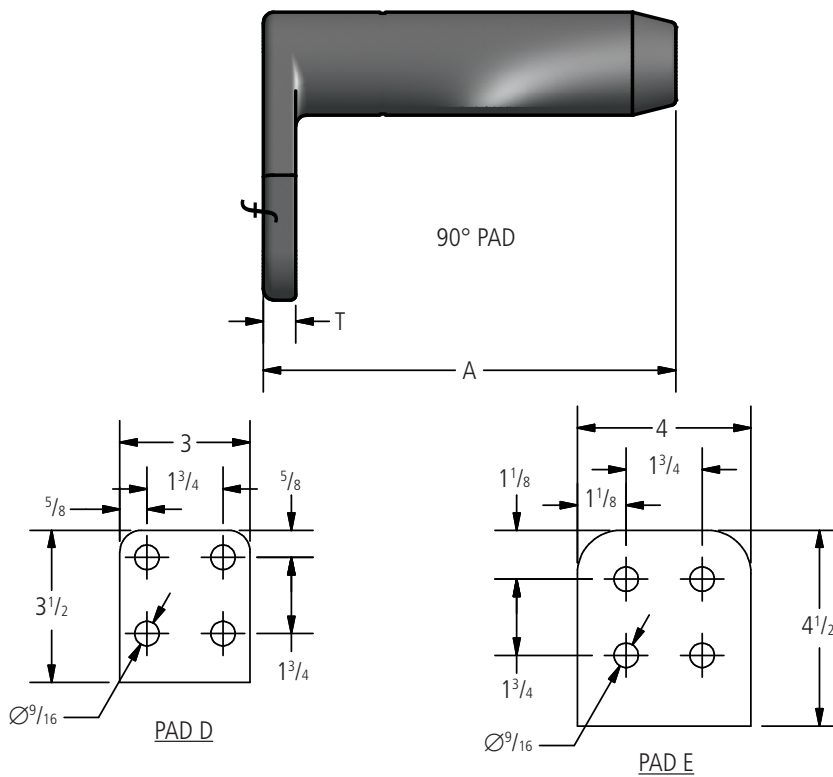

Ordering Information

CATALOG NUMBER	CONDUCTOR RANGE			PAD SIZE	DIE SIZE	DIMENSIONS IN INCHES		NOMINAL WEIGHT LBS
	DIAMETER	AAC	ACSR			A	T	
3430.1EHV	1.026 - 1.196	795 - 900	715.5(26/7) - 954(54/7)	D	30AH	6.03	0.62	1.3
3434.1EHV	1.186 - 1.313	954 - 1272	954(54/7) - 1192.5(45/7)	D	34AH	6.44	0.62	1.6
3436.1EHV	1.314 - 1.399	1351 - 1431	1192.5(54/19) - 1351.5(45/7)	D	36AH	6.72	0.62	1.7
3438.1EHV	1.399 - 1.500	1500 - 1590	1351.5(45/7) - 1510.5(45/7)	D	38AH	6.94	0.62	2.0
3440.1EHV	1.501 - 1.630	1750 - 2000	1510.5(54/19) - 1780(84/19)	D	40AH	7.38	0.62	2.2
3444.1EHV	1.630 - 1.681	2000	2034(72/7)	E	44AH	8.22	0.75	3.4
3444.2EHV	1.669 - 1.823	2250 - 2500	2034(72/7) - 2312(76/19)	E	44AH	8.22	0.75	3.3
3448.1EHV	1.823 - 1.996	2500 - 2750	2515(76/19)	E	48AH	9.22	0.75	4.5
3448.2EHV	1.996 - 2.158	2500 - 2750	2515(76/19)	E	48AH	9.22	0.75	4.0