

HiTemp Connector—Straight for ACSS/TW Conductor, 5600HT Series

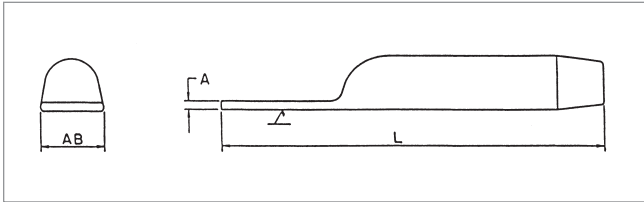

The 5600HT Series Straight Terminal Connector is specifically designed for ACSS/TW conductors. It is fabricated from a specially tempered aluminum that will transfer elevated current and dissipate increased heat more efficiently.

All HiTemp Terminal Connectors are designed for limited tension use, maintaining a minimum of 40% of the ASTM rated strength of the conductor.

Square edges of the compression accessory pad can cause Corona. Pads with rounded edges and corners can be supplied by adding the catalog suffix 'EHV'.

Ordering Instructions

Step 1: Catalog Number

Determine the assembly catalog number based on the conductor being used

Step 2: Extra High Voltage Finish

For Extra High Voltage Finish, use "EHV". (≥ 345 kV)

For Standard Finish, leave blank. (< 345 kV)

Step 3: Assemble Catalog Number

+

Example:

For 954 Cardinal ACSS/TW Conductor with an EHV finish, the complete catalog number is:

5630.125HTEHV

Notes:

1. Pad Dimensions are on page 339.
2. HiTemp AFL Filler Compound (AFCHT) Requirements are on page 342.
3. Bolt Sizes and Torque Recommendations are on page 342.
4. Installation Instructions for Terminals are on page 351.
5. For more information on die selection and ordering instructions, see the Tools and Equipment section of this catalog.

| CATALOG NUMBER | CONDUCTOR | | | | | DIE SIZE | WEIGHT | | TOTAL LENGTH L | | PAD SIZE |
|----------------|------------------|-------|------|-----------|----------|----------|--------|-----|----------------|-----|----------|
| | CODE NAME | SIZE | TYPE | STRANDING | DIAMETER | | LBS | KG | IN | MM | |
| | | KCMIL | | AL/ST | IN | | | | | | |
| 5620.781HT | Oriole/ACSS/TW | 336.4 | 23 | 18/7 | 0.693 | 20AH | 0.6 | 0.3 | 8.9 | 226 | D |
| 5624.938HT | Flicker/ACSS/TW | 477.0 | 13 | 18/7 | 0.776 | 24AH | 1.0 | 0.5 | 9.6 | 244 | D |
| 5624.938HT | Hawk/ACSS/TW | 477.0 | 16 | 18/7 | 0.789 | 24AH | 1.0 | 0.5 | 9.6 | 244 | D |
| 5624.938HT | Hen/ACSS/TW | 477.0 | 23 | 18/7 | 0.825 | 24AH | 1.0 | 0.5 | 9.6 | 244 | D |
| 5624.969HT | Parakeet/ACSS/TW | 556.5 | 13 | 18/7 | 0.835 | 24AH | 1.0 | 0.5 | 9.6 | 244 | D |
| 5624.969HT | Dove/ACSS/TW | 556.5 | 16 | 20/7 | 0.852 | 24AH | 1.0 | 0.5 | 9.6 | 244 | D |
| 5624.969HT | Calumet/ACSS/TW | 565.3 | 16 | 18/7 | 0.858 | 24AH | 1.0 | 0.5 | 9.6 | 244 | D |
| 5624.969HT | Mohawk/ACSS/TW | 571.7 | 13 | 18/7 | 0.846 | 24AH | 1.0 | 0.5 | 9.6 | 244 | D |
| 5627.106HT | Rook/ACSS/TW | 636.0 | 13 | 19/7 | 0.890 | 27AH | 2.2 | 1.0 | 17.1 | 434 | D |
| 5627.106HT | Grosbeak/ACSS/TW | 636.0 | 16 | 20/7 | 0.908 | 27AH | 2.2 | 1.0 | 17.1 | 434 | D |
| 5627.106HT | Scoter/ACSS/TW | 636.0 | 23 | 18/7 | 0.953 | 27AH | 2.2 | 1.0 | 17.1 | 434 | D |
| 5627.106HT | Oswego/ACSS/TW | 664.8 | 16 | 20/7 | 0.927 | 27AH | 2.2 | 1.0 | 17.1 | 434 | D |
| 5627.106HT | Mystic/ACSS/TW | 666.6 | 13 | 20/7 | 0.913 | 27AH | 2.2 | 1.0 | 17.1 | 434 | D |
| 5630.116HT | Wabash/ACSS/TW | 762.8 | 16 | 20/7 | 0.990 | 30AH | 2.9 | 1.3 | 18.6 | 472 | D |
| 5630.116HT | Maumee/ACSS/TW | 768.2 | 13 | 20/7 | 0.977 | 30AH | 2.9 | 1.3 | 18.6 | 472 | D |
| 5630.116HT | Tern/ACSS/TW | 795.0 | 7 | 17/7 | 0.960 | 30AH | 2.9 | 1.3 | 18.6 | 472 | D |
| 5630.116HT | Puffin/ACSS/TW | 795.0 | 10 | 18/7 | 0.980 | 30AH | 2.9 | 1.3 | 18.6 | 472 | D |
| 5630.116HT | Condor/ACSS/TW | 795.0 | 13 | 20/7 | 0.993 | 30AH | 2.9 | 1.3 | 18.6 | 472 | D |
| 5630.122HT | Drake/ACSS/TW | 795.0 | 16 | 20/7 | 1.010 | 30AH | 2.9 | 1.3 | 18.6 | 472 | D |
| 5630.122HT | Canary/ACSS/TW | 900.0 | 13 | 30/7 | 1.055 | 30AH | 2.8 | 1.3 | 18.8 | 477 | D |
| 5630.122HT | Fraser/ACSS/TW | 946.7 | 10 | 35/7 | 1.077 | 30AH | 2.8 | 1.3 | 18.8 | 477 | D |
| 5630.122HT | Phoenix/ACSS/TW | 954.0 | 5 | 30/7 | 1.044 | 30AH | 2.8 | 1.3 | 18.8 | 477 | D |
| 5630.122HT | Rail/ACSS/TW | 954.0 | 7 | 32/7 | 1.061 | 30AH | 2.8 | 1.3 | 18.8 | 477 | D |

HiTemp Connector—Straight for ACSS/TW Conductor, 5600HT Series (cont.)

ACCESSORIES
ACSS/TW

| CATALOG NUMBER | CONDUCTOR | | | | | DIE SIZE | WEIGHT | | TOTAL LENGTH L | | PAD SIZE |
|----------------|---------------------|--------|------|-----------|----------|----------|--------|-----|----------------|-----|----------|
| | CODE NAME | SIZE | TYPE | STRANDING | DIAMETER | | LBS | KG | IN | MM | |
| | | KCMIL | | AL/ST | IN | | | | | | |
| 5630.125HT | Cardinal/ACSS/TW | 954.0 | 13 | 20/7 | 1.084 | 30AH | 2.8 | 1.3 | 18.8 | 477 | D |
| 5630.122HT | Kettle/ACSS/TW | 957.2 | 7 | 32/7 | 1.060 | 30AH | 2.8 | 1.3 | 18.8 | 477 | D |
| 5630.122HT | Suwannee/ACSS/TW | 959.6 | 16 | 22/7 | 1.108 | 30AH | 2.8 | 1.3 | 18.8 | 477 | D |
| 5630.122HT | Columbia/ACSS/TW | 966.2 | 13 | 21/7 | 1.092 | 30AH | 2.8 | 1.3 | 18.8 | 477 | D |
| 5634.128HT | Snowbird/ACSS/TW | 1033.5 | 5 | 30/7 | 1.089 | 34AH | 4.2 | 1.9 | 19.3 | 490 | D |
| 5634.128HT | Ortolan/ACSS/TW | 1033.5 | 7 | 32/7 | 1.102 | 34AH | 4.2 | 1.9 | 19.3 | 490 | D |
| 5634.134HT | Curlew/ACSS/TW | 1033.5 | 13 | 22/7 | 1.128 | 34AH | 4.0 | 1.8 | 19.8 | 503 | D |
| 5634.128HT | — | 1080.0 | 7 | 20/7 | 1.131 | 34AH | 4.2 | 1.9 | 19.3 | 490 | D |
| 5634.128HT | Avocet/ACSS/TW | 1113.0 | 5 | 30/7 | 1.129 | 34AH | 4.2 | 1.9 | 19.3 | 490 | D |
| 5634.134HT | Bluejay/ACSS/TW | 1113.0 | 7 | 33/7 | 1.143 | 34AH | 4.0 | 1.8 | 19.8 | 503 | D |
| 5634.138HT | Finch/ACSS/TW | 1113.0 | 13 | 38/19 | 1.185 | 34AH | 4.0 | 1.8 | 20.0 | 508 | D |
| 5634.134HT | Genesee/ACSS/TW | 1158.0 | 7 | 33/7 | 1.165 | 34AH | 4.0 | 1.8 | 19.8 | 503 | D |
| 5634.138HT | Hudson/ACSS/TW | 1158.4 | 13 | 26/7 | 1.196 | 34AH | 4.0 | 1.8 | 20.0 | 508 | D |
| 5634.134HT | Cheyenne/ACSS/TW | 1168.1 | 5 | 30/7 | 1.155 | 34AH | 4.0 | 1.8 | 19.8 | 503 | D |
| 5634.138HT | Oxbird/ACSS/TW | 1192.5 | 5 | 30/7 | 1.167 | 34AH | 4.0 | 1.8 | 20.0 | 508 | D |
| 5634.138HT | Bunting/ACSS/TW | 1192.5 | 7 | 33/7 | 1.181 | 34AH | 4.0 | 1.8 | 20.0 | 508 | D |
| 5636.144HT | Grackle/ACSS/TW | 1192.5 | 13 | 38/19 | 1.225 | 36AH | 4.5 | 2.0 | 20.6 | 523 | D |
| 5634.138HT | Yukon/ACSS/TW | 1233.6 | 13 | 38/19 | 1.245 | 34AH | 4.0 | 1.8 | 20.0 | 508 | D |
| 5634.138HT | Nelson/ACSS/TW | 1257.1 | 7 | 35/7 | 1.213 | 34AH | 4.0 | 1.8 | 20.0 | 508 | D |
| 5636.144HT | Scissortail/ACSS/TW | 1272.0 | 5 | 30/7 | 1.202 | 36AH | 4.5 | 2.0 | 20.6 | 523 | D |
| 5634.138HT | Catawba/ACSS/TW | 1272.0 | 5 | 30/7 | 1.203 | 34AH | 4.0 | 1.8 | 20.0 | 508 | D |
| 5636.144HT | Bittern/ACSS/TW | 1272.0 | 7 | 35/7 | 1.220 | 36AH | 4.5 | 2.0 | 20.6 | 523 | D |
| 5636.147HT | Pheasant/ACSS/TW | 1272.0 | 13 | 39/19 | 1.264 | 36AH | 4.4 | 2.0 | 20.1 | 510 | D |
| 5636.144HT | Thames/ACSS/TW | 1334.6 | 13 | 39/19 | 1.290 | 36AH | 4.5 | 2.0 | 20.6 | 523 | D |
| 5636.147HT | Dipper/ACSS/TW | 1351.5 | 7 | 35/7 | 1.256 | 36AH | 4.4 | 2.0 | 20.1 | 510 | D |
| 5638.150HT | Martin/ACSS/TW | 1351.5 | 13 | 39/19 | 1.300 | 38AH | 5.4 | 2.5 | 21.1 | 536 | D |
| 5636.144HT | Mackenzie/ACSS/TW | 1359.7 | 7 | 36/7 | 1.259 | 36AH | 4.5 | 2.0 | 20.6 | 523 | D |
| 5634.138HT | Truckee/ACSS/TW | 1372.5 | 5 | 30/7 | 1.248 | 34AH | 4.0 | 1.8 | 20.0 | 508 | D |
| 5638.150HT | Bobolink/ACSS/TW | 1431.0 | 7 | 36/7 | 1.291 | 38AH | 5.4 | 2.5 | 21.1 | 536 | D |
| 5638.156HT | Plover/ACSS/TW | 1431.0 | 13 | 37/19 | 1.337 | 38AH | 5.1 | 2.3 | 21.9 | 556 | D |
| 5638.156HT | Merrimack/ACSS/TW | 1433.6 | 13 | 39/19 | 1.340 | 38AH | 5.1 | 2.3 | 21.9 | 556 | D |
| 5638.156HT | Miramichi/ACSS/TW | 1455.3 | 7 | 36/7 | 1.302 | 38AH | 5.1 | 2.3 | 21.9 | 556 | D |
| 5638.156HT | St. Croix/ACSS/TW | 1467.8 | 5 | 33/7 | 1.292 | 38AH | 5.1 | 2.3 | 21.9 | 556 | D |
| 5638.156HT | Rio Grande/ACSS/TW | 1533.3 | 13 | 39/19 | 1.382 | 38AH | 5.1 | 2.3 | 21.9 | 556 | D |
| 5638.156HT | Potomac/ACSS/TW | 1557.4 | 7 | 36/7 | 1.345 | 38AH | 5.1 | 2.3 | 21.9 | 556 | D |
| 5638.156HT | Platte/ACSS/TW | 1569.0 | 5 | 33/7 | 1.334 | 38AH | 5.1 | 2.3 | 21.9 | 556 | D |
| 5640.162HT | Lapwing/ACSS/TW | 1590.0 | 7 | 36/7 | 1.358 | 40AH | 5.9 | 2.7 | 22.6 | 574 | E |
| 5640.162HT | Falcon/ACSS/TW | 1590.0 | 13 | 42/19 | 1.408 | 40AH | 5.9 | 2.7 | 22.6 | 574 | E |
| 5640.162HT | Pecos/ACSS/TW | 1622.0 | 13 | 39/19 | 1.424 | 40AH | 5.9 | 2.7 | 22.6 | 574 | E |
| 5640.162HT | Schuylkill/ACSS/TW | 1657.4 | 7 | 36/7 | 1.386 | 40AH | 5.9 | 2.7 | 22.6 | 574 | E |
| 5642.168HT | James/ACSS/TW | 1730.6 | 13 | 34/19 | 1.470 | 42AH | 6.4 | 2.9 | 23.0 | 584 | E |
| 5640.162HT | Pee Dee/ACSS/TW | 1758.6 | 7 | 37/7 | 1.427 | 40AH | 5.9 | 2.7 | 22.6 | 574 | E |
| 5642.178HT | Chukar/ACSS/TW | 1780.0 | 8 | 37/19 | 1.445 | 42AH | 6.4 | 2.9 | 23.0 | 584 | E |
| 5642.178HT | Cumberland/ACSS/TW | 1926.9 | 13 | 42/19 | 1.545 | 42AH | 6.4 | 2.9 | 23.0 | 584 | E |
| 5642.178HT | Athabaska/ACSS/TW | 1949.6 | 7 | 42/7 | 1.504 | 42AH | 6.4 | 2.9 | 23.0 | 584 | E |
| 5644.184HT | Powder/ACSS/TW | 2153.8 | 8 | 64/19 | 1.602 | 44AH | 7.5 | 3.4 | 23.6 | 599 | E |
| 5644.184HT | Bluebird/ACSS/TW | 2156.0 | 8 | 64/19 | 1.608 | 44AH | 7.5 | 3.4 | 23.6 | 599 | E |
| 5648.191HT | Santee/ACSS/TW | 2627.3 | 8 | 64/19 | 1.762 | 48AH | 8.7 | 3.9 | 25.6 | 650 | E |

HiTemp Terminal Connector—15° for ACSS/TW Conductor, 5100HT Series

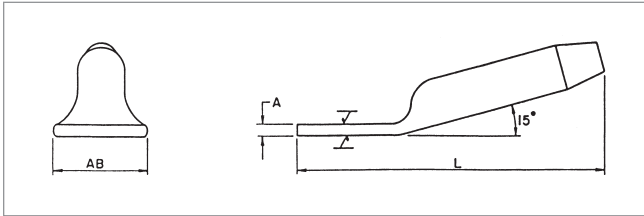

The 5100HT Series 15° Terminal Connector is specifically designed for ACSS/TW conductors. It is fabricated from a specially tempered aluminum that will transfer elevated current and dissipate increased heat more efficiently.

When used with the HiTemp Dead End, the 15° terminal connector can be bolted in either the straight or 30° position. All HiTemp Terminal Connectors are designed for limited tension use, maintaining a minimum of 40% of the ASTM rated strength of the conductor. Aluminum hardware is supplied with the 15° terminal connector.

Square edges of the compression accessory pad can cause Corona. Pads with rounded edges and corners can be supplied by adding the catalog suffix 'EHV'.

Ordering Instructions

Step 1: Catalog Number

Determine the assembly catalog number based on the conductor being used.

Step 2: Extra High Voltage Finish

For Extra High Voltage Finish, use "EHV". (≥ 345 kV)

For Standard Finish, leave blank. (< 345 kV)

Step 3: Assemble Catalog Number

Catalog Number + EHV Finish

Example:

For 954 Cardinal ACSS/TW Conductor with an EHV finish, the complete catalog number is:

5130.125HTEHV

Notes:

1. Pad Dimensions are on page 339.
2. HiTemp AFL Filler Compound (AFCHT) Requirements are on page 340.
3. Bolt Sizes and Torque Recommendations are on page 340.
4. Installation Instructions for Terminals are on page 351.
5. For more information on die selection and ordering instructions, see the Tools and

| CATALOG NUMBER | CONDUCTOR | | | | | DIE SIZE | WEIGHT | | TOTAL LENGTH L | | PAD SIZE |
|----------------|------------------|-------|------|-----------|----------|----------|--------|-----|----------------|-----|----------|
| | CODE NAME | SIZE | TYPE | STRANDING | DIAMETER | | LBS | KG | IN | MM | |
| | | KCMIL | | AL/ST | IN | | | | | | |
| 5120.781HT | Oriole/ACSS/TW | 336.4 | 23 | 18/7 | 0.693 | 20AH | 1.6 | 0.7 | 13.2 | 333 | D |
| 5124.938HT | Flicker/ACSS/TW | 477.0 | 13 | 18/7 | 0.776 | 24AH | 2.0 | 0.9 | 13.9 | 353 | D |
| 5124.938HT | Hawk/ACSS/TW | 477.0 | 16 | 18/7 | 0.789 | 24AH | 2.0 | 0.9 | 13.9 | 353 | D |
| 5124.938HT | Hen/ACSS/TW | 477.0 | 23 | 18/7 | 0.825 | 24AH | 2.0 | 0.9 | 13.9 | 353 | D |
| 5124.969HT | Parakeet/ACSS/TW | 556.5 | 13 | 18/7 | 0.835 | 24AH | 2.0 | 0.9 | 13.9 | 353 | D |
| 5124.969HT | Dove/ACSS/TW | 556.5 | 16 | 20/7 | 0.852 | 24AH | 2.0 | 0.9 | 13.9 | 353 | D |
| 5124.969HT | Calumet/ACSS/TW | 565.3 | 16 | 18/7 | 0.858 | 24AH | 2.0 | 0.9 | 13.9 | 353 | D |
| 5124.969HT | Mohawk/ACSS/TW | 571.7 | 13 | 18/7 | 0.846 | 24AH | 2.0 | 0.9 | 13.9 | 353 | D |
| 5127.106HT | Rook/ACSS/TW | 636.0 | 13 | 19/7 | 0.890 | 27AH | 2.4 | 1.1 | 16.3 | 414 | D |
| 5127.106HT | Grosbeak/ACSS/TW | 636.0 | 16 | 20/7 | 0.908 | 27AH | 2.4 | 1.1 | 16.3 | 414 | D |
| 5127.106HT | Scoter/ACSS/TW | 636.0 | 23 | 18/7 | 0.953 | 27AH | 2.4 | 1.1 | 16.3 | 414 | D |
| 5127.106HT | Oswego/ACSS/TW | 664.8 | 16 | 20/7 | 0.927 | 27AH | 2.4 | 1.1 | 16.3 | 414 | D |
| 5127.106HT | Mystic/ACSS/TW | 666.6 | 13 | 20/7 | 0.913 | 27AH | 2.4 | 1.1 | 16.3 | 414 | D |
| 5130.116HT | Wabash/ACSS/TW | 762.8 | 16 | 20/7 | 0.990 | 30AH | 3.3 | 1.5 | 17.8 | 452 | D |
| 5130.116HT | Maumee/ACSS/TW | 768.2 | 13 | 20/7 | 0.977 | 30AH | 3.3 | 1.5 | 17.8 | 452 | D |
| 5130.116HT | Tern/ACSS/TW | 795.0 | 7 | 17/7 | 0.960 | 30AH | 3.3 | 1.5 | 17.8 | 452 | D |
| 5130.116HT | Puffin/ACSS/TW | 795.0 | 10 | 18/7 | 0.980 | 30AH | 3.3 | 1.5 | 17.8 | 452 | D |
| 5130.116HT | Condor/ACSS/TW | 795.0 | 13 | 20/7 | 0.993 | 30AH | 3.3 | 1.5 | 17.8 | 452 | D |
| 5130.122HT | Drake/ACSS/TW | 795.0 | 16 | 20/7 | 1.010 | 30AH | 3.3 | 1.5 | 17.8 | 452 | D |
| 5130.122HT | Canary/ACSS/TW | 900.0 | 13 | 30/7 | 1.055 | 30AH | 3.1 | 1.4 | 18.1 | 460 | D |
| 5130.122HT | Fraser/ACSS/TW | 946.7 | 10 | 35/7 | 1.077 | 30AH | 3.1 | 1.4 | 18.1 | 460 | D |
| 5130.122HT | Phoenix/ACSS/TW | 954.0 | 5 | 30/7 | 1.044 | 30AH | 3.1 | 1.4 | 18.1 | 460 | D |
| 5130.122HT | Rail/ACSS/TW | 954.0 | 7 | 32/7 | 1.061 | 30AH | 3.1 | 1.4 | 18.1 | 460 | D |

HiTemp Terminal Connector—15° for ACSS/TW Conductor, 5100HT Series (cont.)

ACCESSORIES
ACSS/TW

| CATALOG NUMBER | CONDUCTOR | | | | | DIE SIZE | WEIGHT | | TOTAL LENGTH L | | PAD SIZE |
|----------------|---------------------|--------|------|-----------|----------|----------|--------|-----|----------------|-----|----------|
| | CODE NAME | SIZE | TYPE | STRANDING | DIAMETER | | LBS | KG | IN | MM | |
| | | KCMIL | | AL/ST | IN | | | | | | |
| 5130.125HT | Cardinal/ACSS/TW | 954.0 | 13 | 20/7 | 1.084 | 30AH | 3.1 | 1.4 | 18.3 | 465 | D |
| 5130.122HT | Kettle/ACSS/TW | 957.2 | 7 | 32/7 | 1.060 | 30AH | 3.1 | 1.4 | 18.1 | 460 | D |
| 5130.122HT | Suwannee/ACSS/TW | 959.6 | 16 | 22/7 | 1.108 | 30AH | 3.1 | 1.4 | 18.1 | 460 | D |
| 5130.122HT | Columbia/ACSS/TW | 966.2 | 13 | 21/7 | 1.092 | 30AH | 3.1 | 1.4 | 18.1 | 460 | D |
| 5134.128HT | Snowbird/ACSS/TW | 1033.5 | 5 | 30/7 | 1.089 | 34AH | 4.5 | 2.0 | 18.2 | 462 | D |
| 5134.128HT | Ortolan/ACSS/TW | 1033.5 | 7 | 32/7 | 1.102 | 34AH | 4.5 | 2.0 | 18.2 | 462 | D |
| 5134.134HT | Curlew/ACSS/TW | 1033.5 | 13 | 22/7 | 1.128 | 34AH | 4.4 | 2.0 | 18.3 | 465 | D |
| 5134.128HT | — | 1080.0 | 7 | 20/7 | 1.131 | 34AH | 4.5 | 2.0 | 18.1 | 460 | D |
| 5134.128HT | Avocet/ACSS/TW | 1113.0 | 5 | 30/7 | 1.129 | 34AH | 4.4 | 2.0 | 18.3 | 465 | D |
| 5134.134HT | Bluejay/ACSS/TW | 1113.0 | 7 | 33/7 | 1.143 | 34AH | 4.4 | 2.0 | 18.1 | 460 | D |
| 5134.138HT | Finch/ACSS/TW | 1113.0 | 13 | 38/19 | 1.185 | 34AH | 4.2 | 1.9 | 18.4 | 467 | D |
| 5134.134HT | Genesee/ACSS/TW | 1158.0 | 7 | 33/7 | 1.165 | 34AH | 4.4 | 2.0 | 18.3 | 465 | D |
| 5134.138HT | Hudson/ACSS/TW | 1158.4 | 13 | 26/7 | 1.196 | 34AH | 4.2 | 1.9 | 18.4 | 467 | D |
| 5134.134HT | Cheyenne/ACSS/TW | 1168.1 | 5 | 30/7 | 1.155 | 34AH | 4.4 | 2.0 | 18.3 | 465 | D |
| 5134.138HT | Oxbird/ACSS/TW | 1192.5 | 5 | 30/7 | 1.167 | 34AH | 4.2 | 1.9 | 18.4 | 467 | D |
| 5134.138HT | Bunting/ACSS/TW | 1192.5 | 7 | 33/7 | 1.181 | 34AH | 4.2 | 1.9 | 18.4 | 467 | D |
| 5136.144HT | Grackle/ACSS/TW | 1192.5 | 13 | 38/19 | 1.225 | 36AH | 4.7 | 2.1 | 19.1 | 485 | D |
| 5134.138HT | Yukon/ACSS/TW | 1233.6 | 13 | 38/19 | 1.245 | 34AH | 4.2 | 1.9 | 18.4 | 467 | D |
| 5134.138HT | Nelson/ACSS/TW | 1257.1 | 7 | 35/7 | 1.213 | 34AH | 4.2 | 1.9 | 18.4 | 468 | D |
| 5136.144HT | Scissortail/ACSS/TW | 1272.0 | 5 | 30/7 | 1.202 | 36AH | 4.7 | 2.1 | 19.1 | 485 | D |
| 5134.138HT | Catawba/ACSS/TW | 1272.0 | 5 | 30/7 | 1.203 | 34AH | 4.2 | 1.9 | 18.4 | 468 | D |
| 5136.144HT | Bittern/ACSS/TW | 1272.0 | 7 | 35/7 | 1.220 | 36AH | 4.7 | 2.1 | 19.1 | 485 | D |
| 5136.147HT | Pheasant/ACSS/TW | 1272.0 | 13 | 39/19 | 1.264 | 36AH | 4.7 | 2.1 | 19.0 | 483 | D |
| 5136.144HT | Thames/ACSS/TW | 1334.6 | 13 | 39/19 | 1.290 | 36AH | 4.7 | 2.1 | 19.1 | 485 | D |
| 5136.147HT | Dipper/ACSS/TW | 1351.5 | 7 | 35/7 | 1.256 | 36AH | 4.7 | 2.1 | 19.0 | 483 | D |
| 5138.150HT | Martin/ACSS/TW | 1351.5 | 13 | 39/19 | 1.300 | 38AH | 5.6 | 2.5 | 19.6 | 498 | D |
| 5136.144HT | Mackenzie/ACSS/TW | 1359.7 | 7 | 36/7 | 1.259 | 36AH | 4.7 | 2.1 | 19.1 | 485 | D |
| 5134.138HT | Truckee/ACSS/TW | 1372.5 | 5 | 30/7 | 1.248 | 34AH | 4.2 | 1.9 | 18.4 | 467 | D |
| 5138.150HT | Bobolink/ACSS/TW | 1431.0 | 7 | 36/7 | 1.291 | 38AH | 5.6 | 2.5 | 19.6 | 498 | D |
| 5138.156HT | Plover/ACSS/TW | 1431.0 | 13 | 37/19 | 1.337 | 38AH | 5.5 | 2.9 | 20.5 | 521 | D |
| 5138.156HT | Merrimack/ACSS/TW | 1433.6 | 13 | 39/19 | 1.340 | 38AH | 5.5 | 2.5 | 20.5 | 521 | D |
| 5138.156HT | Miramichi/ACSS/TW | 1455.3 | 7 | 36/7 | 1.302 | 38AH | 5.5 | 2.5 | 20.5 | 521 | D |
| 5138.156HT | St. Croix/ACSS/TW | 1467.8 | 5 | 33/7 | 1.292 | 38AH | 5.5 | 2.5 | 20.5 | 521 | D |
| 5138.156HT | Rio Grande/ACSS/TW | 1533.3 | 13 | 39/19 | 1.382 | 38AH | 5.5 | 2.5 | 20.5 | 521 | D |
| 5138.156HT | Potomac/ACSS/TW | 1557.4 | 7 | 36/7 | 1.345 | 38AH | 5.5 | 2.5 | 20.5 | 521 | D |
| 5138.156HT | Platte/ACSS/TW | 1569.0 | 5 | 33/7 | 1.334 | 38AH | 5.5 | 2.5 | 20.5 | 521 | D |
| 5140.162HT | Lapwing/ACSS/TW | 1590.0 | 7 | 36/7 | 1.358 | 40AH | 6.4 | 2.9 | 21.3 | 541 | E |
| 5140.162HT | Falcon/ACSS/TW | 1590.0 | 13 | 42/19 | 1.408 | 40AH | 6.4 | 2.9 | 21.3 | 541 | E |
| 5140.162HT | Pecos/ACSS/TW | 1622.0 | 13 | 39/19 | 1.424 | 40AH | 6.4 | 2.9 | 21.3 | 541 | E |
| 5140.162HT | Schuykill/ACSS/TW | 1657.4 | 7 | 36/7 | 1.386 | 40AH | 6.4 | 2.9 | 21.3 | 541 | E |
| 5142.168HT | James/ACSS/TW | 1730.6 | 13 | 34/19 | 1.470 | 42AH | 6.9 | 3.1 | 22.3 | 566 | E |
| 5140.162HT | Pee Dee/ACSS/TW | 1758.6 | 7 | 37/7 | 1.427 | 40AH | 6.0 | 2.7 | 21.3 | 541 | E |
| 5142.178HT | Chukar/ACSS/TW | 1780.0 | 8 | 37/19 | 1.445 | 42AH | 6.9 | 3.1 | 22.3 | 566 | E |
| 5142.178HT | Cumberland/ACSS/TW | 1926.9 | 13 | 42/19 | 1.545 | 42AH | 6.9 | 3.1 | 22.3 | 566 | E |
| 5142.178HT | Athabaska/ACSS/TW | 1949.6 | 7 | 42/7 | 1.504 | 42AH | 6.9 | 3.1 | 22.3 | 566 | E |
| 5144.184HT | Powder/ACSS/TW | 2153.8 | 8 | 64/19 | 1.602 | 44AH | 8.0 | 3.6 | 22.4 | 569 | E |
| 5144.184HT | Bluebird/ACSS/TW | 2156.0 | 8 | 64/19 | 1.608 | 44AH | 8.0 | 3.6 | 22.4 | 569 | E |
| 5148.191HT | Santee/ACSS/TW | 2627.3 | 8 | 64/19 | 1.762 | 48AH | 8.7 | 4.0 | 24.2 | 615 | E |

HiTemp Terminal Connector—90° for ACSS/TW Conductor, 5800HT Series

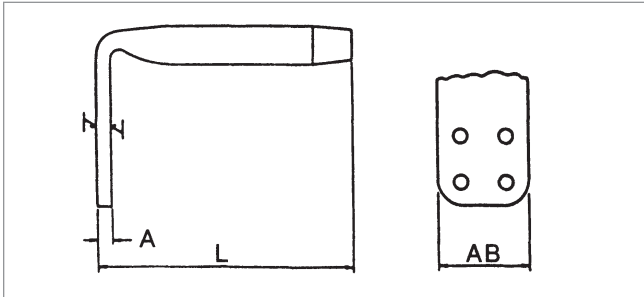

The 5800HT Series 90° Terminal Connector is specifically designed for ACSS/TW conductors. It is fabricated from a specially tempered aluminum that will transfer elevated current and dissipate increased heat more efficiently.

All HiTemp Terminal Connectors are designed for limited tension use, maintaining a minimum of 40% of the ASTM rated strength of the conductor.

Square edges of the compression accessory pad can cause Corona. Pads with rounded edges and corners can be supplied by adding the catalog suffix 'EHV'.

Ordering Instructions

Step 1: Catalog Number

Determine the assembly catalog number based on the conductor being used.

Step 2: Extra High Voltage Finish

For Extra High Voltage Finish, use "EHV". (≥ 345 kV)

For Standard Finish, leave blank. (< 345 kV)

Step 3: Assemble Catalog Number

+

Example:

For 954 Cardinal ACSS/TW Conductor with an EHV finish, the complete catalog number is:

5830.125HTEHV

Notes:

1. Pad Dimensions are on page 339.
2. HiTemp AFL Filler Compound (AFCHT) Requirements are on page 340.
3. Bolt Sizes and Torque Recommendations are on page 340.
4. Installation Instructions for Terminals are on page 351.
5. For more information on die selection and ordering instructions, see the Tools and Equipment section of this catalog.

HiTemp Terminal Connector—90° for ACSS/TW Conductor, 5800HT Series (cont.)

ACCESSORIES
ACSS/TW

| CATALOG NUMBER | CONDUCTOR | | | | | DIE SIZE | WEIGHT | | TOTAL LENGTH L | | DIE SIZE |
|----------------|------------------|--------|------|-----------|----------|----------|--------|-----|----------------|-----|----------|
| | CODE NAME | SIZE | TYPE | STRANDING | DIAMETER | | LBS | KG | IN | MM | |
| | | KCMIL | | AL/ST | IN | | | | | | |
| 5820.781HT | Oriole/ACSS/TW | 336.4 | 23 | 18/7 | 0.693 | 20AH | 1.3 | 0.6 | 10.8 | 274 | D |
| 5824.938HT | Flicker/ACSS/TW | 477.0 | 13 | 18/7 | 0.776 | 24AH | 2.0 | 0.9 | 11.4 | 290 | D |
| 5824.938HT | Hawk/ACSS/TW | 477.0 | 16 | 18/7 | 0.789 | 24AH | 2.0 | 0.9 | 11.4 | 290 | D |
| 5824.938HT | Hen/ACSS/TW | 477.0 | 23 | 18/7 | 0.825 | 24AH | 2.0 | 0.9 | 11.4 | 290 | D |
| 5824.969HT | Parakeet/ACSS/TW | 556.5 | 13 | 18/7 | 0.835 | 24AH | 2.0 | 0.9 | 11.4 | 290 | D |
| 5824.969HT | Dove/ACSS/TW | 556.5 | 16 | 20/7 | 0.852 | 24AH | 2.0 | 0.9 | 11.4 | 290 | D |
| 5824.969HT | Calumet/ACSS/TW | 565.3 | 16 | 18/7 | 0.858 | 24AH | 2.0 | 0.9 | 11.4 | 290 | D |
| 5824.969HT | Mohawk/ACSS/TW | 571.7 | 13 | 18/7 | 0.846 | 24AH | 2.0 | 0.9 | 11.4 | 290 | D |
| 5827.106HT | Rook/ACSS/TW | 636.0 | 13 | 19/7 | 0.890 | 27AH | 2.5 | 1.1 | 12.8 | 325 | D |
| 5827.106HT | Grosbeak/ACSS/TW | 636.0 | 16 | 20/7 | 0.908 | 27AH | 2.5 | 1.1 | 12.8 | 325 | D |
| 5827.106HT | Scoter/ACSS/TW | 636.0 | 23 | 18/7 | 0.953 | 27AH | 2.5 | 1.1 | 12.8 | 325 | D |
| 5827.106HT | Oswego/ACSS/TW | 664.8 | 16 | 20/7 | 0.927 | 27AH | 2.5 | 1.1 | 12.8 | 325 | D |
| 5827.106HT | Mystic/ACSS/TW | 666.6 | 13 | 20/7 | 0.913 | 27AH | 2.5 | 1.1 | 12.8 | 325 | D |
| 5830.116HT | Wabash/ACSS/TW | 762.8 | 16 | 20/7 | 0.990 | 30AH | 3.2 | 1.5 | 14.5 | 368 | D |
| 5830.116HT | Maumee/ACSS/TW | 768.2 | 13 | 20/7 | 0.977 | 30AH | 3.2 | 1.5 | 14.5 | 368 | D |
| 5830.116HT | Tern/ACSS/TW | 795.0 | 7 | 17/7 | 0.960 | 30AH | 3.2 | 1.5 | 14.5 | 368 | D |
| 5830.116HT | Puffin/ACSS/TW | 795.0 | 10 | 18/7 | 0.980 | 30AH | 3.2 | 1.5 | 14.5 | 368 | D |
| 5830.116HT | Condor/ACSS/TW | 795.0 | 13 | 20/7 | 0.993 | 30AH | 3.2 | 1.5 | 14.5 | 368 | D |
| 5830.122HT | Drake/ACSS/TW | 795.0 | 16 | 20/7 | 1.010 | 30AH | 3.2 | 1.5 | 14.5 | 368 | D |
| 5830.122HT | Canary/ACSS/TW | 900.0 | 13 | 30/7 | 1.055 | 30AH | 3.0 | 1.4 | 14.7 | 373 | D |
| 5830.122HT | Fraser/ACSS/TW | 946.7 | 10 | 35/7 | 1.077 | 30AH | 3.0 | 1.4 | 14.7 | 373 | D |
| 5830.122HT | Phoenix/ACSS/TW | 954.0 | 5 | 30/7 | 1.044 | 30AH | 3.0 | 1.4 | 14.7 | 373 | D |
| 5830.122HT | Rail/ACSS/TW | 954.0 | 7 | 32/7 | 1.061 | 30AH | 3.0 | 1.4 | 14.7 | 373 | D |
| 5830.125HT | Cardinal/ACSS/TW | 954.0 | 13 | 20/7 | 1.084 | 30AH | 3.0 | 1.4 | 14.7 | 373 | D |
| 5830.122HT | Kettle/ACSS/TW | 957.2 | 7 | 32/7 | 1.060 | 30AH | 3.0 | 1.4 | 14.7 | 373 | D |
| 5830.122HT | Suwannee/ACSS/TW | 959.6 | 16 | 22/7 | 1.108 | 30AH | 3.0 | 1.4 | 14.7 | 373 | D |
| 5830.122HT | Columbia/ACSS/TW | 966.2 | 13 | 21/7 | 1.092 | 30AH | 3.0 | 1.4 | 14.7 | 373 | D |
| 5834.128HT | Snowbird/ACSS/TW | 1033.5 | 5 | 30/7 | 1.089 | 34AH | 4.5 | 2.0 | 15.5 | 394 | D |
| 5834.128HT | Ortolan/ACSS/TW | 1033.5 | 7 | 32/7 | 1.102 | 34AH | 4.5 | 2.0 | 15.5 | 394 | D |
| 5834.134HT | Curlew/ACSS/TW | 1033.5 | 13 | 22/7 | 1.128 | 34AH | 4.3 | 2.0 | 15.5 | 394 | D |
| 5834.128HT | — | 1080.0 | 7 | 20/7 | 1.131 | 34AH | 4.5 | 2.0 | 15.5 | 394 | D |
| 5834.128HT | Avocet/ACSS/TW | 1113.0 | 5 | 30/7 | 1.129 | 34AH | 4.5 | 2.0 | 15.5 | 394 | D |
| 5834.134HT | Bluejay/ACSS/TW | 1113.0 | 7 | 33/7 | 1.143 | 34AH | 4.3 | 2.0 | 15.5 | 394 | D |
| 5834.138HT | Finch/ACSS/TW | 1113.0 | 13 | 38/19 | 1.185 | 34AH | 4.3 | 2.0 | 15.5 | 394 | D |
| 5834.134HT | Genesee/ACSS/TW | 1158.0 | 7 | 33/7 | 1.165 | 34AH | 4.3 | 2.0 | 15.5 | 394 | D |
| 5834.138HT | Hudson/ACSS/TW | 1158.4 | 13 | 26/7 | 1.196 | 34AH | 4.2 | 1.9 | 15.5 | 394 | D |
| 5834.134HT | Cheyenne/ACSS/TW | 1168.1 | 5 | 30/7 | 1.155 | 34AH | 4.3 | 2.0 | 15.5 | 394 | D |
| 5834.138HT | Oxbird/ACSS/TW | 1192.5 | 5 | 30/7 | 1.167 | 34AH | 4.2 | 1.9 | 15.5 | 394 | D |
| 5834.138HT | Bunting/ACSS/TW | 1192.5 | 7 | 33/7 | 1.181 | 34AH | 4.2 | 1.9 | 15.5 | 394 | D |
| 5836.144HT | Grackle/ACSS/TW | 1192.5 | 13 | 38/19 | 1.225 | 36AH | 4.7 | 2.1 | 16.1 | 409 | D |
| 5834.138HT | Yukon/ACSS/TW | 1233.6 | 13 | 38/19 | 1.245 | 34AH | 4.2 | 1.9 | 15.5 | 394 | D |
| 5834.138HT | Nelson/ACSS/TW | 1257.1 | 7 | 35/7 | 1.213 | 34AH | 4.2 | 1.9 | 15.5 | 394 | D |

HiTemp Terminal Connector—90° for ACSS/TW Conductor, 5800HT Series (cont.)

| CATALOG NUMBER | CODE NAME | CONDUCTOR | | | | DIE SIZE | WEIGHT | | TOTAL LENGTH L | | DIE SIZE |
|----------------|---------------------|-----------|------|-----------|----------|----------|--------|-----|----------------|-----|----------|
| | | SIZE | TYPE | STRANDING | DIAMETER | | LBS | KG | IN | MM | |
| | | KCMIL | | AL/ST | IN | | | | | | |
| 5836.144HT | Scissortail/ACSS/TW | 1272.0 | 5 | 30/7 | 1.202 | 36AH | 4.7 | 2.1 | 16.1 | 394 | D |
| 5834.138HT | Catawba/ACSS/TW | 1272.0 | 5 | 30/7 | 1.203 | 34AH | 4.2 | 1.9 | 15.5 | 394 | D |
| 5836.144HT | Bittern/ACSS/TW | 1272.0 | 7 | 35/7 | 1.220 | 36AH | 4.7 | 2.1 | 16.1 | 409 | D |
| 5836.147HT | Pheasant/ACSS/TW | 1272.0 | 13 | 39/19 | 1.264 | 36AH | 4.7 | 2.1 | 16.1 | 409 | D |
| 5836.144HT | Thames/ACSS/TW | 1334.6 | 13 | 39/19 | 1.290 | 36AH | 4.7 | 2.1 | 16.1 | 409 | D |
| 5836.147HT | Dipper/ACSS/TW | 1351.5 | 7 | 35/7 | 1.256 | 36AH | 4.7 | 2.1 | 16.1 | 409 | D |
| 5838.150HT | Martin/ACSS/TW | 1351.5 | 13 | 39/19 | 1.300 | 38AH | 5.5 | 2.5 | 16.6 | 422 | D |
| 5836.144HT | Mackenzie/ACSS/TW | 1359.7 | 7 | 36/7 | 1.259 | 36AH | 4.7 | 2.1 | 16.1 | 409 | D |
| 5834.138HT | Truckee/ACSS/TW | 1372.5 | 5 | 30/7 | 1.248 | 34AH | 4.2 | 1.9 | 15.5 | 394 | D |
| 5838.150HT | Bobolink/ACSS/TW | 1431.0 | 7 | 36/7 | 1.291 | 38AH | 5.5 | 2.5 | 16.6 | 422 | D |
| 5838.156HT | Plover/ACSS/TW | 1431.0 | 13 | 37/19 | 1.337 | 38AH | 5.4 | 2.5 | 17.6 | 447 | D |
| 5838.156HT | Merrimack/ACSS/TW | 1433.6 | 13 | 39/19 | 1.340 | 38AH | 5.4 | 2.5 | 17.6 | 447 | D |
| 5838.156HT | Miramichi/ACSS/TW | 1455.3 | 7 | 36/7 | 1.302 | 38AH | 5.4 | 2.5 | 17.6 | 447 | D |
| 5838.156HT | St. Croix/ACSS/TW | 1467.8 | 5 | 33/7 | 1.292 | 38AH | 5.4 | 2.5 | 17.6 | 447 | D |
| 5838.156HT | Rio Grande/ACSS/TW | 1533.3 | 13 | 39/19 | 1.382 | 38AH | 5.4 | 2.5 | 17.6 | 447 | D |
| 5838.156HT | Potomac/ACSS/TW | 1557.4 | 7 | 36/7 | 1.345 | 38AH | 5.4 | 2.5 | 17.6 | 447 | D |
| 5838.156HT | Platte/ACSS/TW | 1569.0 | 5 | 33/7 | 1.334 | 38AH | 5.4 | 2.5 | 17.6 | 447 | D |
| 5840.162HT | Lapwing/ACSS/TW | 1590.0 | 7 | 36/7 | 1.358 | 40AH | 6.1 | 2.8 | 17.3 | 439 | E |
| 5840.162HT | Falcon/ACSS/TW | 1590.0 | 13 | 42/19 | 1.408 | 40AH | 6.1 | 2.8 | 17.3 | 439 | E |
| 5840.162HT | Pecos/ACSS/TW | 1622.0 | 13 | 39/19 | 1.424 | 40AH | 6.1 | 2.8 | 17.3 | 439 | E |
| 5840.162HT | Schuykill/ACSS/TW | 1657.4 | 7 | 36/7 | 1.386 | 40AH | 6.1 | 2.8 | 17.3 | 439 | E |
| 5842.168HT | James/ACSS/TW | 1730.6 | 13 | 34/19 | 1.470 | 42AH | 7.0 | 3.2 | 17.3 | 439 | E |
| 5840.162HT | Pee Dee/ACSS/TW | 1758.6 | 7 | 37/7 | 1.427 | 40AH | 6.1 | 2.8 | 17.3 | 439 | E |
| 5842.178HT | Chukar/ACSS/TW | 1780.0 | 8 | 37/19 | 1.445 | 42AH | 7.0 | 3.2 | 18.5 | 470 | E |
| 5842.178HT | Cumberland/ACSS/TW | 1926.9 | 13 | 42/19 | 1.545 | 42AH | 7.0 | 3.2 | 18.5 | 470 | E |
| 5842.178HT | Athabaska/ACSS/TW | 1949.6 | 7 | 42/7 | 1.504 | 42AH | 7.0 | 3.2 | 18.5 | 470 | E |
| 5844.184HT | Powder/ACSS/TW | 2153.8 | 8 | 64/19 | 1.602 | 44AH | 8.4 | 3.8 | 18.7 | 475 | E |
| 5844.184HT | Bluebird/ACSS/TW | 2156.0 | 8 | 64/19 | 1.608 | 44AH | 8.4 | 3.8 | 18.7 | 475 | E |
| 5848.191HT | Santee/ACSS/TW | 2627.3 | 8 | 64/19 | 1.762 | 48AH | 10.6 | 4.8 | 20.3 | 516 | E |

ACSS/TW ACCESSORIES