

Quick Compress Dead Ends for Alumoweld® and Steel Ground Wire – GWDE Series

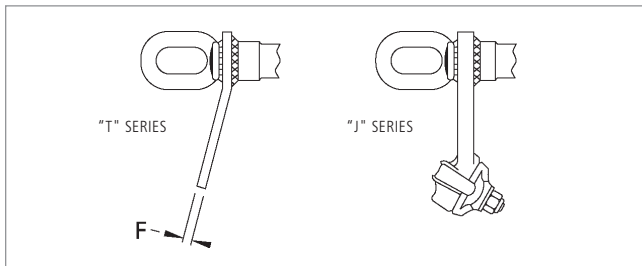
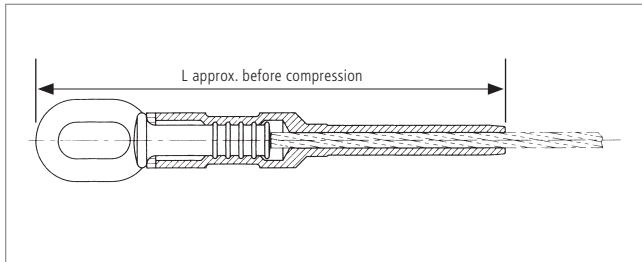

The Quick Compress GWDE Series Dead Ends are designed for fast and easy installation of Alumoweld® and Steel Ground Wire. By using a high strength alloy, the compression length has been shortened for less compression bites while maintaining a minimum of 95% of the ASTM rated strength. The steel eye is precompressed and the dead end is prefilled, eliminating installation steps.

Ordering Instructions

Step 1: Assembly Catalog Number

Determine the assembly catalog number based on the cable being used.

Step 2: Steel Eye Orientation

For an assembly with a vertical eye, use prefix 'V'.

For an assembly with a horizontal eye, use prefix 'H'.

Step 3: Tongue or Bolted Jumper

For an assembly with a tongue, use suffix 'T'.

For an assembly with a bolted jumper, use suffix 'J'.

For no tongue or bolted jumper, leave blank

Step 4: Assemble Catalog Number.



Example:

For a vertical eye dead end with a bolted jumper for 7 No. 10 Alumoweld, the complete catalog number is:

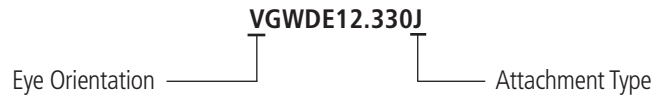

Notes:

1. For Alumoweld® wire specifications, see the AFL Wire Products catalog.
2. Installation instructions for GW series dead ends are on page 267.
3. For more information on die selection and ordering instructions, see Tools and Equipment section in this catalog.

Quick Compress Dead Ends for Alumoweld® and Steel Ground Wire – GWDE Series (cont.)

ASSEMBLY CATALOG NUMBER	CONDUCTOR		DIMENSIONS				JUMPER DIAMETER RANGE J SERIES		DIE SIZE	GWDE SERIES		GWDE-T SERIES		GWDE-J SERIES	
	SIZE	DIAM-ETER	L		F		IN	MM		TOTAL WEIGHT		TOTAL WEIGHT		TOTAL WEIGHT	
			IN	MM	IN	MM				LBS	KG	LBS	KG	LBS	KG
ALUMOWELD®															
GWDE10.251	3 No. 10	0.220	10.4	264	0.5	13	0.162-0.327	4.1-8.3	6010GW	0.7	0.34	1.2	0.54	1.1	0.50
GWDE10.281	3 No. 9	0.247	10.4	264	0.5	13	0.162-0.327	4.1-8.3	6010GW	0.7	0.34	1.2	0.54	1.1	0.50
GWDE10.295	3 No. 8	0.277	10.8	274	0.5	13	0.277-0.625	7.0-15.9	6010GW	0.7	0.34	1.2	0.54	2.2	1.00
GWDE10.324	3 No. 7	0.311	11.3	287	0.5	13	0.277-0.625	7.0-15.9	6010GW	0.8	0.34	1.2	0.54	2.2	1.00
GWDE12.351	3 No. 6	0.349	12.4	315	0.5	13	0.277-0.625	7.0-15.9	6012GW	1.4	0.64	1.9	0.86	2.4	1.09
GWDE14.406	3 No. 5	0.392	12.6	321	0.5	13	0.277-0.625	7.0-15.9	6014GW	1.9	0.86	2.4	1.08	2.9	1.31
GWDE12.330	7 No. 10	0.306	11.2	284	0.5	13	0.277-0.625	7.0-15.9	6012GW	1.4	0.64	1.9	0.86	2.4	1.09
GWDE12.359	7 No. 9	0.343	12.4	315	0.5	13	0.277-0.625	7.0-15.9	6012GW	1.4	0.64	1.9	0.86	2.4	1.09
GWDE14.406	7No. 8	0.385	12.6	321	0.5	13	0.277-0.625	7.0-15.9	6014GW	1.9	0.86	2.4	1.08	2.9	1.31
GWDE16.484	7 No. 7	0.433	13.2	335	0.5	13	0.277-0.625	7.0-15.9	6016GW	2.1	0.95	2.6	1.18	3.1	1.41
GWDE16.531	7 No. 6	0.486	15.8	400	0.6	16	0.277-0.625	7.0-15.9	6016GW	3.9	1.77	4.8	2.18	4.8	2.18
GWDE18.594	7 No. 5	0.546	15.7	399	0.6	16	0.464-0.742	11.8-18.9	6018GW	4.0	1.81	4.9	2.22	4.9	2.22
GWDE18.530	19 No. 10	0.509	15.7	399	0.6	16	0.464-0.743	11.8-18.9	6018GW	4.0	1.81	4.9	2.22	4.9	2.22
STEEL GROUND WIRE															
GWDE12.332	5/16" EHS	0.312	12.3	313	0.5	13	0.277-0.625	7.0-15.9	6012GW	1.4	0.64	1.9	0.86	2.4	1.09
GWDE14.386	3/8" EHS	0.360	14.3	362	0.5	13	0.277-0.625	7.0-15.9	6014GW	2.1	0.95	2.6	1.18	3.0	1.35
GWDE16.453	7/16" EHS	0.435	15.0	381	0.5	13	0.277-0.625	7.0-15.9	6016GW	2.2	1.00	2.7	1.22	3.2	1.45
GWDE18.531	1/2" EHS	0.495	18.7	475	0.6	16	0.464-0.743	11.8-18.9	6018GW	4.3	1.95	5.2	2.36	5.2	2.36

GROUND WIRE ACCESSORIES

Quick Compress Dead Ends GWDE Series (cont.) Steel Eye Dimensions

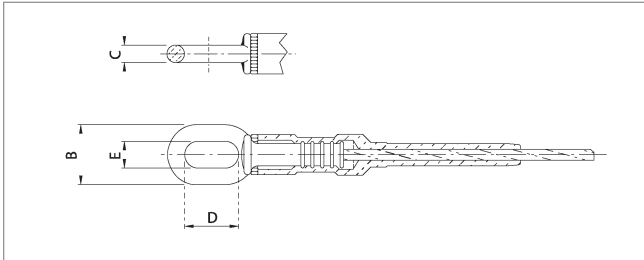

ASSEMBLY CATALOG NUMBER	CONDUCTOR SIZE	DIMENSIONS							
		B		C		D		E	
		IN	MM	IN	MM	IN	MM	IN	MM
ALUMOWELD®									
GWDE10.251	3 No. 10	2.2	57	0.6	16	2.0	51	1.0	25
GWDE10.281	3 No. 9	2.0	52	0.5	13	2.0	51	1.0	25
GWDE10.295	3 No. 8	1.8	46	0.4	10	2.0	51	1.0	25
GWDE10.324	3 No. 7	1.8	46	0.4	10	2.0	51	1.0	25
GWDE12.351	3 No. 6	1.8	46	0.4	10	2.0	51	1.0	25
GWDE14.406	3 No. 7	1.8	46	0.4	10	2.0	51	1.0	25
GWDE12.330	7 No. 10	2.8	71	0.8	20	2.5	64	1.2	31
GWDE12.359	7 No. 9	2.8	71	0.8	20	2.5	64	1.2	31
GWDE14.406	7 No. 8	2.2	57	0.6	16	2.0	51	1.0	25
GWDE16.484	7 No. 7	2.2	57	0.6	16	2.0	51	1.0	25
GWDE16.531	7 No. 6	2.0	52	0.5	13	2.0	51	1.0	25
GWDE18.594	7 No. 5	2.0	52	0.5	13	2.0	51	1.0	25
GWDE18.530	19 No. 10	2.8	71	0.8	20	2.5	64	1.2	31
STEEL GROUND WIRE									
GWDE12.332	5/16" EHS	2.0	52	0.5	13	2.0	51	1.0	25
GWDE14.386	3/8" EHS	2.2	57	0.6	16	2.0	51	1.0	25
GWDE16.453	7/16" EHS	2.2	57	0.6	16	2.0	51	1.0	25
GWDE18.531	1/2" EHS	2.8	71	0.8	20	2.5	64	1.2	31