

Quick Compress Terminal for AAAC and ACAR Conductor, Straight, TS Series

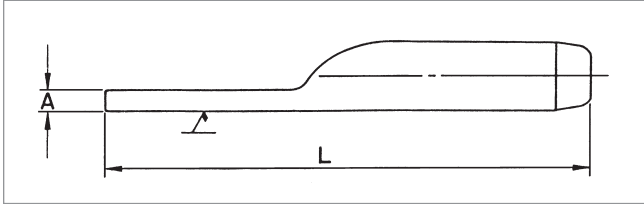

The TS Series Straight Terminal Connector is designed for fast and easy installation. By using a high strength alloy, the compression length has been shortened for less compression bites. The terminal connector is pre-filled, eliminating an installation step.

All TS Series connectors are designed for limited tension use, maintaining a minimum of 40% of the ASTM rated strength of the conductor.

The end tapers of all compression accessories are supplied with a High Voltage finish for die size sections 12CD and above.

The square edges of bolted pads of the compression accessories could cause Corona. Pads with edges and corners rounded can be supplied by adding the catalog suffix 'EHV'.

Ordering Instructions

Step 1: Catalog Number

Determine the catalog number based on the conductor being used.

Step 2: Extra High Voltage Finish

For Extra High Voltage Finish, use 'EHV'. (≥ 345 kV)

For Standard Finish, leave blank. (< 345 kV)

Step 3: Assemble Catalog Number.



Example:

A straight terminal for 927.7 Greeley with an B pad and EHV finish, the complete catalog number is:

TS12EHV

Notes:

1. Pad Dimensions are on page 257.
2. Installation Instructions for Terminals are on page 272.
3. Bolts, nuts and washers are not supplied with TS Series Terminal Connectors.
4. For more information on die selection and ordering instructions, see Tools and Equipment tab in this catalog.

Quick Compress Terminal for AAAC and ACAR Conductor, Straight, TS Series (cont.)

CATALOG NUMBER	CONDUCTOR			DIE SIZE	TOTAL WEIGHT		DIMENSION				PAD SIZE
	CODE WORD	SIZE	DIAMETER		LBS	KG	A		L		
		KCMIL	IN				IN	MM	IN	MM	
TS07	—	281.4	0.609	07CD	0.5	0.20	0.3	8	9.0	229	B
TS07	Butte	312.8	0.642	07CD	0.5	0.20	0.3	8	9.0	229	B
TS08	—	355.1	0.684	08CD	0.6	0.28	0.4	10	9.6	244	B
TS08	Canton	394.5	0.721	08CD	0.6	0.28	0.4	10	9.6	244	B
TS08	—	419.6	0.743	08CD	0.6	0.28	0.4	10	9.6	244	B
TS09	Cairo	465.4	0.783	09CD	0.8	0.38	0.4	11	10.0	254	B
TS09	—	503.6	0.814	09CD	0.8	0.38	0.4	11	10.0	254	B
TS10	Darien	559.5	0.858	10CD	1.1	0.50	0.5	12	10.6	269	B
TS10	—	587.2	0.879	10CD	1.1	0.50	0.5	12	10.6	269	B
TS10	—	634.9	0.914	10CD	1.1	0.50	0.5	12	10.6	269	B
TS10	—	649.5	0.928	10CD	1.1	0.50	0.5	12	10.6	269	B
TS10	Elgin	652.4	0.927	10CD	1.1	0.50	0.5	12	10.6	269	B
TS10	—	657.3	0.930	10CD	1.1	0.50	0.5	12	10.6	269	B
TS11	Flint	740.8	0.991	11CD	1.5	0.68	0.4	9	11.7	297	D
TS12	—	853.7	1.063	12CD	1.8	0.82	0.4	11	12.1	307	D
TS12	Greeley	927.2	1.108	12CD	1.8	0.82	0.4	11	12.1	307	D
TS13	—	1024.5	1.165	13CD	2.1	0.95	0.5	13	12.8	325	D
TS13	—	1080.6	1.196	13CD	2.1	0.95	0.5	13	12.8	325	D
TS13	—	1108.6	1.212	13CD	2.1	0.95	0.5	13	12.8	325	D
TS14	—	1172.3	1.246	14CD	2.7	1.22	0.6	16	13.8	351	D
TS16	—	1534.0	1.427	16CD	3.8	1.72	0.7	17	14.6	371	D
TS16	—	1700.0	1.502	16CD	3.8	1.72	0.7	17	14.6	371	D
TS19	—	2303.5	1.750	19CD	6.5	2.95	0.9	22	17.5	445	E
TS19	—	2338.0	1.762	19CD	6.5	2.95	0.9	22	17.5	445	E
TS20	—	2493.0	1.821	20CD	7.3	3.31	0.9	22	17.9	455	E

AAAC & ACAR ACCESSORIES

Quick Compress Terminal for AAAC and ACAR Conductor, 15°, TF Series

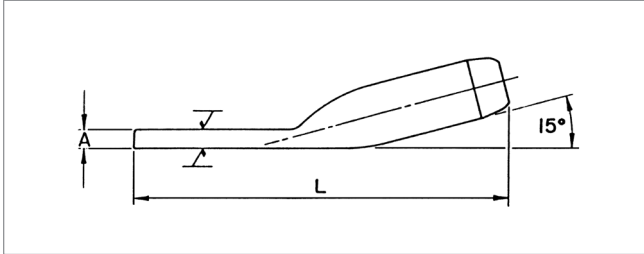

The TF Series 15° Terminal Connector is designed for fast and easy installation. By using a high strength alloy, the compression length has been shortened for less compression bites. The terminal connector is pre-filled, eliminating an installation step.

When used with the Quick Compress dead end, the TF Series connectors can be bolted in either straight or 30° position. All TF Series connectors are designed for limited tension use, maintaining a minimum of 40% of the ASTM rated strength of the conductor.

The end tapers of all compression accessories are supplied with a High Voltage finish for die size sections 12CD and above.

The square edges of bolted pads of the compression accessories could cause Corona. Pads with edges and corners rounded can be supplied by adding the catalog suffix 'EHV'.

Ordering Instructions

Step 1: Catalog Number

Determine the catalog number based on the conductor being used.

Step 2: Extra High Voltage Finish

For Extra High Voltage Finish, use 'EHV'. (≥ 345 kV)

For Standard Finish, leave blank. (< 345 kV)

Step 3: Assemble Catalog Number.



Example:

A 15° terminal for 927.7 Greeley with an B pad and EHV finish, the complete catalog number is:

TF12EHV

Notes:

1. Pad Dimensions are on page 257.
2. Installation Instructions for Terminals are on page 272.
3. Bolts, nuts and washers are supplied with TF Series Terminal Connectors.
4. For more information on die selection and ordering instructions, see Tools and Equipment tab in this catalog.

Quick Compress Terminal for AAAC and ACAR Conductor, 15°, TF Series (cont.)

CATALOG NUMBER	CONDUCTOR			DIE SIZE	TOTAL WEIGHT		DIMENSIONS				PAD SIZE
	CODE WORD	SIZE	DIAMETER		LBS	KG	A		L		
		KCMIL	IN				IN	MM	IN	MM	
TF07	—	281.4	0.609	07CD	0.5	0.24	0.3	8	7.8	196	B
TF07	Butte	312.8	0.642	07CD	0.5	0.24	0.3	8	7.8	196	B
TF08	—	355.1	0.684	08CD	0.7	0.31	0.4	10	8.3	211	B
TF08	Canton	394.5	0.721	08CD	0.7	0.31	0.4	10	8.3	211	B
TF08	—	419.6	0.743	08CD	0.7	0.31	0.4	10	8.3	211	B
TF09	Cairo	465.4	0.783	09CD	0.9	0.40	0.4	11	8.9	226	B
TF09	—	503.6	0.814	09CD	0.9	0.40	0.4	11	8.9	226	B
TF10	Darien	559.5	0.858	10CD	1.1	0.50	0.5	12	9.4	239	B
TF10	—	587.2	0.879	10CD	1.1	0.50	0.5	12	9.4	239	B
TF10	—	634.9	0.914	10CD	1.1	0.50	0.5	12	9.4	239	B
TF10	—	649.5	0.928	10CD	1.1	0.50	0.5	12	9.4	239	B
TF10	Elgin	652.4	0.927	10CD	1.1	0.50	0.5	12	9.4	239	B
TF10	—	657.3	0.930	10CD	1.1	0.50	0.5	12	9.4	239	B
TF11	Flint	740.8	0.991	11CD	1.5	0.68	0.4	9	10.4	264	D
TF12	—	853.7	1.063	12CD	1.9	0.86	0.4	11	11.0	279	D
TF12	Greeley	927.2	1.108	12CD	1.9	0.86	0.4	11	11.0	279	D
TF13	—	1024.5	1.165	13CD	2.2	1.00	0.5	13	11.2	284	D
TF13	—	1080.6	1.196	13CD	2.2	1.00	0.5	13	11.2	284	D
TF13	—	1108.6	1.212	13CD	2.2	1.00	0.5	13	11.2	284	D
TF14	—	1172.3	1.246	14CD	2.8	1.27	0.6	16	12.0	305	D
TF16	—	1534.0	1.427	16CD	3.7	1.69	0.7	17	13.3	338	D
TF16	—	1700.0	1.502	16CD	3.7	1.69	0.7	17	13.3	338	D
TF19	—	2303.5	1.750	19CD	6.3	2.86	0.9	22	15.7	399	E
TF19	—	2338.0	1.762	19CD	6.3	2.86	0.9	22	15.7	399	E
TF20	—	2493.0	1.821	20CD	6.8	3.08	0.9	22	16.0	406	E

AAAC & ACAR ACCESSORIES

Quick Compress Terminal for AAAC and ACAR Conductor, 45°, T45 Series

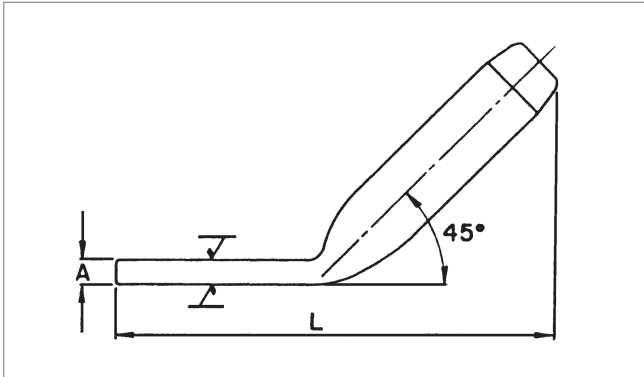

The T45 Series 45° Terminal Connector is designed for fast and easy installation. By using a high strength alloy, the compression length has been shortened for less compression bites. The terminal connector is pre-filled, eliminating an installation step. All T45 Series connectors are designed for limited tension use, maintaining a minimum of 40% of the ASTM rated strength of the conductor.

The end tapers of all compression accessories are supplied with a High Voltage finish for die size sections 12CD and above. The square edges of bolted pads of the compression accessories could cause Corona. Pads with edges and corners rounded can be supplied by adding the catalog suffix 'EHV'.

Ordering Instructions

Step 1: Catalog Number

Determine the catalog number based on the conductor being used.

Step 2: Extra High Voltage Finish

For Extra High Voltage Finish, use 'EHV'. (≥ 345 kV)

For Standard Finish, leave blank. (< 345 kV)

Step 3: Assemble Catalog Number.



Example:

A 45° terminal for 927.7 Greeley with an B pad and EHV finish, the complete catalog number is:

T4512EHV

Notes:

1. Pad Dimensions are on page 257.
2. Installation Instructions for Terminals are on page 272.
3. Bolts, nuts and washers are not supplied with T45 Series Terminal Connectors.
4. For more information on die selection and ordering instructions, see Tools and Equipment tab in this catalog.

Quick Compress Terminal for AAAC and ACAR Conductor, 45°, T45 Series (cont.)

CATALOG NUMBER	CONDUCTOR			DIE SIZE	TOTAL WEIGHT		DIMENSIONS				PAD SIZE
	CODE WORD	SIZE	DIAMETER		LBS	KG	A		L		
		KCMIL	IN				IN	MM	IN	MM	
T4507	—	281.4	0.609	07CD	0.4	0.19	0.3	8	7.3	185	B
T4507	Butte	312.8	0.642	07CD	0.4	0.19	0.3	8	7.3	185	B
T4508	—	355.1	0.684	08CD	0.6	0.25	0.4	10	7.8	198	B
T4508	Canton	394.5	0.721	08CD	0.6	0.25	0.4	10	7.8	198	B
T4508	—	419.6	0.743	08CD	0.6	0.25	0.4	10	7.8	198	B
T4509	Cairo	465.4	0.783	09CD	0.8	0.34	0.4	11	8.2	208	B
T4509	—	503.6	0.814	09CD	0.8	0.34	0.4	11	8.2	208	B
T4510	Darien	559.5	0.858	10CD	1.0	0.45	0.5	12	8.6	218	B
T4510	—	587.2	0.879	10CD	1.0	0.45	0.5	12	8.6	218	B
T4510	—	634.9	0.914	10CD	1.0	0.45	0.5	12	8.6	218	B
T4510	—	649.5	0.928	10CD	1.0	0.45	0.5	12	8.6	218	B
T4510	Elgin	652.4	0.927	10CD	1.0	0.45	0.5	12	8.6	218	B
T4510	—	657.3	0.930	10CD	1.0	0.45	0.5	12	8.6	218	B
T4511	Flint	740.8	0.991	11CD	1.3	0.59	0.4	9	9.4	239	D
T4512	—	853.7	1.063	12CD	1.6	0.73	0.4	11	9.7	246	D
T4512	Greeley	927.2	1.108	12CD	1.6	0.73	0.4	11	9.7	246	D
T4513	—	1024.5	1.165	13CD	2.0	0.91	0.5	13	10.2	259	D
T4513	—	1080.6	1.196	13CD	2.0	0.91	0.5	13	10.2	259	D
T4513	—	1108.6	1.212	13CD	2.0	0.91	0.5	13	10.2	259	D
T4514	—	1172.3	1.246	14CD	2.3	1.04	0.6	16	10.6	269	D
T4516	—	1534.0	1.427	16CD	3.4	1.54	0.7	17	11.0	279	D
T4516	—	1700.0	1.502	16CD	3.4	1.54	0.7	17	11.0	279	D
T4519	—	2303.5	1.750	19CD	5.7	2.59	0.9	22	13.7	348	E
T4519	—	2338.0	1.762	19CD	5.7	2.59	0.9	22	13.7	348	E
T4520	—	2493.0	1.821	20CD	6.5	2.95	0.9	22	14.2	361	E

AAAC & ACAR ACCESSORIES

Quick Compress Terminal for AAAC and ACAR Conductor, 90°, TN Series

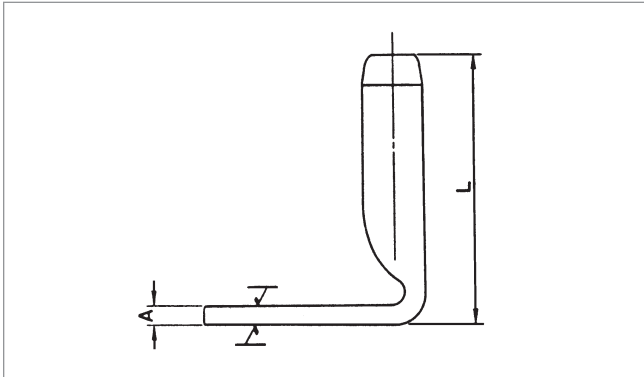

The TN Series 90° Terminal Connector is designed for fast and easy installation. By using a high strength alloy, the compression length has been shortened for less compression bites. The terminal connector is pre-filled, eliminating an installation step.

All TN Series connectors are designed for limited tension use, maintaining a minimum of 40% of the ASTM rated strength of the conductor.

The end tapers of all compression accessories are supplied with a High Voltage finish for die size sections 12CD and above.

The square edges of bolted pads of the compression accessories could cause Corona. Pads with edges and corners rounded can be supplied by adding the catalog suffix 'EHV'.

Ordering Instructions

Step 1: Catalog Number

Determine the catalog number based on the conductor being used.

Step 2: Extra High Voltage Finish

For Extra High Voltage Finish, use 'EHV'. (≥ 345 kV)

For Standard Finish, leave blank. (< 345 kV)

Step 3: Assemble Catalog Number.



Example:

A 90° terminal for 927.7 Greeley with an B pad and EHV finish, the complete catalog number is:

TN12EHV

Notes:

1. Pad Dimensions are on page 257.
2. Installation Instructions for Terminals are on page 272.
3. Bolts, nuts and washers are not supplied with TN Series Terminal Connectors.
4. For more information on die selection and ordering instructions, see Tools and Equipment tab in this catalog.

Quick Compress Terminal for AAAC and ACAR Conductor, 90°, TN Series (cont.)

CATALOG NUMBER	CONDUCTOR			DIE SIZE	TOTAL WEIGHT		DIMENSIONS				PAD SIZE
	CODE WORD	SIZE	DIAMETER		LBS	KG	A		L		
		KCMIL	IN				IN	MM	IN	MM	
TN07	—	281.4	0.609	07CD	0.5	0.20	0.3	8	5.2	132	B
TN07	Butte	312.8	0.642	07CD	0.5	0.20	0.3	8	5.2	132	B
TN08	—	355.1	0.684	08CD	0.6	0.29	0.4	10	5.7	145	B
TN08	Canton	394.5	0.721	08CD	0.6	0.29	0.4	10	5.7	145	B
TN08	—	419.6	0.743	08CD	0.6	0.29	0.4	10	5.7	145	B
TN09	Cairo	465.4	0.783	09CD	0.8	0.38	0.4	11	6.2	157	B
TN09	—	503.6	0.814	09CD	0.8	0.38	0.4	11	6.2	157	B
TN10	Darien	559.5	0.858	10CD	1.1	0.50	0.5	12	6.7	170	B
TN10	—	587.2	0.879	10CD	1.1	0.50	0.5	12	6.7	170	B
TN10	—	634.9	0.914	10CD	1.1	0.50	0.5	12	6.7	170	B
TN10	—	649.5	0.928	10CD	1.1	0.50	0.5	12	6.7	170	B
TN10	Elgin	652.4	0.927	10CD	1.1	0.50	0.5	12	6.7	170	B
TN10	—	657.3	0.930	10CD	1.1	0.50	0.5	12	6.7	170	B
TN11	Flint	740.8	0.991	11CD	1.4	0.64	0.4	9	7.5	191	D
TN12	—	853.7	1.063	12CD	1.8	0.82	0.4	11	7.9	202	D
TN12	Greeley	927.2	1.108	12CD	1.8	0.82	0.4	11	7.9	202	D
TN13	—	1024.5	1.165	13CD	2.2	1.00	0.5	13	8.5	216	D
TN13	—	1080.6	1.196	13CD	2.2	1.00	0.5	13	8.5	216	D
TN13	—	1108.6	1.212	13CD	2.2	1.00	0.5	13	8.5	216	D
TN14	—	1172.3	1.246	14CD	2.6	1.18	0.6	16	9.2	233	D
TN16	—	1534.0	1.427	16CD	3.7	1.68	0.7	17	10.2	259	D
TN16	—	1700.0	1.502	16CD	3.7	1.68	0.7	17	10.2	259	D
TN19	—	2303.5	1.750	19CD	6.1	2.77	0.9	22	11.9	303	E
TN19	—	2338.0	1.762	19CD	6.1	2.77	0.9	22	11.9	303	E
TN20	—	2493.0	1.821	20CD	6.9	3.13	0.9	22	12.6	321	E

AAAC & ACAR ACCESSORIES