

Terminal Connectors—5600 Series for ACSR Conductors, Straight

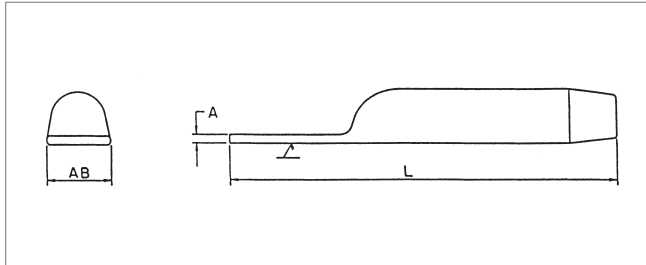

The 5600 Series Straight Terminal Connector is designed for ACSR conductors. The terminal connector is fabricated from AFL seamless drawn aluminum.

When used with the dead end, the straight terminal connector allows drop at a 15° angle. All terminal connectors are designed for limited tension use, maintaining a minimum of 40% of the ASTM rated strength of the conductor on which it is being used.

Ordering Instructions

Step 1: Assembly Catalog Number

Determine the assembly catalog number based on the conductor being used.

Step 2: Extra High Voltage Finish

For Extra High Voltage Finish, use 'EHV'.
For Standard Finish, leave blank.

Step 3: Assemble Catalog Number.



Example:

For 795 Drake conductor with an EHV finish, the complete catalog number is:

5630.116EHV

TERMINAL CATALOG NUMBER	CONDUCTOR				DIE SIZE ALUMINUM HEX DIE	TOTAL WEIGHT		DIMENSION						PAD SIZE
	CODE WORD	SIZE	STRANDING	DIA.				L		A		AB		
		KCMIL	AL/ST	IN	LBS	KG	IN	MM	IN	MM	IN	MM		
5674.438	Raven	1/0	6/1	0.398	74AH	0.3	0.14	8.3	211	0.3	9	1.0	25	B
5674.484	Quail	2/0	6/1	0.447	74AH	0.3	0.12	8.3	211	0.3	8	1.0	25	B
5675.547	Pigeon	3/0	6/1	0.502	75AH	0.5	0.23	9.5	241	0.5	13	1.0	25	B
5675.609	Penguin	4/0	6/1	0.563	75AH	0.5	0.20	9.8	248	0.5	12	1.0	25	B
5676.656	Waxwing	266.8	18/1	0.609	76AH	0.8	0.38	10.4	265	0.6	15	1.3	32	B
5676.688	Owl	266.8	6/7	0.633	76AH	0.8	0.37	10.6	268	0.6	14	1.3	32	B
5676.688	Partridge	266.8	26/7	0.642	76AH	0.8	0.37	10.6	268	0.6	14	1.3	32	B
5676.719	Ostrich	300.0	26/7	0.680	76AH	0.8	0.36	10.7	272	0.5	13	1.3	32	B
5676.719	Merlin	336.4	18/1	0.684	76AH	0.8	0.36	10.7	272	0.5	13	1.3	32	B
5676.781	Linnet	336.4	26/7	0.720	76AH	0.7	0.33	10.9	278	0.5	12	1.3	32	B
5676.781	Chickadee	397.5	18/1	0.743	76AH	0.7	0.33	10.9	278	0.5	12	1.3	32	B
5620.781	Linnet	336.4	26/7	0.720	20AH	0.8	0.38	11.6	295	0.5	12	1.3	32	B
5620.781	Oriole	336.4	30/7	0.741	20AH	0.8	0.38	11.6	295	0.5	12	1.3	32	B
5620.781	Chickadee	397.5	18/1	0.743	20AH	0.8	0.38	11.6	295	0.5	12	1.3	32	B

Notes:

1. Pad Dimensions are on page 117.
2. AFL Filler Compound (AFC) Requirements are on page 117.
3. Installation Instructions for Terminals are on page 131.
4. Bolts, nuts and washers are not supplied with the straight terminal connector.

Terminal Connectors—5600 Series for ACSR Conductors, Straight (cont.)

TERMINAL CATALOG NUMBER	CONDUCTOR				DIE SIZE	TOTAL WEIGHT		DIMENSION						PAD SIZE
	CODE WORD	SIZE	STRANDING	DIA.	ALUMINUM HEX DIE	LBS	KG	L		A		AB		
		KCMIL	AL/ST	IN				IN	MM	IN	MM	IN	MM	
5620.812	Brant	397.5	24/7	0.772	20AH	0.8	0.37	12.3	306	0.5	12	1.3	32	B
5620.844	Ibis	397.5	26/7	0.783	20AH	0.8	0.37	12.5	318	0.5	12	1.3	32	B
5620.844	Lark	397.5	30/7	0.806	20AH	0.8	0.37	12.5	318	0.5	12	1.3	32	B
5624.875	Pelican	477.0	18/1	0.814	24AH	1.4	0.64	12.6	319	0.6	16	1.5	38	B
5624.938	Flicker	477.0	24/7	0.846	24AH	1.3	0.59	12.8	324	0.6	15	1.5	38	B
5624.938	Hawk	477.0	26/7	0.858	24AH	1.3	0.59	12.8	324	0.6	15	1.5	38	B
5624.938	Hen	477.0	30/7	0.883	24AH	1.3	0.59	12.8	324	0.6	15	1.5	38	B
5624.938	Osprey	556.5	18/1	0.879	24AH	1.3	0.59	12.8	324	0.6	15	1.5	38	B
5624.969	Parakeet	556.5	24/7	0.914	24AH	1.3	0.59	12.8	325	0.6	15	1.5	38	B
5624.969	Dove	556.5	26/7	0.927	24AH	1.3	0.59	12.8	325	0.6	15	1.5	38	B
5627.100	Eagle	556.5	30/7	0.953	27AH	1.7	0.77	13.1	333	0.4	10	3.0	76	D
5627.100	Peacock	605.0	24/7	0.953	27AH	1.7	0.77	13.1	333	0.4	10	3.0	76	D
5627.100	Squab	605.0	26/7	0.966	27AH	1.7	0.77	13.1	333	0.4	10	3.0	76	D
5627.100	Swift	636.0	36/1	0.930	27AH	1.7	0.77	13.1	333	0.4	10	3.0	76	D
5627.100	Kingbird	636.0	18/1	0.940	27AH	1.7	0.77	13.1	333	0.4	10	3.0	76	D
5627.106	Teal	605.0	30/19	0.994	27AH	1.7	0.77	13.1	333	0.4	10	3.0	76	D
5627.106	Rook	636.0	24/7	0.977	27AH	1.7	0.77	13.1	333	0.4	10	3.0	76	D
5627.106	Grosbeak	636.0	26/7	0.990	27AH	1.7	0.77	13.1	333	0.4	10	3.0	76	D
5627.106	Egret	636.0	30/19	1.019	27AH	1.7	0.77	13.1	333	0.4	10	3.0	76	D
5627.106	Flamingo	666.6	24/7	1.000	27AH	1.7	0.77	13.1	333	0.4	10	3.0	76	D
5630.109	Stilt	715.5	24/7	1.036	30AH	2.4	1.09	14.3	363	0.5	13	3.0	76	D
5630.109	Starling	715.5	26/7	1.051	30AH	2.4	1.09	14.3	363	0.5	13	3.0	76	D
5630.109	Coot	795.0	36/1	1.040	30AH	2.4	1.09	14.3	363	0.5	13	3.0	76	D
5630.116	Redwing	715.5	30/19	1.081	30AH	2.3	1.04	14.6	370	0.5	12	3.0	76	D
5630.116	Tern	795.0	45/7	1.063	30AH	2.3	1.04	14.6	370	0.5	12	3.0	76	D
5630.116	Condor	795.0	54/7	1.093	30AH	2.3	1.04	14.6	370	0.5	12	3.0	76	D
5630.116	Drake	795.0	26/7	1.108	30AH	2.3	1.04	14.6	370	0.5	12	3.0	76	D
5630.116	Cuckoo	795.0	24/7	1.092	30AH	2.3	1.04	14.6	370	0.5	12	3.0	76	D
5630.122	Mallard	795.0	30/19	1.140	30AH	2.2	1.00	14.9	378	0.4	10	3.0	76	D
5630.122	Ruddy	900.0	45/7	1.131	30AH	2.2	1.00	14.9	378	0.4	10	3.0	76	D
5630.122	Canary	900.0	54/7	1.162	30AH	2.2	1.00	14.9	378	0.4	10	3.0	76	D
5630.122	Catbird	954.0	36/1	1.140	30AH	2.2	1.00	14.9	378	0.4	10	3.0	76	D
5630.122	Rail	954.0	45/7	1.165	30AH	2.2	1.00	14.9	378	0.4	10	3.0	76	D
5630.125	Cardinal	954.0	54/7	1.196	30AH	2.2	1.00	14.9	378	0.4	10	3.0	76	D
5630.125	Tanager	1033.5	36/1	1.186	30AH	2.2	1.00	14.9	378	0.4	10	3.0	76	D
5634.128	Ortolan	1033.5	45/7	1.212	34AH	3.3	1.50	15.3	389	0.6	16	3.0	76	D

Terminal Connectors—5600 Series for ACSR Conductors, Straight (cont.)

TERMINAL CATALOG NUMBER	CONDUCTOR				DIE SIZE	TOTAL WEIGHT		DIMENSION						PAD SIZE
	CODE WORD	SIZE	STRANDING	DIA.				ALUMINUM HEX DIE	L		A		AB	
		KCMIL		AL/ST	IN	LBS	KG		IN	MM	IN	MM	IN	
5634.134	Curlew	1033.5	54/7	1.244	34AH	3.2	1.45	15.8	400	0.6	15	3.0	76	D
5634.134	Bluejay	1113.0	45/7	1.259	34AH	3.2	1.45	15.8	400	0.6	15	3.0	76	D
5634.138	Bunting	1192.5	45/7	1.302	34AH	3.2	1.45	16.0	406	0.6	15	3.0	76	D
5634.138	Finch	1113.0	54/19	1.293	34AH	3.2	1.45	16.0	406	0.6	15	3.0	76	D
5636.144	Bittern	1272.0	45/7	1.345	36AH	3.6	1.63	16.6	421	0.6	15	3.0	76	D
5636.144	Grackle	1192.5	54/19	1.333	36AH	3.6	1.63	16.6	421	0.6	15	3.0	76	D
5636.147	Pheasant	1272.0	54/19	1.382	36AH	3.5	1.59	16.1	409	0.6	16	3.0	76	D
5636.147	Dipper	1351.5	45/7	1.386	36AH	3.5	1.59	16.1	409	0.6	16	3.0	76	D
5638.150	Martin	1351.5	54/19	1.424	38AH	4.4	2.00	17.1	435	0.8	20	3.0	76	D
5638.150	Bobolink	1431.0	45/7	1.427	38AH	4.4	2.00	17.1	435	0.8	20	3.0	76	D
5638.156	Plover	1431.0	54/19	1.465	38AH	4.2	1.91	17.9	454	0.7	17	3.0	76	D
5638.156	Nuthatch	1510.5	45/7	1.466	38AH	4.2	1.91	17.9	454	0.7	17	3.0	76	D
5640.162	Parrot	1510.5	54/19	1.506	40AH	4.8	2.18	17.6	446	0.7	17	3.0	76	D
5640.162	Lapwing	1590.0	45/7	1.504	40AH	4.8	2.18	17.6	446	0.7	17	3.0	76	D
5640.162	Falcon	1590.0	54/19	1.545	40AH	4.8	2.18	17.6	446	0.7	17	3.0	76	D
5642.178	Chukar	1780.0	84/19	1.602	42AH	5.3	2.40	19.0	483	0.7	17	4.0	102	E
5642.178	—	2034.0	72/7	1.681	42AH	5.3	2.40	19.0	483	0.7	17	4.0	102	E
5644.184	Bluebird	2156.0	84/19	1.762	44AH	6.2	2.81	19.6	497	0.7	18	4.0	102	E
5644.181	Kiwi	2167.0	72/7	1.737	44AH	6.3	2.86	19.5	493	0.7	18	4.0	102	E
5644.188	Thrasher	2312.0	76/19	1.802	44AH	6.1	2.77	19.6	498	0.7	18	4.0	102	E
5648.197	Joree	2515.0	76/19	1.880	48AH	8.2	3.72	21.6	549	0.8	21	4.0	102	E

Terminal Connectors—5100 Series for ACSR Conductors, 15°

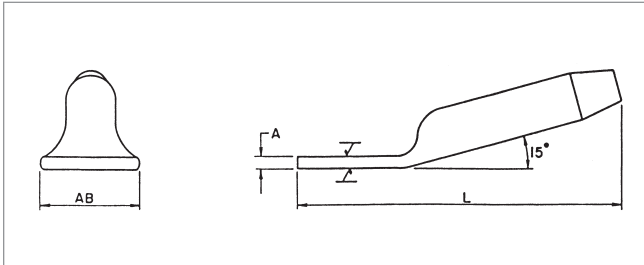

The 5100 Series 15° Terminal Connector is designed for ACSR conductors. The terminal connector is fabricated from AFL seamless drawn aluminum.

When used with the dead end, the 15° terminal connector can be bolted in either the straight or 30° position. All terminal connectors are designed for limited tension use, maintaining a minimum of 40% of the ASTM rated strength of the conductor on which it is being used. Aluminum hardware is supplied with the 15° terminal connector.

Ordering Instructions

Step 1: Assembly Catalog Number

Determine the assembly catalog number based on the conductor being used.

Step 2: Extra High Voltage Finish

For Extra High Voltage Finish, use 'EHV'.
For Standard Finish, leave blank.

Step 3: Assemble Catalog Number.



Example:

For 795 Drake conductor with an EHV finish, the complete catalog number is:

5130.116EHV

TERMINAL CATALOG NUMBER	CONDUCTOR				DIE SIZE	TOTAL WEIGHT		DIMENSION						PAD SIZE
	CODE WORD	SIZE	STRAND-ING	DIA.	ALUMINUM HEX DIE			L		A		AB		
		KCMIL	AL/ST	IN		LBS	KG	IN	MM	IN	MM	IN	MM	
5174.438	Grouse	80.0	6/1	0.367	74AH	0.4	0.20	8.3	211	0.3	9	1.0	25	B
5174.438	Raven	1/0	6/1	0.398	74AH	0.4	0.20	8.3	211	0.3	9	1.0	25	B
5174.484	Quail	2/0	6/1	0.447	74AH	0.4	0.19	8.3	211	0.3	8	1.0	25	B
5175.547	Pigeon	3/0	6/1	0.502	75AH	0.7	0.29	9.5	241	0.5	13	1.0	25	B
5175.609	Penguin	4/0	6/1	0.563	75AH	0.6	0.27	9.8	248	0.5	12	1.0	25	B
5176.656	Waxwing	266.8	18/1	0.609	76AH	0.9	0.41	10.4	265	0.6	15	1.3	32	B
5176.688	Owl	266.8	6/7	0.633	76AH	0.9	0.40	10.6	268	0.6	14	1.3	32	B
5176.688	Partridge	266.8	26/7	0.642	76AH	0.9	0.40	10.6	268	0.6	14	1.3	32	B
5176.719	Ostrich	300.0	26/7	0.680	76AH	0.9	0.39	10.7	272	0.5	13	1.3	32	B
5176.719	Merlin	336.4	18/1	0.684	76AH	0.9	0.39	10.7	272	0.5	13	1.3	32	B
5176.781	Linnet	336.4	26/7	0.720	76AH	0.8	0.37	10.9	276	0.5	12	1.3	32	B
5176.781	Chickadee	397.5	18/1	0.743	76AH	0.8	0.37	10.9	276	0.5	12	1.3	32	B

Notes:

1. Pad Dimensions are on page 117.
2. AFL Filler Compound (AFC) Requirements are on page 115.
3. Installation Instructions for Terminals are on page 131.
4. Supplied with aluminum hardware.

Terminal Connectors—5100 Series for ACSR Conductors, 15° (cont.)

TERMINAL CATALOG NUMBER	CONDUCTOR				DIE SIZE	TOTAL WEIGHT		DIMENSION						PAD SIZE
	CODE WORD	SIZE	STRAND-ING	DIA.	ALUMINUM HEX DIE			L		A		AB		
		KCMIL	AL/ST	IN		LBS	KG	IN	MM	IN	MM	IN	MM	
5120.781	Linnet	336.4	26/7	0.720	20AH	1.0	0.45	11.6	295	0.5	12	1.3	32	B
5120.781	Oriole	336.4	30/7	0.741	20AH	1.0	0.45	11.6	295	0.5	12	1.3	32	B
5120.781	Chickadee	397.5	18/1	0.743	20AH	1.0	0.45	11.6	295	0.5	12	1.3	32	B
5120.812	Brant	397.5	24/7	0.772	20AH	1.0	0.44	12.1	306	0.5	12	1.3	32	B
5120.844	Ibis	397.5	26/7	0.783	20AH	1.0	0.44	12.5	318	0.5	12	1.3	32	B
5120.844	Lark	397.5	30/7	0.806	20AH	1.0	0.44	12.5	318	0.5	12	1.3	32	B
5124.875	Pelican	477.0	18/1	0.814	24AH	1.6	0.73	12.6	319	0.6	16	1.5	38	B
5124.938	Flicker	477.0	24/7	0.846	24AH	1.5	0.68	12.8	324	0.6	15	1.5	38	B
5124.938	Hawk	477.0	26/7	0.858	24AH	1.5	0.68	12.8	324	0.6	15	1.5	38	B
5124.938	Hen	477.0	30/7	0.883	24AH	1.5	0.68	12.8	324	0.6	15	1.5	38	B
5124.938	Osprey	556.5	18/1	0.879	24AH	1.5	0.68	12.8	324	0.6	15	1.5	38	B
5124.969	Parakeet	556.5	24/7	0.914	24AH	1.5	0.68	12.8	325	0.6	15	1.5	38	B
5124.969	Dove	556.5	26/7	0.927	24AH	1.5	0.68	12.8	325	0.6	15	1.5	38	B
5127.100	Eagle	556.5	30/7	0.953	27AH	1.9	0.86	12.3	313	0.4	10	3.0	76	D
5127.100	Peacock	605.0	24/7	0.953	27AH	1.9	0.86	12.3	313	0.4	10	3.0	76	D
5127.100	Squab	605.0	26/7	0.966	27AH	1.9	0.86	12.3	313	0.4	10	3.0	76	D
5127.106	Teal	605.0	30/19	0.994	27AH	1.9	0.86	12.3	313	0.4	10	3.0	76	D
5127.100	Swift	636.0	36/1	0.930	27AH	1.9	0.86	12.3	313	0.4	10	3.0	76	D
5127.100	Kingbird	636.0	18/1	0.940	27AH	1.9	0.86	12.3	313	0.4	10	3.0	76	D
5127.106	Rook	636.0	24/7	0.977	27AH	1.9	0.86	12.3	313	0.4	10	3.0	76	D
5127.106	Grosbeak	636.0	26/7	0.990	27AH	1.9	0.86	12.3	313	0.4	10	3.0	76	D
5127.106	Egret	636.0	30/19	1.019	27AH	1.9	0.86	12.3	313	0.4	10	3.0	76	D
5127.106	Flamingo	666.6	24/7	1.000	27AH	1.9	0.86	12.3	313	0.4	10	3.0	76	D
5130.109	Stilt	715.5	24/7	1.036	30AH	2.7	1.22	13.6	346	0.5	13	3.0	76	D
5130.109	Starling	715.5	26/7	1.051	30AH	2.7	1.22	13.6	346	0.5	13	3.0	76	D
5130.109	Coot	795.0	36/1	1.040	30AH	2.7	1.22	13.6	346	0.5	13	3.0	76	D
5130.116	Redwing	715.5	30/19	1.081	30AH	2.6	1.18	13.9	354	0.5	12	3.0	76	D
5130.116	Tern	795.0	45/7	1.063	30AH	2.6	1.18	13.9	354	0.5	12	3.0	76	D
5130.116	Condor	795.0	54/7	1.093	30AH	2.6	1.18	13.9	354	0.5	12	3.0	76	D
5130.116	Drake	795.0	26/7	1.108	30AH	2.6	1.18	13.9	354	0.5	12	3.0	76	D
5130.116	Cuckoo	795.0	24/7	1.092	30AH	2.6	1.18	13.9	354	0.5	12	3.0	76	D
5130.122	Mallard	795.0	30/19	1.140	30AH	2.5	1.13	14.3	362	0.4	10	3.0	76	D
5130.122	Ruddy	900.0	45/7	1.131	30AH	2.5	1.13	14.3	362	0.4	10	3.0	76	D
5130.122	Canary	900.0	54/7	1.162	30AH	2.5	1.13	14.3	362	0.4	10	3.0	76	D
5130.122	Catbird	954.0	36/1	1.140	30AH	2.5	1.13	14.3	362	0.4	10	3.0	76	D
5130.122	Rail	954.0	45/7	1.165	30AH	2.5	1.13	14.3	362	0.4	10	3.0	76	D

Terminal Connectors—5100 Series for ACSR Conductors, 15° (cont.)

TERMINAL CATALOG NUMBER	CONDUCTOR				DIE SIZE	TOTAL WEIGHT		DIMENSION						PAD SIZE
	CODE WORD	SIZE	STRAND-ING	DIA.	ALUMINUM HEX DIE			L		A		AB		
		KCMIL	AL/ST	IN		LBS	KG	IN	MM	IN	MM	IN	MM	
5130.125	Cardinal	954.0	54/7	1.196	30AH	2.5	1.13	14.4	367	0.4	10	3.0	76	D
5130.125	Tanager	1033.5	36/1	1.186	30AH	2.5	1.13	14.4	367	0.4	10	3.0	76	D
5134.128	Ortolan	1033.5	45/7	1.212	34AH	3.6	1.63	14.3	363	0.6	16	3.0	76	D
5134.134	Curlew	1033.5	54/7	1.244	34AH	3.5	1.59	14.5	368	0.6	15	3.0	76	D
5134.134	Bluejay	1113.0	45/7	1.259	34AH	3.5	1.59	14.5	368	0.6	15	3.0	76	D
5134.138	Finch	1113.0	54/19	1.293	34AH	3.4	1.54	14.6	370	0.6	15	3.0	76	D
5134.138	Bunting	1192.5	45/7	1.302	34AH	3.4	1.54	14.6	370	0.6	15	3.0	76	D
5136.144	Grackle	1192.5	54/19	1.333	36AH	3.8	1.72	15.3	389	0.6	15	3.0	76	D
5136.144	Bittern	1272.0	45/7	1.345	36AH	3.8	1.72	15.3	389	0.6	15	3.0	76	D
5136.147	Pheasant	1272.0	54/19	1.382	36AH	3.8	1.72	15.1	384	0.6	16	3.0	76	D
5136.147	Dipper	1351.5	45/7	1.386	36AH	3.8	1.72	15.1	384	0.6	16	3.0	76	D
5138.150	Martin	1351.5	54/19	1.424	38AH	4.5	2.04	15.8	400	0.8	20	3.0	76	D
5138.150	Bobolink	1431.0	45/7	1.427	38AH	4.5	2.04	15.8	400	0.8	20	3.0	76	D
5138.156	Plover	1431.0	54/19	1.465	38AH	4.4	2.00	16.7	424	0.9	17	3.0	76	D
5138.156	Nuthatch	1510.5	45/7	1.466	38AH	4.4	2.00	16.7	424	0.9	17	3.0	76	D
5140.162	Parrot	1510.5	54/19	1.506	40AH	5.3	2.40	17.4	443	0.7	18	4.0	102	E
5140.162	Lapwing	1590.0	45/7	1.504	40AH	5.3	2.40	17.4	443	0.7	18	4.0	102	E
5140.162	Falcon	1590.0	54/19	1.545	40AH	5.3	2.40	17.4	443	0.7	18	4.0	102	E
5142.178	Chukar	1780.0	84/19	1.602	42AH	5.7	2.59	18.5	470	0.7	17	4.0	102	E
5142.178	—	2034.0	72/7	1.681	42AH	5.7	2.59	18.5	470	0.7	17	4.0	102	E
5144.184	Bluebird	2156.0	84/19	1.762	44AH	6.7	3.04	18.6	471	0.7	18	4.0	102	E
5144.181	Kiwi	2167.0	72/7	1.737	44AH	6.7	3.04	18.6	471	0.7	18	4.0	102	E
5144.188	Thrasher	2312.0	76/19	1.802	44AH	6.6	2.99	18.6	473	0.7	18	4.0	102	E
5148.197	Joree	2515.0	76/19	1.880	48AH	8.7	3.95	20.3	514	0.8	21	4.0	102	E

Terminal Connectors—5800 Series for ACSR Conductors, 90°

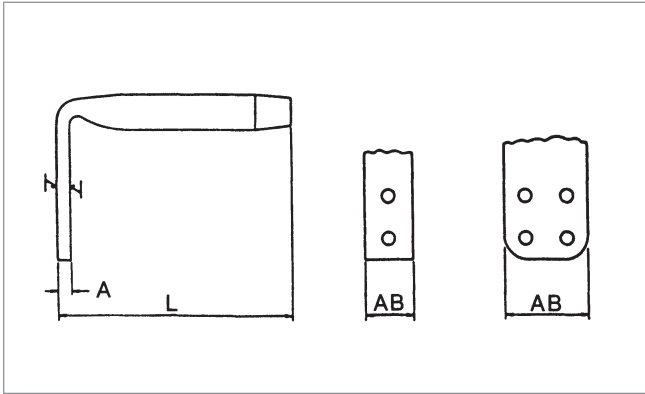

The 5800 Series 90° Terminal Connector is designed for ACSR conductors. The terminal connector is fabricated from AFL seamless drawn aluminum.

All terminal connectors are designed for limited tension use, maintaining a minimum of 40% of the ASTM rated strength of the conductor on which it is being used.

Ordering Instructions

Step 1: Assembly Catalog Number

Determine the assembly catalog number based on the conductor being used.

Step 2: Extra High Voltage Finish

For Extra High Voltage Finish, use 'EHV'.
For Standard Finish, leave blank.

Step 3: Assemble Catalog Number.



Example:

For 795 Drake conductor with an EHV finish, the complete catalog number is:

5830.116EHV

TERMINAL CATALOG NUMBER	CONDUCTOR				DIE SIZE	TOTAL WEIGHT		DIMENSION						PAD SIZE
	CODE WORD	SIZE	STRANDING	DIA.				ALUMINUM HEX DIE	L		A		AB	
		KCMIL	AL/ST	IN	LBS	KG	IN		MM	IN	MM	IN	MM	
5874.438	Grouse	80.0	8/1	0.367	74AH	0.3	0.15	4.9	124	0.3	9	1.0	25	B
5874.438	Raven	1/0	6/1	0.398	74AH	0.3	0.15	4.9	124	0.3	9	1.0	25	B
5874.484	Quail	2/0	6/1	0.447	74AH	0.3	0.15	4.9	124	0.3	9	1.0	25	B
5875.547	Pigeon	3/0	6/1	0.502	75AH	0.5	0.24	6.0	152	0.5	13	1.0	25	B
5875.609	Penguin	4/0	6/1	0.563	75AH	0.5	0.22	6.3	159	0.5	12	1.0	25	B
5876.656	Waxwing	266.8	18/1	0.609	76AH	0.8	0.38	7.1	181	0.6	15	1.3	32	B
5876.688	Owl	266.8	6/7	0.633	76AH	0.8	0.37	7.3	184	0.6	14	1.3	32	B
5876.688	Partridge	266.8	26/7	0.642	76AH	0.8	0.37	7.3	184	0.6	14	1.3	32	B

Notes:

1. Pad Dimensions are on page 117.
2. AFL Filler Compound (AFC) Requirements are on page 115.
3. Installation Instructions for Terminals are on page 131.
4. Bolts, nuts and washers are not supplied with the 90° terminal connector.

Terminal Connectors—5800 Series for ACSR Conductors, 90° (cont.)

TERMINAL CATALOG NUMBER	CONDUCTOR				DIE SIZE	TOTAL WEIGHT		DIMENSION						PAD SIZE
	CODE WORD	SIZE	STRANDING	DIA.	ALUMINUM HEX DIE	LBS	KG	L		A		AB		
		KCMIL	AL/ST	IN				IN	MM	IN	MM	IN	MM	
5876.719	Ostrich	300.0	26/7	0.680	76AH	0.8	0.36	7.3	184	0.5	13	1.3	32	B
5876.719	Merlin	336.4	18/1	0.684	76AH	0.8	0.36	7.3	184	0.5	13	1.3	32	B
5876.781	Linnet	336.4	26/7	0.720	76AH	0.7	0.33	7.6	194	0.5	12	1.3	32	B
5876.781	Chickadee	397.5	18/1	0.743	76AH	0.7	0.33	7.6	194	0.5	12	1.3	32	B
5820.781	Linnet	336.4	26/7	0.720	20AH	0.9	0.40	8.5	216	0.5	12	1.3	32	B
5820.781	Oriole	336.4	30/7	0.741	20AH	0.9	0.40	8.5	216	0.5	12	1.3	32	B
5820.781	Chickadee	397.5	18/1	0.743	20AH	0.9	0.40	8.5	216	0.5	12	1.3	32	B
5820.812	Brant	397.5	24/7	0.772	20AH	0.9	0.39	8.9	226	0.5	12	1.3	32	B
5820.844	Ibis	397.5	26/7	0.783	20AH	0.9	0.40	9.1	232	0.5	12	1.3	32	B
5820.844	Lark	397.5	30/7	0.806	20AH	0.9	0.40	9.1	232	0.5	12	1.3	32	B
5824.875	Pelican	477.0	18/1	0.814	24AH	1.5	0.68	9.4	238	0.6	16	1.5	38	B
5824.938	Flicker	477.0	24/7	0.846	24AH	1.4	0.64	9.5	241	0.6	15	1.5	38	B
5824.938	Hawk	477.0	26/7	0.858	24AH	1.4	0.64	9.5	241	0.6	15	1.5	38	B
5824.938	Hen	477.0	30/7	0.883	24AH	1.4	0.64	9.5	241	0.6	15	1.5	38	B
5824.938	Osprey	556.5	18/1	0.879	24AH	1.4	0.64	9.5	241	0.6	15	1.5	38	B
5824.969	Parakeet	556.5	24/7	0.914	24AH	1.4	0.64	9.5	241	0.6	15	1.5	38	B
5824.969	Dove	556.5	26/7	0.927	24AH	1.4	0.64	9.5	241	0.6	15	1.5	38	B
5827.100	Eagle	556.5	30/7	0.953	27AH	1.7	0.77	8.9	226	0.4	10	3.0	76	D
5827.100	Peacock	605.0	24/7	0.953	27AH	1.7	0.77	8.9	226	0.4	10	3.0	76	D
5827.100	Squab	605.0	26/7	0.966	27AH	1.7	0.77	8.9	226	0.4	10	3.0	76	D
5827.100	Swift	636.0	36/1	0.930	27AH	1.7	0.77	8.9	226	0.4	10	3.0	76	D
5827.100	Kingbird	636.0	18/1	0.940	27AH	1.7	0.77	8.9	226	0.4	10	3.0	76	D
5827.106	Teal	605.0	30/19	0.994	27AH	1.7	0.77	8.9	226	0.4	10	3.0	76	D
5827.106	Rook	636.0	24/7	0.977	27AH	1.7	0.77	8.9	226	0.4	10	3.0	76	D
5827.106	Grosbeak	636.0	26/7	0.990	27AH	1.7	0.77	8.9	226	0.4	10	3.0	76	D
5827.106	Egret	636.0	30/19	1.019	27AH	1.7	0.77	8.9	226	0.4	10	3.0	76	D
5827.106	Flamingo	666.6	24/7	1.000	27AH	1.7	0.77	8.9	226	0.4	10	3.0	76	D
5830.109	Stilt	715.5	24/7	1.036	30AH	2.4	1.09	10.3	260	0.5	13	3.0	76	D
5830.109	Starling	715.5	26/7	1.051	30AH	2.4	1.09	10.3	260	0.5	13	3.0	76	D
5830.109	Coot	795.0	36/1	1.040	30AH	2.4	1.09	10.3	260	0.5	13	3.0	76	D
5830.116	Redwing	715.5	30/19	1.081	30AH	2.3	1.04	10.5	267	0.5	12	3.0	76	D
5830.116	Tern	795.0	45/7	1.063	30AH	2.3	1.04	10.5	267	0.5	12	3.0	76	D
5830.116	Condor	795.0	54/7	1.093	30AH	2.3	1.04	10.5	267	0.5	12	3.0	76	D
5830.116	Drake	795.0	26/7	1.108	30AH	2.3	1.04	10.5	267	0.5	12	3.0	76	D
5830.116	Cuckoo	795.0	24/7	1.092	30AH	2.3	1.04	10.5	267	0.5	12	3.0	76	D
5830.122	Mallard	795.0	30/19	1.140	30AH	2.2	1.00	10.8	273	0.4	10	3.0	76	D

Terminal Connectors—5800 Series for ACSR Conductors, 90° (cont.)

TERMINAL CATALOG NUMBER	CONDUCTOR				DIE SIZE	TOTAL WEIGHT		DIMENSION						PAD SIZE
	CODE WORD	SIZE	STRANDING	DIA.				ALUMINUM HEX DIE	L		A		AB	
		KCMIL	AL/ST	IN	LBS	KG	IN		MM	IN	MM	IN	MM	
5830.122	Ruddy	900.0	45/7	1.131	30AH	2.2	1.00	10.8	273	0.4	10	3.0	76	D
5830.122	Canary	900.0	54/7	1.162	30AH	2.2	1.00	10.8	273	0.4	10	3.0	76	D
5830.122	Catbird	954.0	36/1	1.140	30AH	2.2	1.00	10.8	273	0.4	10	3.0	76	D
5830.122	Rail	954.0	45/7	1.165	30AH	2.2	1.00	10.8	273	0.4	10	3.0	76	D
5830.125	Cardinal	954.0	54/7	1.196	30AH	2.2	1.00	10.9	276	0.4	10	3.0	76	D
5830.125	Tanager	1033.5	36/1	1.186	30AH	2.2	1.00	10.9	276	0.4	10	3.0	76	D
5834.128	Ortolan	1033.5	45/7	1.212	34AH	3.3	1.50	11.5	292	0.6	16	3.0	76	D
5834.134	Curlew	1033.5	54/7	1.244	34AH	3.2	1.45	11.5	292	0.6	15	3.0	76	D
5834.134	Bluejay	1113.0	45/7	1.259	34AH	3.2	1.45	11.5	292	0.6	15	3.0	76	D
5834.138	Finch	1113.0	54/19	1.293	34AH	3.1	1.41	11.5	292	0.6	15	3.0	76	D
5834.138	Bunting	1192.5	45/7	1.302	34AH	3.1	1.41	11.5	292	0.6	15	3.0	76	D
5936.144	Crackle	1192.5	54/19	1.333	36AH	3.5	1.6	12.1	308	0.6	15	3.0	76	D
5836.144	Bittern	1272.0	45/7	1.345	36AH	3.5	1.59	12.1	308	0.6	15	3.0	76	D
5836.147	Pheasant	1272.0	54/19	1.382	36AH	3.5	1.59	12.1	308	0.6	16	3.0	76	D
5836.147	Dipper	1351.5	45/7	1.386	36AH	3.5	1.59	12.1	308	0.6	16	3.0	76	D
5838.150	Martin	1351.5	54/19	1.424	38AH	4.2	1.91	12.6	321	0.8	20	3.0	76	D
5838.150	Bobolink	1431.0	45/7	1.427	38AH	4.2	1.91	12.6	321	0.8	20	3.0	76	D
5838.156	Plover	1431.0	54/19	1.465	38AH	4.2	1.91	13.6	346	0.7	17	3.0	76	D
5838.156	Nuthatch	1510.5	45/7	1.466	38AH	4.2	1.91	13.6	346	0.7	17	3.0	76	D
5840.162	Parrot	1510.5	54/19	1.506	40AH	4.7	2.13	13.3	338	0.7	17	3.0	76	D
5840.162	Lapwing	1590.0	45/7	1.504	40AH	4.7	2.13	13.3	338	0.7	17	3.0	76	D
5840.162	Falcon	1590.0	54/19	1.545	40AH	4.7	2.13	13.3	338	0.7	17	3.0	76	D
5842.178	Chukar	1780.0	84/19	1.602	42AH	5.5	2.49	14.5	368	0.7	17	4.0	102	E
5842.178	—	2034.0	72/7	1.681	42AH	5.5	2.49	14.5	368	0.7	17	4.0	102	E
5844.181	Kiwi	2167.0	72/7	1.737	44AH	6.7	3.04	14.6	371	0.7	18	4.0	102	E
5844.184	Bluebird	2156.0	84/19	1.762	44AH	6.6	2.99	14.8	375	0.7	18	4.0	102	E
5844.188	Thrasher	2312.0	76/19	1.802	44AH	6.6	2.99	15.1	384	0.7	18	4.0	102	E
5848.197	Joree	2515.0	76/19	1.880	48AH	8.5	3.86	16.4	416	0.8	21	4.0	102	E