

Compression Dead Ends—4500 Series for Alumoweld® and Steel Ground Wire, Eye or Clevis Type, Single Tongue

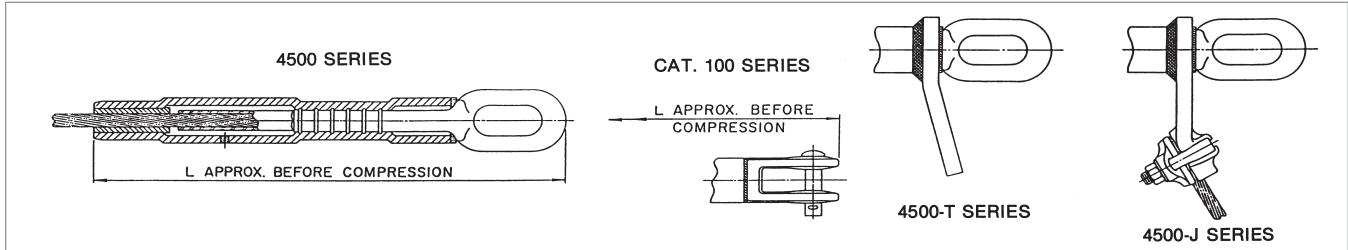

DEAD END ASSEMBLY CATALOG NUMBER	CONDUCTOR			STEEL DEAD END		DIM. L		JUMPER RANGE J SERIES		DIE SIZE		WEIGHT						TERMINAL CONNECTOR CATALOG NUMBER						
	SIZE	STRANDING	DIA. IN	STEEL EYE	STEEL CLEVIS	IN	MM	IN	MM	ALUM. HEX DIES	STEEL HEX DIES	4500 SERIES		4500-T SERIES		4500-J SERIES								
												ALUM.	TOTAL	ALUM.	TOTAL	ALUM.	TOTAL							
ALUMOWELD STRAND																								
E4514.35	3 No. 5	3	0.392	9314.406	—	18.3	465	.312-.625	7.9-15.9	27AH	14SH	1.9	0.86	4.9	2.22	2.3	1.04	5.3	2.4	3.0	1.36	6.0	2.72	5174.438
E4512.36	3 No. 6	3	0.349	9112.377	—	16.9	429	.312-.625	7.9-15.9	20AH	12SH	0.8	0.36	2.5	1.13	1.3	0.59	3.0	1.36	2.0	0.91	3.7	1.68	5109.375
E4510.37	3 No. 7	3	0.311	9110.332	—	16.9	429	.312-.625	7.9-15.9	20AH	10SH	0.9	0.41	2.5	1.13	1.3	0.59	2.9	1.32	2.1	0.95	3.7	1.68	5109.344
E4510.38	3 No. 8	3	0.277	9110.295	—	16.9	429	.312-.625	7.9-15.9	20AH	10SH	0.9	0.41	2.5	1.13	1.3	0.59	3.0	1.36	2.1	0.95	3.8	1.72	5106.312
C4576.39	3 No. 9	3	0.247	—	103.26	11.9	302	.162-.327	4.1-8.3	76AH	76SH	0.5	0.23	2.5	1.13	1.0	0.45	3.0	1.36	0.8	0.36	2.1	0.95	5172.281
C4576.310	3 No. 10	3	0.220	—	103.25	11.9	302	.162-.327	4.1-8.3	76AH	76SH	0.5	0.23	2.5	1.13	1.0	0.45	3.0	1.36	0.8	0.36	2.1	0.95	5172.281
E4518.75	7 No. 5	7	0.546	E9718.578	—	19.2	487	.464-.743	11.8-18.9	34AH	18SH	2.6	1.18	7.9	3.58	4.0	1.81	9.2	4.17	3.5	1.59	8.8	3.99	5175.609
E4516.76	7 No. 6	7	0.486	9416.516	—	18.2	462	.312-.625	7.9-15.9	30AH	16SH	2.2	1.00	6.0	2.72	2.6	1.18	6.4	2.9	3.2	1.45	7.0	3.18	5175.547
E4516.77	7 No. 7	7	0.433	9316.453	—	18.3	465	.312-.625	7.9-15.9	27AH	16SH	1.9	0.86	5.0	2.27	2.3	1.04	5.4	2.45	3.0	1.36	8.1	2.77	5174.484
E4514.78	7 No. 8	7	0.385	9314.406	—	18.3	465	.312-.625	7.9-15.9	27AH	14SH	1.9	0.86	5.0	2.27	2.3	1.04	5.4	2.45	3.0	1.36	6.1	2.77	5174.438
E4512.79	7 No. 9	7	0.343	9112.359	—	16.9	429	.312-.625	7.9-15.9	20AH	12SH	0.8	0.36	2.6	1.18	1.3	0.59	3.1	1.41	2.0	0.91	3.8	1.72	5173.391
E4512.710	7 No. 10	7	0.306	9112.332	—	16.9	429	.312-.625	7.9-15.9	20AH	12SH	0.9	0.41	2.6	1.18	1.3	0.59	3.0	1.36	2.1	0.95	3.8	1.72	5106.344
E4518.191	19 No. 10	19	0.509	E9718.546	—	19.9	505	.464-.743	11.8-18.9	34AH	18SH	2.6	1.18	8.1	3.67	4.0	1.81	9.5	4.31	3.5	1.59	9.0	4.08	5175.547
STEEL GROUND WIRE																								
E 4512.10	5/16 EHS GW	7	0.312	9112.332	—	16.9	429	.312-.625	7.9-15.9	20AH	12SH	0.9	0.41	2.5	1.13	1.3	0.59	3.0	1.36	2.1	0.95	3.8	1.72	5173.357
E4514.12	3/8 EHS GW	7	0.360	9214.377	—	18.1	460	.312-.625	7.9-15.9	27AH	14SH	1.9	0.86	4.0	1.81	2.3	1.04	4.4	2.0	3.0	1.36	5.1	2.31	5173.391
E4516.14	7/16 EHS GW	7	0.435	9316.453	—	18.3	465	.312-.625	7.9-15.9	27AH	16SH	1.9	0.86	5.0	2.27	2.3	1.04	5.4	2.45	3.0	1.36	6.1	2.77	5175.547
E4518.16	1/2 EHS GW	7	0.495	E9718.516	—	19.9	505	.464-.743	11.8-18.9	34AH	18SH	2.6	1.18	7.9	3.58	4.0	1.81	9.3	4.22	3.5	1.59	8.8	3.99	5175.547

GROUND WIRE ACCESSORIES

Ordering Instructions

Select the catalog number based on the conductor being used. Terminals are to ordered separately.

Options

To order a Dead End with a single tongue, put a "T" at the end of the catalog number. **EXAMPLE: E4516.77T**

To order a Dead End with a bolted jumper, put a "J" at the end of the catalog number. **EXAMPLE: E4516.77J**

Notes:

1. Eye and Clevis Dimensions are on page 119.
2. Pad Dimensions are on page 117.
3. AFL Filler Compound (AFC) Requirements are on page 115.
4. Installation Instructions for Dead Ends are on page 134.
5. Installation Instructions for Terminals are on page 131.
6. The 4500-T Series Dead Ends are supplied with a "B" pad size.

Compression Joints—4900 Series for Alumoweld® and Steel Ground Wire

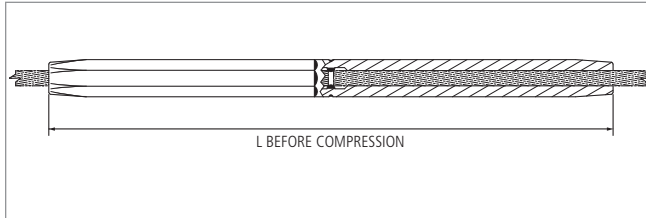

Ordering Instructions

Step 1: Assembly Catalog Number

Determine the assembly catalog number based on the conductor being used.

Example:

For 7 No. 7 Alumoweld, the complete catalog number is:

4916.484

The 4900 Series Compression Joint is specifically designed for Alumoweld and steel ground wires. The aluminum joint is fabricated from AFL seamless drawn aluminum. The 4900 series compression joint consists of only an aluminum sleeve and has no steel sleeve.

The 4900 Series compression joints are designed for full tension use, achieving a minimum of 95% of the ASTM rated breaking strength of the conductor on which they are used.

Alumoweld Strand:

JOINT CATALOG NUMBER	CONDUCTOR			DIE SIZE	WEIGHT		DIMENSION L	
	SIZE	DIAMETER		STEEL HEX DIES	LBS	KG	IN	MM
		IN	MM					
4910.251	3 No. 10	.220	5.6	10SH	0.1	0.05	7.3	184
4910.281	3 No. 9	.247	6.3	10SH	0.1	0.05	7.3	184
4910.295	3 No. 8	.277	7.0	10SH	0.2	0.09	7.5	191
4910.324	3 No. 7	.311	7.9	10SH	0.2	0.09	8.5	216
4912.351	3 No. 6	.349	8.9	12SH	0.3	0.14	9.0	229
4914.406	3 No. 5	.392	10.0	14SH	0.5	0.23	11.0	279
4912.330	7 No. 10	.306	7.8	12SH	0.49	0.22	9.0	356
4912.359	7 No. 9	.343	8.7	12SH	0.3	0.14	9.0	229
4914.406	7 No. 8	.385	9.8	14SH	0.5	0.23	11.0	279
4916.484	7 No. 7	.433	11.0	16SH	0.6	0.27	11.0	279
4916.531	7 No. 6	.486	12.3	16SH	0.6	0.27	11.0	381
4918.594	7 No. 5	.546	13.9	18SH	0.8	0.36	11.0	381
4918.530	19 No. 10	.509	12.9	18SH	1.3	0.59	11.0	431
4920.625	19 No. 9	.572	14.5	20SH	1.1	0.5	12.0	305

Notes:

1. Joints are lined with a compound made up of 60% silicon carbide and 40% CF-1.
2. Installation Instructions for Joints are on page 140.

Compression Joints—4900 Series for Alumoweld® and Steel Ground Wire (cont.)

Steel Ground Wire:

JOINT CATALOG NUMBER	CONDUCTOR				DIE SIZE	WEIGHT		DIMENSION L	
	SIZE	STRANDING	DIAMETER		STEEL HEX DIE	LBS	KG	IN	MM
		STEEL	IN	MM					
4912.332	5/16 EHS G.W.	7	0.312	7.9	12SH	0.5	0.22	14.0	356
4914.386	3/8 EHS G.W.	7	0.360	9.1	14SH	0.6	0.28	13.0	330
4916.453	7/16 EHS G.W.	7	0.435	11.0	16SH	0.9	0.42	15.0	381
4918.531	1/2 EHS G.W.	7	0.495	12.6	18SH	1.3	0.59	17.0	431

Jumper Connectors—5000 Series for Alumoweld® and Steel Ground Wire

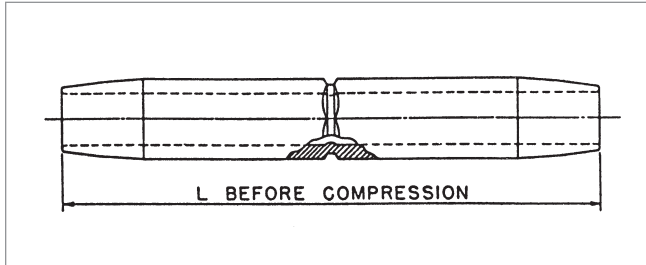

Ordering Instructions

Step 1: Assembly Catalog Number

Determine the assembly catalog number based on the conductor being used.

Example:

For 7 No. 7 Alumoweld, the complete catalog number is:

5074.484

The 5000 Series Jumper Connector is designed for Alumoweld® and steel ground wire. The jumper connector is fabricated from AFL seamless drawn aluminum. All jumper connectors are designed for limited tension use, maintaining a minimum of 40% of the ASTM rated strength of the conductor on which it is being used.

JUMPER CONNECTOR CATALOG NUMBER	CONDUCTOR		DIE SIZE ALUMINUM HEX DIE	TOTAL WEIGHT		DIMENSION L	
	SIZE	DIA. IN		LBS	KG	IN	MM
ALUMOWELD							
5072.281	3 No. 10	0.220	72AH	0.8	0.04	4.5	114
5072.281	3 No. 9	0.247	72AH	0.8	0.04	4.5	114
5072.312	3 No. 8	0.277	72AH	0.7	0.03	4.5	114
5009.344	3 No. 7	0.311	09AH	0.1	0.05	4.4	111
5009.375	3 No. 6	0.349	09AH	0.1	0.05	4.4	111
5074.438	3 No. 5	0.392	74AH	0.3	0.11	7.0	178
5009.344	7 No. 10	0.306	09AH	0.1	0.05	4.4	111
5073.391	7 No. 9	0.343	73AH	0.1	0.05	6.0	152
5074.438	7 No. 8	0.385	74AH	0.3	0.11	7.0	178
5074.484	7 No. 7	0.433	74AH	0.2	0.10	7.0	178
5075.547	7 No. 6	0.486	75AH	0.4	0.20	8.0	203
5075.609	7 No. 5	0.546	75AH	0.4	0.18	8.0	203
5076.656	19 No. 9	0.572	76AH	0.7	0.31	9.0	229
STEEL GROUND WIRE							
5073.357	5/16-7 Str.	0.312	73AH	0.1	0.05	6.0	152
5074.438	3/8-7 Str.	0.360	74AH	0.3	0.11	7.0	178
5075.547	7/16-7 Str.	0.435	75AH	0.4	0.20	8.0	203
5075.547	1/2-7 Str.	0.495	75AH	0.4	0.20	8.0	203

Notes:

1. AFL Filler Compound (AFC) Requirements are on page 115.
2. Installation Instructions for Jumper Connectors are on page 143.

Terminal Connectors—5600 Series for Alumoweld® and Steel Ground Wire, Straight

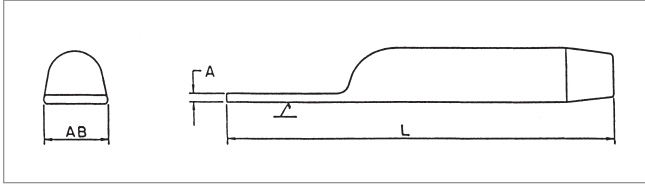

The 5600 Series Straight Terminal Connector is designed for Alumoweld and steel ground wire. The terminal connector is fabricated from AFL seamless drawn aluminum.

When used with the dead end, the straight terminal connector allows drop at a 15° angle. All terminal connectors are designed for limited tension use, maintaining a minimum of 40% of the ASTM rated strength of the conductor on which it is being used.

Ordering Instructions

Step 1: Assembly Catalog Number

Determine the assembly catalog number based on the conductor being used.

Example:

For 7 No. 7 Alumoweld, the complete catalog number is:

5674.484

TERMINAL CONNECTOR CATALOG NUMBER	CONDUCTOR		DIE SIZE ALUMINUM HEX DIE	TOTAL WEIGHT		DIMENSION						PAD SIZE
	SIZE	DIA. IN		LBS	KG	L		A		AB		
						IN	MM	IN	MM	IN	MM	
ALUMOWELD												
5672.281	3 No 10	0.220	72AH	0.1	0.06	7.4	189	0.2	5	1.0	25	B
5672.281	3 No 9	0.247	72AH	0.1	0.06	7.4	189	0.2	5	1.0	25	B
5606.312	3 No 8	0.277	06AH	0.3	0.13	7.2	183	0.1	3	1.0	25	B
5609.344	3 No 7	0.311	09AH	0.2	0.09	7.8	197	0.3	7	1.0	25	B
5609.375	3 No 6	0.349	09AH	0.2	0.09	7.8	198	0.3	6	1.0	25	B
5674.438	3 No 5	0.392	74AH	0.3	0.14	8.3	211	0.3	9	1.0	25	B
5606.344	7 No 10	0.306	06AH	0.2	0.09	7.3	185	0.1	3	1.0	25	B
5673.391	7 No 9	0.343	73AH	0.1	0.06	7.6	194	0.2	5	1.0	25	B
5674.438	7 No 8	0.385	74AH	0.3	0.14	8.3	211	0.3	9	1.0	25	B
5674.484	7 No 7	0.433	74AH	0.3	0.12	8.3	211	0.3	8	1.0	25	B
5675.547	7 No 6	0.486	75AH	0.5	0.23	9.5	241	0.5	13	1.0	25	B
5675.609	7 No 5	0.546	75AH	0.5	0.20	9.8	248	0.5	12	1.0	25	B
5676.656	19 No 9	0.572	76AH	0.8	0.38	10.4	265	0.6	15	1.3	32	B
STEEL GROUND WIRE												
5673.357	5/16	0.312	73AH	0.1	0.06	7.4	189	0.2	5	1.0	25	B
5673.391	3/8	0.360	73AH	0.1	0.06	7.6	194	0.2	5	1.0	25	B
5675.547	7/16	0.435	75AH	0.5	0.23	9.5	241	0.5	13	1.0	25	B
5675.547	1/2	0.495	75AH	0.5	0.23	9.5	241	0.5	13	1.0	25	B

Notes:

1. Pad Dimensions are on page 117.
2. AFL Filler Compound (AFC) Requirements are on page 115.
3. Installation Instructions for Terminals are on page 131.
4. Bolts, nuts and washers are not supplied with the straight terminal connector.

Terminal Connectors—5100 Series for Alumoweld® and Steel Ground Wire, 15°

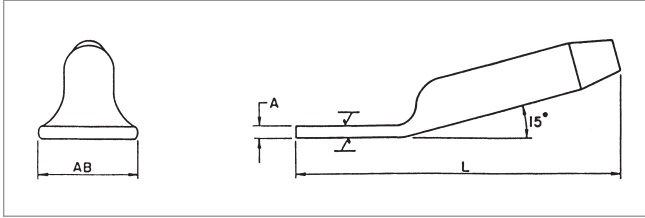

Ordering Instructions

Step 1: Assembly Catalog Number

Determine the assembly catalog number based on the conductor being used.

Example:

For 7 No. 7 Alumoweld, the complete catalog number is:

5174.484

The 5100 Series Straight Terminal Connector is designed for Alumoweld and steel ground wire. The terminal connector is fabricated from AFL seamless drawn aluminum.

When used with the dead end, the 15° terminal connector can be bolted in either the straight or 30° position. All terminal connectors are designed for limited tension use, maintaining a minimum of 40% of the ASTM rated strength of the conductor on which it is being used. Aluminum hardware is supplied with the 15° terminal connector.

TERMINAL CONNECTOR CATALOG NUMBER	CONDUCTOR		DIE SIZE	TOTAL WEIGHT		DIMENSION						PAD SIZE
	SIZE	DIA.	ALUMINUM HEX DIE			L		A		AB		
		IN		LBS	KG	IN	MM	IN	MM	IN	MM	
ALUMOWELD												
5172.281	3 No 10	0.220	72AH	0.3	0.12	7.4	189	0.2	5	1.0	25	B
5172.281	3 No 9	0.247	72AH	0.3	0.12	7.4	189	0.2	5	1.0	25	B
5106.312	3 No 8	0.277	06AH	0.3	0.15	7.2	183	0.1	3	1.0	25	B
5109.344	3 No 7	0.311	09AH	0.3	0.15	7.8	197	0.3	7	1.0	25	B
5109.375	3 No 6	0.349	09AH	0.3	0.15	7.8	198	0.3	6	1.0	25	B
5174.438	3 No 5	0.392	74AH	0.4	0.20	8.3	211	0.3	9	1.0	25	B
5106.344	7 No 10	0.306	06AH	0.3	0.15	7.3	185	0.1	3	1.0	25	B
5173.391	7 No 9	0.343	73AH	0.3	0.12	7.6	194	0.2	5	1.0	25	B
5174.438	7 No 8	0.385	74AH	0.4	0.20	8.3	211	0.3	9	1.0	25	B
5174.484	7 No 7	0.433	74AH	0.4	0.19	8.3	211	0.3	8	1.0	25	B
5175.547	7 No 6	0.486	75AH	0.7	0.29	9.5	241	0.5	13	1.0	25	B
5175.609	7 No 5	0.546	75AH	0.6	0.27	9.8	248	0.5	12	1.0	25	B
5176.656	19 No 9	0.572	76AH	0.9	0.42	10.4	265	0.6	15	1.3	32	B
STEEL GROUND WIRE												
5173.357	5/16	0.312	73AH	0.3	0.13	7.4	189	0.2	5	1.0	25	B
5173.391	3/8	0.360	73AH	0.3	0.12	7.6	194	0.2	5	1.0	25	B
5175.547	7/16	0.435	75AH	0.7	0.29	9.5	241	0.5	13	1.0	25	B
5175.547	1/2	0.495	75AH	0.7	0.29	9.5	241	0.5	13	1.0	25	B

Notes:

1. Pad Dimensions are on page 117.
2. AFL Filler Compound (AFC) Requirements are on page 115.
3. Installation Instructions for Terminals are on page 131.
4. Supplied with aluminum hardware.

Terminal Connectors—5800 Series for Alumoweld® and Steel Ground Wire, 90°

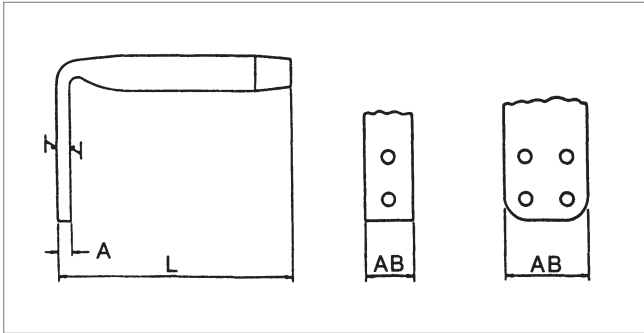

The 5800 Series Terminal Connector is designed for Alumoweld and steel ground wire. The terminal connector is fabricated from AFL seamless drawn aluminum.

All terminal connectors are designed for limited tension use, developing a minimum of 40% of the ASTM rated breaking strength of the cable being used.

Ordering Instructions

Step 1: Assembly Catalog Number

Determine the assembly catalog number based on the conductor being used.

Example:

For 7 No. 7 Alumoweld, the complete catalog number is:

5874.484

TERMINAL CONNECTOR CATALOG NUMBER	CONDUCTOR		DIE SIZE	TOTAL WEIGHT		DIMENSION						PAD SIZE
	SIZE	DIA. IN	ALUMINUM HEX DIE	LBS	KG	L		A		AB		
						IN	MM	IN	MM	IN	MM	
ALUMOWELD												
5872.281	3 No 10	0.220	72AH	0.14	0.06	3.8	95	0.19	5	1.0	25	B
5872.281	3 No 9	0.247	72AH	0.14	0.06	3.8	95	0.19	5	1.0	25	B
5806.312	3 No 8	0.277	06AH	0.20	0.09	3.4	86	0.12	3	1.0	25	B
5809.344	3 No 7	0.311	09AH	0.22	0.10	4.4	111	0.28	7	1.0	25	B
5809.375	3 No 6	0.349	09AH	0.21	0.10	4.4	111	0.25	6	1.0	25	B
5873.438	3 No 5	0.392	74AH	0.32	0.15	4.9	124	0.34	9	1.0	25	B
5874.438	3 No 5		74AH	0.32	0.15	4.9	124	0.34	9	1.0	25	B
5806.344	7 No 10	0.306	06AH	0.19	0.09	3.5	89	0.12	3	1.0	25	B
5873.391	7 No 9	0.343	73AH	0.14	0.06	4.0	101	0.19	5	1.0	25	B
5873.438	7 No 8	0.385	74AH	0.32	0.15	4.9	124	0.34	9	1.0	25	B
5874.438	7 No 8		74AH	0.32	0.15	4.9	124	0.34	9	1.0	25	B
5874.484	7 No 7	0.433	74AH	0.29	0.13	4.9	124	0.31	8	1.0	25	B
5875.547	7 No 6	0.486	75AH	0.54	0.24	6.0	152	0.50	13	1.0	25	B
5875.609	7 No 5	0.546	75AH	0.49	0.22	6.3	159	0.47	12	1.0	25	B
5875.547	19 No 10		75AH	0.54	0.24	6.0	152	0.50	13	1.0	25	B
5876.656	19 No 9	0.572	76AH	0.83	0.38	7.1	181	0.59	15	1.3	32	B
STEEL GROUND WIRE												
5873.357	5/16	0.312	73AH	0.15	0.07	3.9	99	0.19	5	1.0	25	B
5873.391	3/8	0.360	73AH	0.14	0.06	4.0	101	0.19	5	1.0	25	B
5875.547	7/16	0.435	75AH	0.54	0.24	6.0	152	0.50	13	1.0	25	B
5875.547	1/2	0.495	75AH	0.54	0.24	6.0	152	0.50	13	1.0	25	B

Notes:

1. Pad Dimensions are on page 117.
2. AFL Filler Compound (AFC) Requirements are on page 115.
3. Installation Instructions for Terminals are on page 131.
4. Bolts, nuts and washers are not supplied with the 90° terminal connector.