

DOSSERT®

TYPE EB Everdur Bolts

Dossert Everdur Machine bolts are cold headed and roll threaded. They exhibit tensile strengths equal to or greater than mild steels. Their high resistance to corrosion and non-magnetic properties make them extremely useful in electrical work.

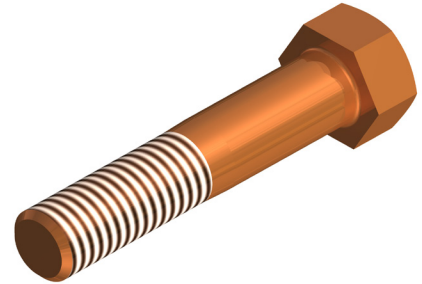

Bronze Grounding Connectors and Everdur Hardware

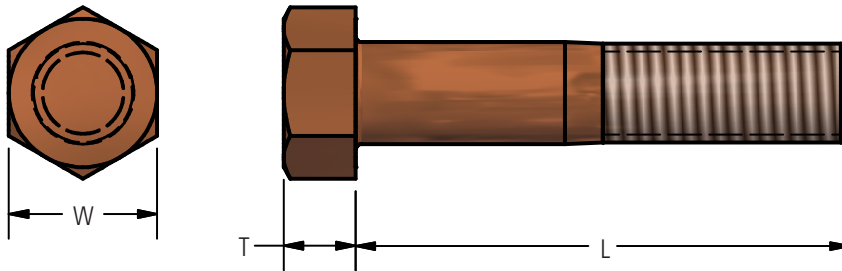

Ordering Information

BOLT DIAMETER AND THREADS PER INCH						
L IN INCHES	1/4 - 20	5/16 - 18	3/8 - 16	1/2 - 13	5/8 - 11	3/4 - 10
1/2	EB2550	EB3150	EB3750	EB5050	—	—
5/8	EB2562	EB3162	EB3762	EB5062	—	—
3/4	EB2575	EB3175	EB3775	EB5075	—	—
7/8	EB2587	EB3187	EB3787	EB5087	—	—
1	EB25100	EB31100	EB37100	EB50100	EB62100	—
1 1/4	EB25125	EB31125	EB37125	EB50125	EB62125	EB75125
1 1/2	EB25150	EB31150	EB37150	EB50150	EB62150	EB75150
1 3/4	EB25175	EB31175	EB37175	EB50175	EB62175	EB75175
2	EB25200	EB31200	EB37200	EB50200	EB62200	EB75200
2 1/4	EB25225	EB31225	EB37225	EB50225	EB62225	EB75225
2 1/2	EB25250	EB31250	EB37250	EB50250	EB62250	EB75250
2 3/4	EB25275	EB31275	EB37275	EB50275	EB62275	EB75275
3	EB25300	EB31300	EB37300	EB50300	EB62300	EB75300
3 1/4	EB25325	EB31325	EB37325	EB50325	EB62325	EB75325
3 1/2	EB25350	EB31350	EB37350	EB50350	EB62350	EB75350
4	EB25400	EB31400	EB37400	EB50400	EB62400	EB75400
4 1/2	—	EB31450	EB37450	EB50450	EB62450	EB75450
5	—	—	EB37500	EB50500	EB62500	EB75500
5 1/2	—	—	EB37550	EB50550	EB62550	EB75550
6	—	—	EB37600	EB50600	EB62600	EB75600
W	3/8	1/2	9/16	3/4	15/16	1 1/8
T	5/32	3/16	15/64	19/64	25/64	15/32

DOSSERT®

TYPE EN, EW, ELW, EILW Everdur Nuts, Spring Washer, and Flat Washer

Dossert Everdur nuts, EN, are made to the American Standard National course thread Class 2 Semifinished, cold punched. Dossert Everdur spring type lockwasher, ELW, is a tough and durable unit which prevents the loosening of the nut under severe conditions of vibration. Dossert Everdur flat washers, EW, are stamped from cold drawn Everdur sheet and are tumbled to a smooth finish with rounded edges. Dossert Everdur internal lock washer EILW.

Material

Everdur

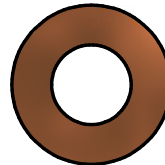
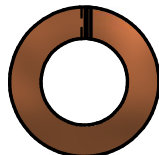

EN

EILW

ELW

EW

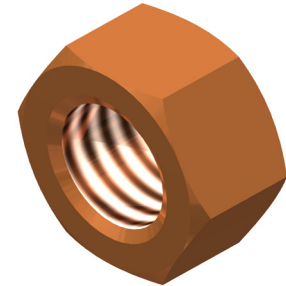

EN

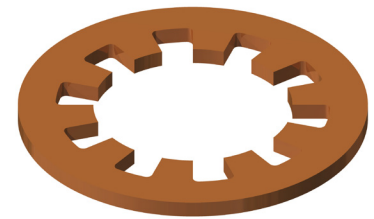

EILW

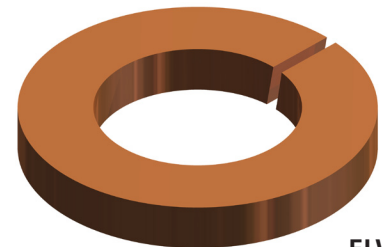

ELW

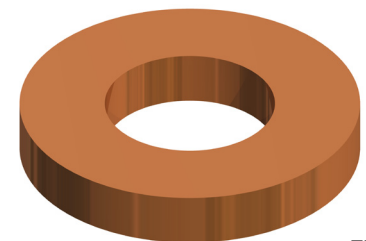

EW

Ordering Information

TYPE EN				
CATALOG NUMBER	DIAMETER OF THREADS	THREADS PER INCH	WIDTH ACROSS FLATS	THICKNESS
EN25	1/2	20	7/6	13/64
EN31	5/16	18	9/16	1/4
EN37	3/8	16	5/8	5/16
EN50	1/2	13	13/16	27/64
EN62	5/8	11	1	17/32
EILW75	3/4	.102	1 7/8	

TYPE EILW			
CATALOG NUMBER	BOLT SIZE	THICKNESS	MAJOR DIAMETER
EILW25	1/4	.040	11/16
EILW31	5/16	.064	7/8
EILW37	3/8	.064	1
EILW50	1/2	.091	1 1/4
EILW62	5/8	.091	1 1/2
EILW75	3/4	.102	1 7/8

TYPE ELW		TYPE EW		
CATALOG NUMBER	BOLT SIZE	CATALOG NUMBER	BOLT SIZE	THICKNESS
ELW25	1/4	EW25	1/4	1/16
ELW31	5/16	EW31	5/16	1/16
ELW37	3/8	EW37	3/8	3/32
ELW50	1/2	EW50	1/2	1/8
ELW62	5/8	EW62	5/8	5/32
ELW75	3/4	EW75	3/4	3/16