

DOSSERT® Type NRLA-1 Insulating Sleeve for Types NRLA-P, NRLA-R, and NRLA-PL Limiter Link Assemblies

A MYPAR molded insulating sleeve for use with limiter link assemblies. This two section unit is provided with interlocking ends to form a smooth junction. Its use simplifies taping and improves the accessibility to the enclosed limiter.

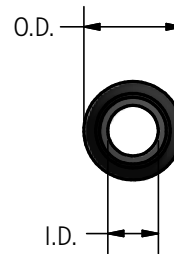
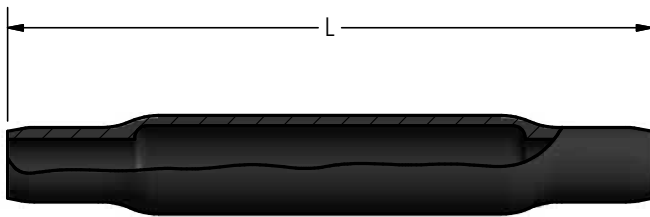

Ordering Information

CATALOG NUMBER	CABLE RANGE	DIAMETER OVER CABLE INSULATION (I.D.)	DIMENSIONS IN INCHES	
			L	O.D.
NRLA25-1	4/0 STR - 250 MCM	Diameter over cable insulation to be specified on order.	12 7/8	2
NRLA40-1	300 MCM - 400 MCM		13 5/8	2 1/4
NRLA50-1	500 MCM		16	2 7/16
NRLA75-1	750 MCM		16 1/4	2 5/8