

SkyWrap® In-line Bypass—Phase Wire

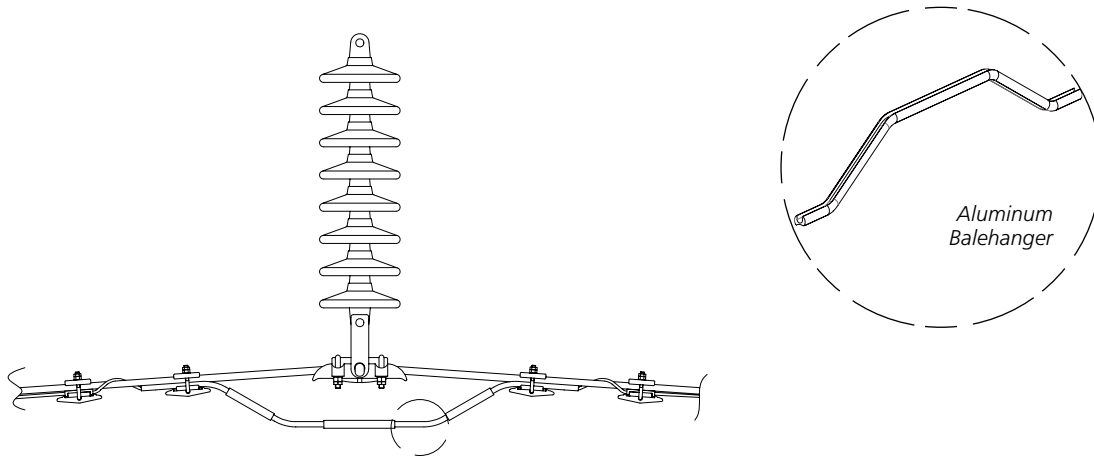

SkyWrap cable is passed around the tower top conductor fittings using a specially designed bypass accessory known as a 'balehanger'. The aluminum balehanger is clamped to the conductor either side of the conductor fittings and the SkyWrap cable is secured within a channel holding it in position away from the conductor fittings.

Features

- Shaped aluminum provides secure passage of the SkyWrap cable around the conductor fittings
- Aluminum balehangers are held at the same electric potential as the conductor
- Balehangers can be applied to any conductor suspension fitting arrangement and design
- Also designed for post and cantilever insulators
- Meets IEEE standard 1591.3-2011

Key components

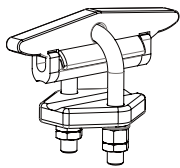

Cable clamp with nylon insert

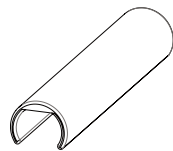

Cable balehanger cover

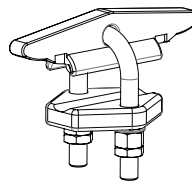

Cable clamp

Ordering Information

	STRUCTURE TYPE	CONDUCTOR SIZE INCHES (MM)		
	Any In-line structure	0.354-0.866 (9-22)	0.787-1.221 (20-31)	1.181-1.693 (30-43)
TCD	926	A	B	C

Example: TCD-926B