

TYPE CXSWHV-AA Swage EHV End Cap—Ball

A Swage type end cap ball for high voltage.

Material

Aluminum Alloy

Notes

- Bore will be lined with AFL Filler compound (AFC) and capped.
- 5" and 6" S.P.S. parts require double swages.

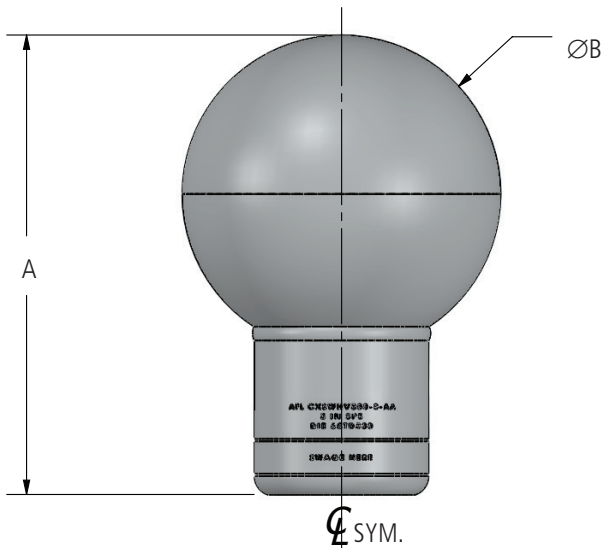

Ordering Information

AFL NO.	S.P.S.	DIMENSIONS IN INCHES		DIE SIZE
		A	B	
CXSWHV300-8-AA	3	11.58	8.00	65TD300
CXSWHV300-13-AA	3	16.75	13.00	65TD300
CXSWHV350-8-AA	3.5	11.94	8.00	65TD350
CXSWHV350-13-AA	3.5	17.17	13.00	65TD350
CXSWHV400-8-AA	4	11.78	8.00	65TD400
CXSWHV400-13-AA	4	17.09	13.00	65TD400
CXSWHV500-8-AA	5	12.28	8.00	85TD500
CXSWHV500-13-AA	5	17.84	13.00	85TD500
CXSWHV600-13-AA	6	20.68	13.00	115TD600