

TYPE SWCC-AA Swage Cable Coupler

A swage type cable coupler designed to connect two aluminum cables.

Material

Aluminum Alloy

Note

- Prefilled with AFL Filler Compound (AFC) and capped.

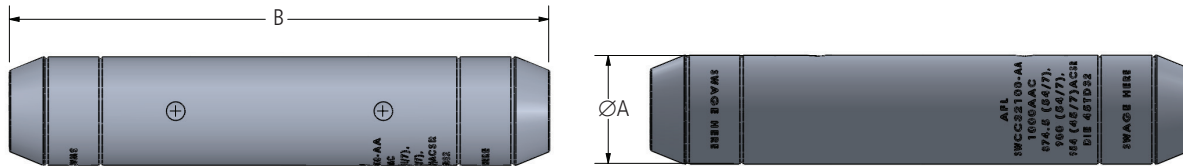

Ordering Information

AFL NO.	CABLE RANGE		DIMENSIONS (INCHES)		DIE SIZE	VOLTAGE RATING (kV)
	AAC	ACSR	A	B		
SWCC1613-AA	2/0	1/0 (6/1)	1.00	9.00	45TD16	345
SWCC1617-AA	3/0	2/0 (6/1)	1.00	9.00	45TD16	345
SWCC1621-AA	4/0	3/0 (6/1)	1.00	9.00	45TD16	345
SWCC1625-AA	250	4/0 (6/1)	1.00	9.00	45TD16	345
SWCC2026-AA	266.8	266.8 (18/1)	1.25	9.00	45TD20	345
SWCC2030-AA	300	266.8 (26/7)	1.25	9.00	45TD20	345
SWCC2035-AA	336.4, 350	300 (26/7), 336.4 (18/1)	1.25	9.00	45TD20	345
SWCC2039-AA	397.5	336.4 (26/7), 336.4 (30/7), 397.5 (18/1)	1.25	9.00	45TD20	345
SWCC2445-AA	450	397.5 (24/7), 397.5 (26/7)	1.50	9.13	45TD24	345
SWCC2447-AA	477	397.5 (30/7)	1.50	9.13	45TD24	345
SWCC2450-AA	500	477 (18/1)	1.50	9.13	45TD24	345
SWCC2455-AA	556.5	477 (24/7), 477 (26/7)	1.50	9.13	45TD24	345
SWCC2860-AA	600	477 (30/7), 556.5 (18/1)	1.75	10.00	45TD28	345
SWCC2863-AA	636	556.5 (24/7), 556.5 (26/7)	1.75	10.00	45TD28	345
SWCC2871-AA	700, 715.5	556.5 (30/7), 605 (24/7), 605 (26/7), 636 (18/1), 636 (36/1)	1.75	10.00	45TD28	345
SWCC3075-AA	750	605 (30/7), 605 (30/19), 636 (24/7), 636 (26/7)	1.88	10.00	45TD30	345
SWCC3079-AA	795	636 (30/7), 636 (30/19), 715.5 (24/7), 715.5 (54/7), 795 (36/1)	1.88	10.00	45TD30	345
SWCC3087-AA	874.5	715.5 (26/7), 715.5 (30/19), 795 (45/7)	1.88	10.00	45TD30	345
SWCC3290-AA	900	795 (24/7), 795 (54/7), 795 (26/7)	2.00	10.00	45TD32	345
SWCC3295-AA	954	795 (30/19), 900 (45/7)	2.00	10.00	45TD32	345
SWCC32100-AA	1000	874.5 (54/7), 900 (54/7), 954 (45/7)	2.00	10.00	45TD32	345
SWCC32103-AA	1033.5	954 (54/7)	2.00	10.00	45TD32	345
SWCC32111-AA	1113	1033.5 (45/7), 1033.5 (54/7)	2.00	10.00	45TD32	345
SWCC36119-AA	1192.5	1113 (45/7)	2.25	10.50	45TD36	500
SWCC36127-AA	1272	1113 (54/19), 1192.5 (45/7)	2.25	10.50	45TD36	500
SWCC36135-AA	1351.5	1192.5 (54/19), 1272 (45/7)	2.25	10.50	45TD36	500
SWCC36143-AA	1431	1272 (54/19), 1351.5 (45/7)	2.25	10.50	45TD36	500
SWCC36151-AA	1510.5	1351.5 (54/19), 1431 (45/7)	2.25	10.50	45TD36	500
SWCC36159-AA	1590	1431 (54/19), 1510.5 (45/7)	2.25	10.50	45TD36	500
SWCC36175-AA	1750	1510.5 (54/19), 1590 (45/7)	2.25	10.50	45TD36	500
SWCC36180-AA	1800	1590 (54/19)	2.25	10.50	45TD36	500
SWCC44200-AA	2000	1780 (84/19)	2.75	11.50	65TD44	500
SWCC44230-AA	2250	2156 (84/19), 2167 (72/7)	2.75	11.50	65TD44	500
SWCC44250-AA	2500	2312 (76/19)	2.75	11.50	65TD44	500